

AGENDA MEMORANDUM

DATE: April 3, 1984

TO: Board of County Commissioners

FROM: County Administrator

BY: Originating Department PUBLIC TRANSPORTATION DEPARTMENT

SUBJECT: AGENDA ITEM - REGULAR X CONSENT _____ REQUESTED AGENDA DATE 4-17-84

RE: Tandem Trailer Combinations (Double Bottoms)
Whitfield Industrial Park area.

County Attorney
/s/ KFR
APPROVED AS TO FORM

ORIGINAL DOCUMENT

ACTION REQUIRED:

Adoption of Resolution No. R84-52 establishing Tandem Trailer Truck Routes in Manatee County.

COUNTY

APR 4 1984

ADMINISTRATOR

ACTION(S) REQUIRED: Execution Acceptance Approval Recording Authorization Adoption

COST:
SOURCE:

ATTACHMENTS:

BOARD RECORDS:

Legend - Roadway Express, Inc. Terminal
Resolution No. R-84-52
March 8, 1984 Ltr. to Mr. Jas Deets

Mar 14 Letter to Roadway Express, A.C. Jenkins
Mar 16 From Consolidated Freightways
Mar 23 From Roadway Express
Mar 30 Memo to Robt Fernandez

AGENDA DISPOSITION

ACTION TAKEN BY THE BOARD:

- APPROVED DEFERRED UNTIL _____ RECEIVED
- DISAPPROVED CONCURRED WITH STAFF RECOMMENDATION REFERRED TO STAFF

OTHER: _____

SPECIAL INSTRUCTIONS: _____

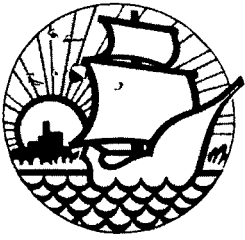

MANATEE COUNTY GOVERNMENT

Engineering Division

March 30, 1984

MEMORANDUM

TO: Mr. Robert Fernandez, County Administrator

FROM: Philip A. Davis, Director, Public Transportation Dept.

SUBJECT: Tandem Trailer Combinations - Whitfield Industrial Park Area

This department has had several requests recently to establish a tandem trailer truck route as explained in State Rule 14-54,016. Such a route was approved by the county for Ryder Trucking, Inc. and we are now in receipt of two additional locations by Roadway Express, Inc. and Consolidated Freightways. To eliminate a continual piecemeal approval of such requests, it seems appropriate to recommend a plan for at least the Whitfield Industrial area, at this time, which hopefully will satisfy the needs for the immediate future. As the new 301 is constructed the plan could be easily expanded to the needs of such locations as Miller Trailers and Tropicana Products. The proposed route, at this time, is as follows, and is also shown on the enclosed plat:

S.R. I-75 interchange at S.R. 70
West on S.R. 70 to new 301
South on new 301 to University Parkway
East University Parkway to I-75, including
a loop from new 301 at 63rd Avenue East,
easterly to 33rd Street East, South to
69th Avenue East, west return to new 301,
including the already approved route on
69th Avenue East to old S.R. 301 to
Ryder's terminal.

Included herewith are the requests from the trucking firms as well as previously furnished information and the rules that apply.

Based on this staff's review, it is recommended this route be approved for tandem trailer access to the Whitfield Industrial Park area as stated.

HSE/ef

Encl. .

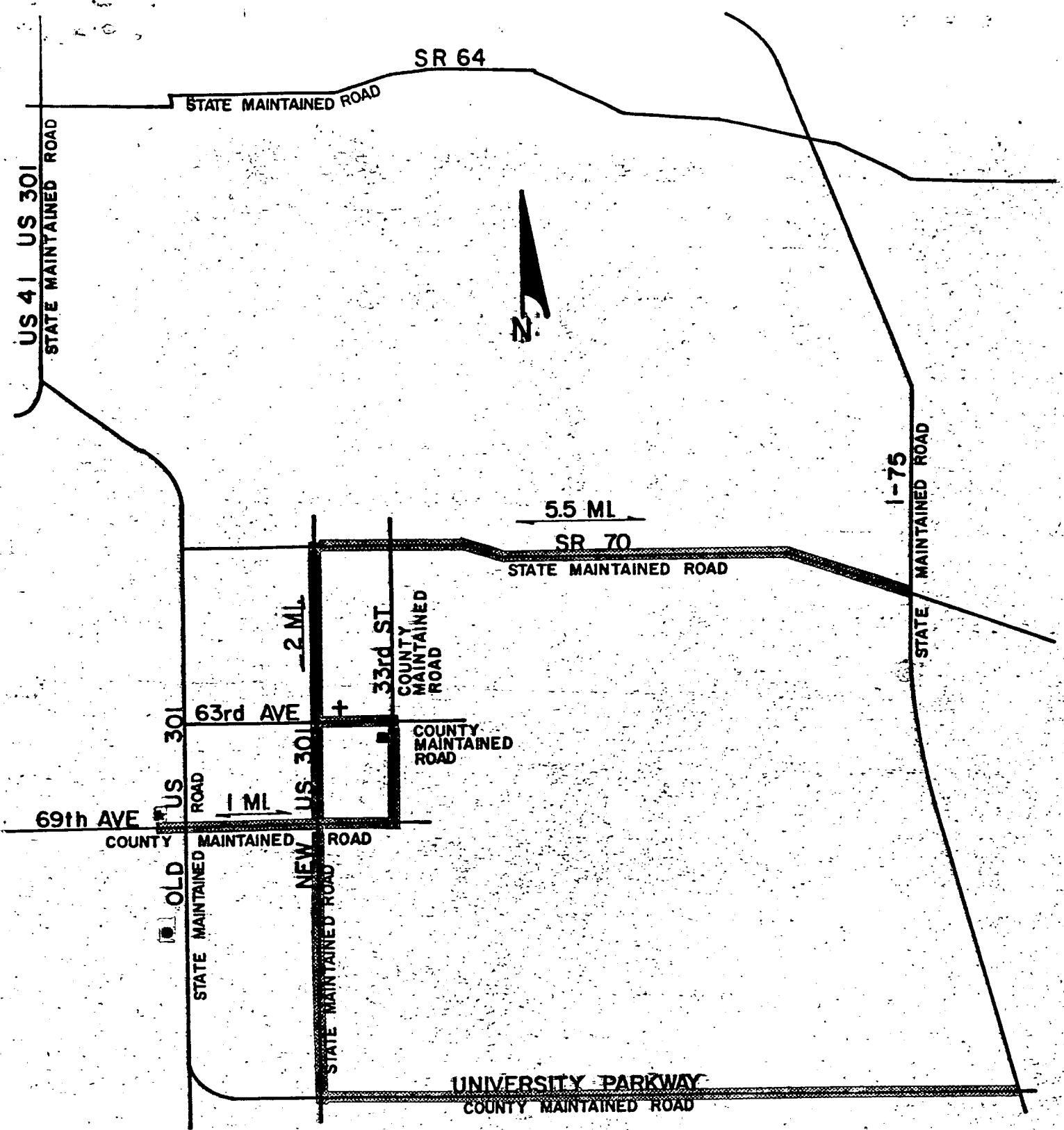

LEGEND

- ROADWAY EXPRESS INC. TERMINAL
- YELLOW FREIGHT SYSTEM TERMINAL
- ⊠ RIDER /P.I.E. TERMINAL
- + CONSOLIDATED FREIGHTWAYS

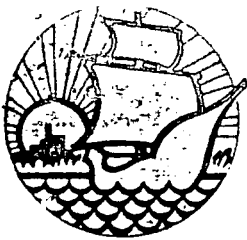

MANATEE COUNTY GOVERNMENT

Engineering Division

March 8, 1984

Savanna

Mr. James T. Deets,
Southern Area Personnel & Safety Manager
Consolidated Freightways
P. O. Box 105081
Atlanta, Georgia 30348

Dear Mr. Deets:

We are in receipt of correspondence from the Florida Department of Transportation requesting consideration of a tandem trailer route within Manatee County based on your letter of December 20, 1983. The proposal states traveling over 33rd Street East through a residential neighborhood. We are not in a position to recommend such a route for several reasons. Manatee County recently adopted a route from I-75 along S. R. 70 to new U. S. 301 South to 69th Avenue or Whitfield Avenue. We have attached a copy of this approved route for your information. As we do not want truck traffic routed through a residential neighborhood and based on the above approved route, we would entertain a more logical approach to your situation. That would be to follow the approved route to 63rd Avenue, then go East approximately one block to your facility at 31st Street East. This would be a minor change or addition to the existing route.

After your review and consideration of this proposal, it is requested you petition this office for presentation to the Board of County Commissioners for consideration. We will await your response and if additional data or information is needed, do not hesitate to call.

Sincerely,

Philip A. Davis
Director

JK HSE/ef

cc: Mr. Dennis L. Wood, P.E., F.D.O.T., Bartow, FL
Mr. Larry K. Frazier, Director, Planning Dept.
Central Files

FREE DOCUMENT
SERIALS

Engineering Division

March 14, 1984

Roadway Express, Inc.
Attn: A. C. Jenkins, Relay Manager
Bellville & KOA Camp Rds.
Lake Park, GA 31636

Dear Mr. Jenkins:

We are in receipt of correspondence from the Florida Department of Transportation requesting consideration of a tandem trailer route within Manatee County based on your letter of February 23, 1984. The proposal states traveling over 33rd Street East through a residential neighborhood. We are not in a position to recommend such a route for several reasons. Manatee County recently adopted a route from I-75 along S.R. 70 to new U.S. 301 South to 69th Avenue or Whitfield Avenue. We have attached a copy of this approved route for your information. As we do not want truck traffic routed through a residential neighborhood and based on the above approved route, we would entertain a more logical approach to your situation. That would be to follow the approved route to 63rd Avenue, then go East to 33rd St. and to your property. This would be a minor change or addition to the existing route.

After your review and consideration of this proposal, it is requested you petition this office for presentation to the Board of County Commissioners for consideration. We will await your response, and if additional data or information is needed, do not hesitate to call.

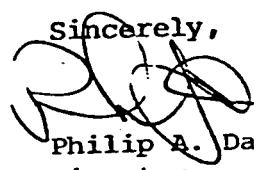
Sincerely,

Philip A. Davis
Director

HSE/ef

cc: Mr. Dennis L. Wood, P.E., F.D.O.T., Bartow
Mr. Larry K. Frazier, Director, Planning Dept.
Central Files ←

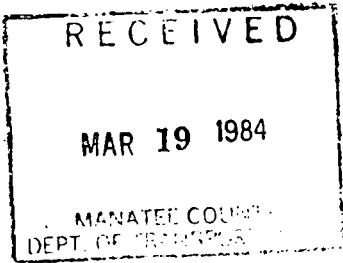

SOUTHERN AREA HEADQUARTERS



March 16, 1984

Mr. Philip A. Davis, Director
 Department of Transportation
 P. O. Box 1000
 Bradenton, FL 33506

Dear Mr. Davis:

Please accept this as our letter of petition to run tandem trailers within Manatee County traveling from the approved route of I-75 along S.R. 70 to new U.S. 301 South to 69th Avenue, then to 63rd Avenue going east to our facility at 31st Street East.

Thank you for this consideration and we are awaiting your response soon.

Sincerely,

CONSOLIDATED FREIGHTWAYS

James T. Deets
 Personnel & Safety Manager
 Southern Area

jpn

CC: Dennis L. Wood, PE
 Larry K. Frazier
 Joseph Hoey, CF Atlanta
 Ron Gray, CF Bradenton

FILE	ROUTE	ACTION	REPLY	CONFER	CLEAR	FILE
DIRECTOR						
ASST. DIR.						
ASST. CO. ENG.						
DESIGN						
CONSTR.						
TRANSIT/M.P.						
TRAFFIC						
LANDFILL						

	ROUTE	ACTION	REPLY	CONFER	FILE
DIRECTOR	1				
ASST. DIR.					
CO. ENG.	2				
ADMIN.					
PLANNING					
R/W					
TRANSIT/M.P.					
TRAFFIC					
LANDFILL					



ROADWAY EXPRESS, INC.

WELLVILLE & KOA CAMP RDS.
LAKE PARK, GA 31636
912-559-5171

March 23, 1984

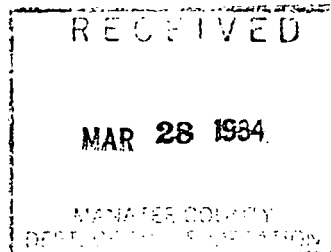

Mr. Philip A. Davis, Director
Department of Transportation
Manatee County Government
226 6th Avenue East
Bradenton, Florida 33506

Dear Mr. Davis:

Thank you for your prompt response to our petition for an access route to our terminal in Manatee County. We do accept your proposed alternate route (following the approved route to 63rd Avenue, then going East to 33rd Street to our terminal).

Please consider this letter as our application to your office for such for approval of such route by the Board of County Commissioners. I would also appreciate you advising us as soon as this item is placed on the agenda so that we may arrange for a representative to attend the meeting.

Your cooperation is most appreciated.

Very truly yours,

A. C. Jenkins
Relay Manager

ACJ/mcb

FILE	ROUTE	ALLOCATION	APPLY	REPAIR	MAINT	PAVE
DIPECTOR						
ASST. DIR.						
ASST. CO. ENG.						
DESIGN						
CONSTR.						

b

	ROUTE	ALLOCATION	APPLY	REPAIR	MAINT	PAVE
1						
2						



DEDICATED TO BETTER SERVICE