



MANATEE COUNTY GOVERNMENT AGENDA MEMORANDUM

| | | | |
|--|-------------------------------------|-------------------------------------|---|
| SUBJECT | Adoption of Traffic Ordinance 98-30 | TYPE AGENDA ITEM | Public Hearing |
| DATE REQUESTED | July 7, 1998 | DATE SUBMITTED/REVISED | June 26, 1998 |
| BRIEFINGS?/WHO? | None | CONSEQUENCES IF DEFERRED | Advertised Public Hearing |
| DEPARTMENT/DIVISION | Transportation/ Administration | AUTHORIZED BY TITLE | Larry R. Mau, P.E.  Transportation Director |
| CONTACT PERSON TELEPHONE/EXTENSION | Harry K. Mendenhall, P.E. 5036 | PRESENTER/TITLE TELEPHONE/EXTENSION | Harry K. Mendenhall, Asst. Director 5036  |
| ADMINISTRATIVE APPROVAL  | | | |

ACTION DESIRED

INDICATE WHETHER "REPORT or "DISCUSSION, "FORM OF MOTION, or "OTHER ACTION REQUIRED:

ADOPTION OF MANATEE COUNTY ORDINANCE 98 - 30, AMENDING ORDINANCE 98-11; REGULATING THE STOPPING, STANDING, OR PARKING OF MOTOR VEHICLES ON 17TH STREET COURT EAST, 18TH STREET EAST, 34TH AVENUE EAST, 35TH STREET WEST, 36TH STREET WEST, SHEPHERD STREET, AND HOLLY AVENUE; ALL BEING COUNTY MAINTAINED STREETS LOCATED WITHIN THE UNINCORPORATED AREA OF MANATEE COUNTY, FLORIDA; PROVIDING DEFINITIONS; REQUIRING ERECTION OF APPROPRIATE SIGNS; PROVIDING FOR PENALTIES; AND PROVIDING AN EFFECTIVE DATE.

ENABLING/REGULATING AUTHORITY

Federal/State law(s), administrative ruling(s), Manatee County Comp Plan/Land Development Code, ordinances, resolutions, policy.)

FLORIDA STATUTES, CHAPTER 316 008 - POWERS OF LOCAL AUTHORITIES

BACKGROUND/DISCUSSION

SEE ATTACHED PAGE

HAS COUNTY ATTORNEY REVIEW BEEN REQUESTED? Indicate "NO" or "YES" @ right. (if "NO," proceed to 1) below; and if "YES," proceed to 2) below) NO

1) IF "NO" TO ABOVE.

A) PLEASE EXPLAIN BELOW: (see also following section 1B) re: contract, agreement, lease, etc.:
AMENDMENT TO EXISTING MASTER ORDINANCE PREPARED BY THE COUNTY ATTORNEY'S OFFICE

B) IF A CONTRACT, AGREEMENT, LEASE OR OTHER DOCUMENT WAS PREVIOUSLY APPROVED, STATE YEAR OF LAST USE @ RIGHT:

2) IF "YES" TO FIRST QUESTION IN THIS SECTION.

A) HAS ENTIRE MATTER, OR ONLY A PORTION, BEEN REVIEWED? IF ONLY A PORTION, WHICH PORTION?
N/A

B) HAVE ALL COMMENTS/SUGGESTIONS RAISED BY COUNTY ATTORNEY BEEN ADDRESSED/INCORPORATED; IF NOT, PLEASE EXPLAIN. A COPY OF FINAL COUNTY ATTORNEY MEMO RE THIS MATTER **MUST BE ATTACHED** (if comments were verbal, so indicate.)

APPROVED IN OPEN SESSION

JUL 7 1998

BOARD OF COUNTY COMMISSIONERS
MANATEE COUNTY, FLORIDA

| | |
|--|--|
| ATTACHMENTS: (List in order as attached) 1. ORDINANCE 98 - 30 2. DOCUMENTATION FOR ORD 98-30 3. PROOF OF PUBLICATION 4. LOCATION MAPS | INSTRUCTIONS TO BOARD RECORDS: Return one certified copy of this ordinance to Wendy Allen, Transportation Department |
| COST \$ 950 - INSTALL NEW SIGNS & POSTS | SOURCE (ACCT# & NAME) 101-0011700 - TRF - JC MGMT |
| COMMENTS N/A | AMT./FREQ. OF RECURRING COSTS (ATTACH FISCAL IMPACT STATEMENT) \$ 150/YEAR - REPAIRS AND REPLACEMENT |

BACKGROUND/DISCUSSION

- ▶ APRIL 21, 1998 - THE BOARD OF COUNTY COMMISSIONERS ADOPTED ORDINANCE 98-11, PROHIBITING STOPPING, STANDING, OR PARKING AT ALL TIMES ON SHEPHERD STREET AND HOLLY AVENUE, BASED UPON A PETITION RECEIVED FROM AN AREA RESIDENT. OTHER AREA RESIDENTS HAVE SINCE COMPLAINED THAT THE PETITION WAS NOT VALID, AND DID NOT REFLECT THEIR TRUE WISHES.
- ▶ MAY 5, 1998 - THE COMMISSIONER OF THE DISTRICT, UNDER COMMISSIONER'S COMMENTS, REQUESTED A RECONSIDERATION OF THE RESTRICTIONS IMPOSED ON HOLLY AVENUE AND SHEPHERD STREET BY ORDINANCE 98-11. STAFF WAS DIRECTED TO RETURN WITH THE NECESSARY MODIFICATIONS TO THE ORDINANCE. THIS WILL BE DONE BY ADOPTION OF ORDINANCE 98-30.
- ▶ JUNE 26, 1998 - STAFF HAS RECEIVED THE ATTACHED PETITIONS AND LETTERS IN SUPPORT OF THE PARKING RESTRICTIONS PROPOSED BY ORDINANCE 98 - 30
- ▶ JUNE 26, 1998 - STAFF RECOMMENDS FAVORABLE ACTION

LOCATION MAP

**NO STOPPING STANDING OR PARKING
AT ANY TIME**

17th St. Ct. E. From 34th Ave. E. to 36th Ave. E.

*Manatee
Historical
Village*

**KINGSTON
ESTATES**

**KINGSTON
GROVES**

SITE →

Samoset

TANGELI PARK

**HEATHER
HILLS**

**CHATEAU
VILLAGE**

Oneco

NORTH

Continued on Page 21

Continued on Page 23

LOCATION MAP

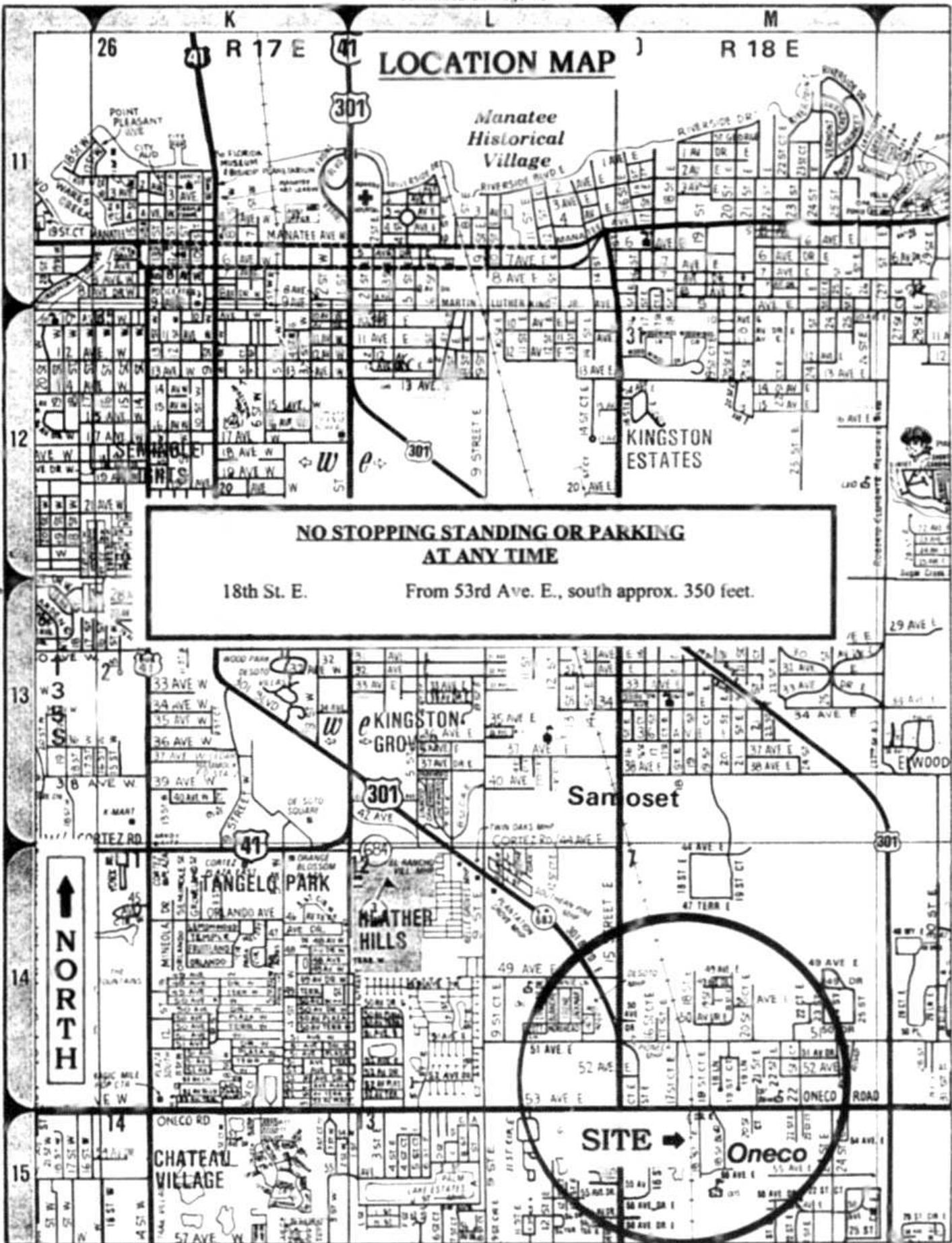

**NO STOPPING STANDING OR PARKING
AT ANY TIME**

18th St. E. From 53rd Ave. E., south approx. 350 feet.

Continued on Page 21

Continued on Page 23

LOCATION MAP

*Manatee
Historical
Village*

**NO STOPPING STANDING OR PARKING
AT ANY TIME**

34th Ave. E.

From 15th St. E., west to the railroad tracks.

SITE →

Samoset

NORTH

Continued on Page 21

Continued on Page 23

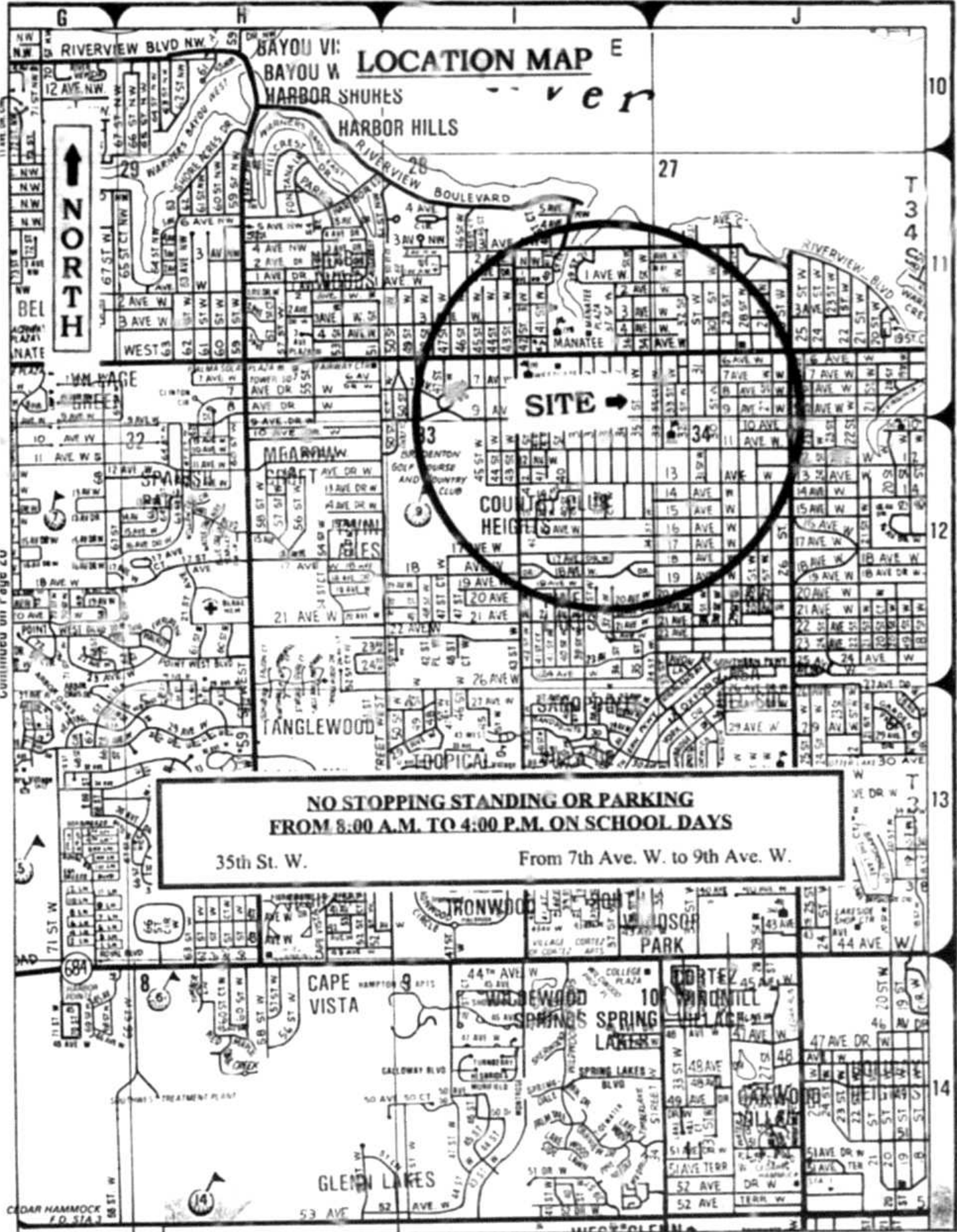

Continued on Page 26

Continued on Page 27

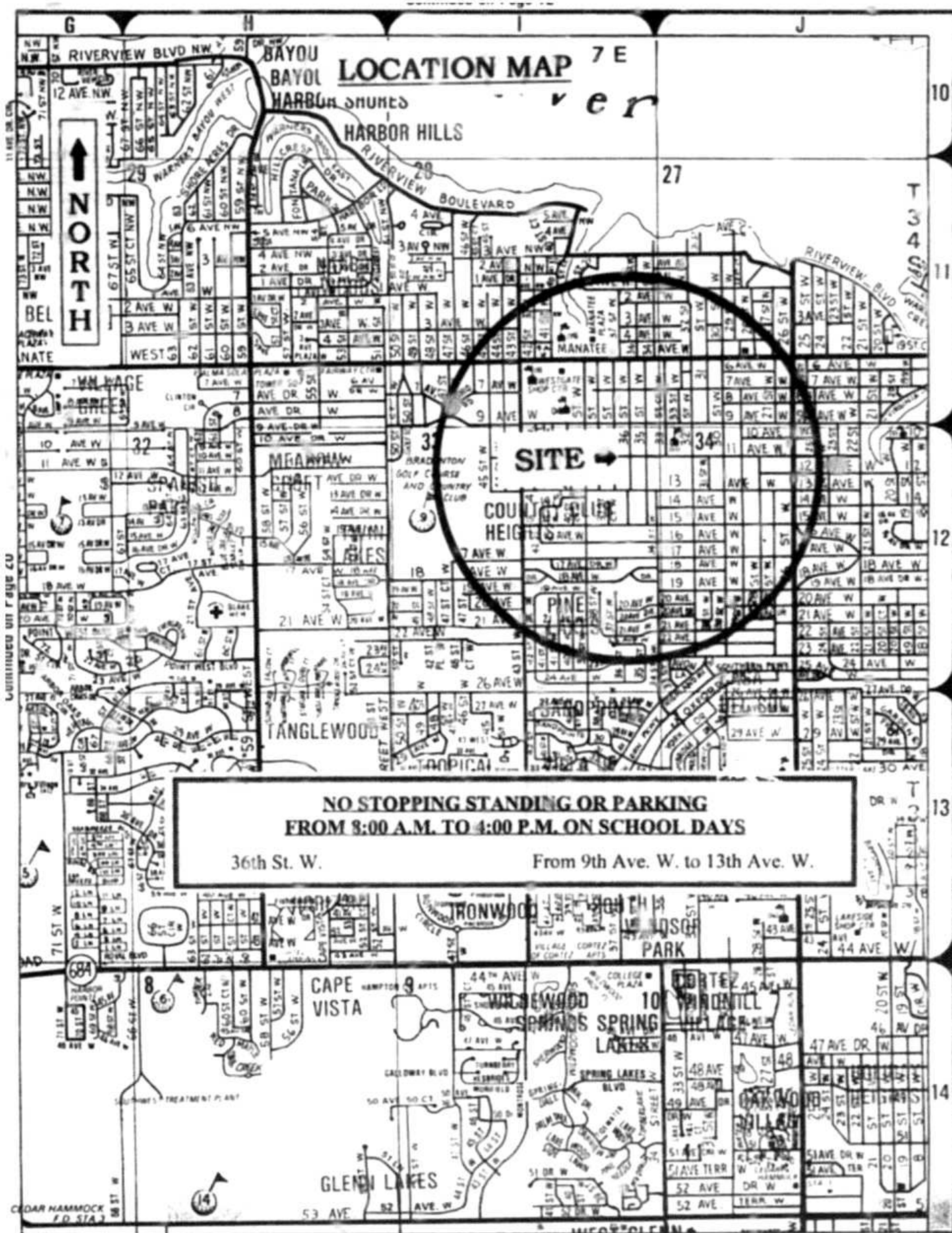

LOCATION MAP

NORTH

SITE →

**NO STOPPING STANDING OR PARKING
FROM 8:00 A.M. TO 4:00 P.M. ON SCHOOL DAYS**
36th St. W. From 9th Ave. W. to 13th Ave. W.

Continued on Page 20

Continued on Page 22

Continued on Page 26

LOCATION MAP

**NO STOPPING STANDING OR PARKING
FROM 6:00 P.M. TO 2:00 A.M. ON FRIDAY, SATURDAY & SUNDAY**

Holly Ave (north side only) From Broughton St. to Shepherd St.

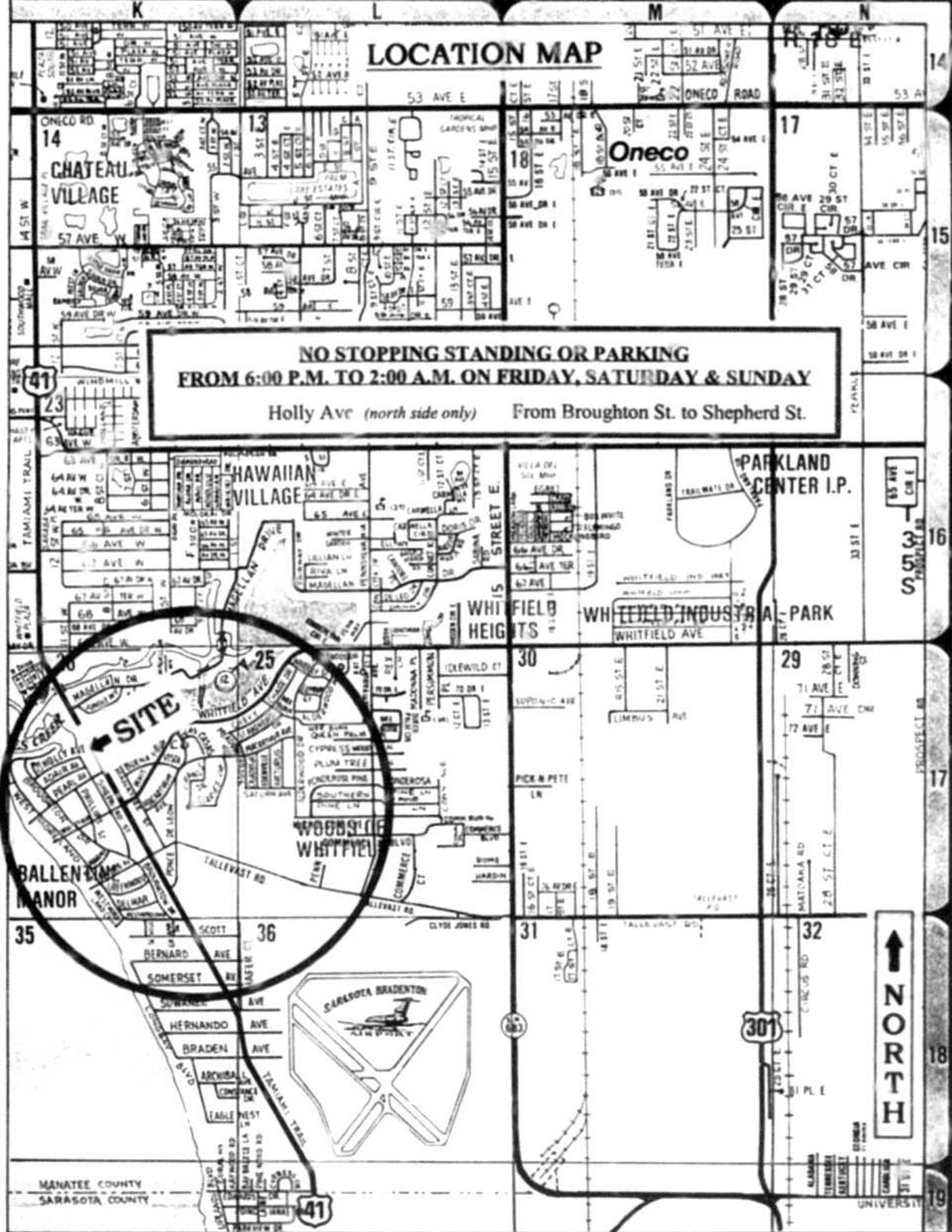

Continued on Page 28

LOCATION MAP

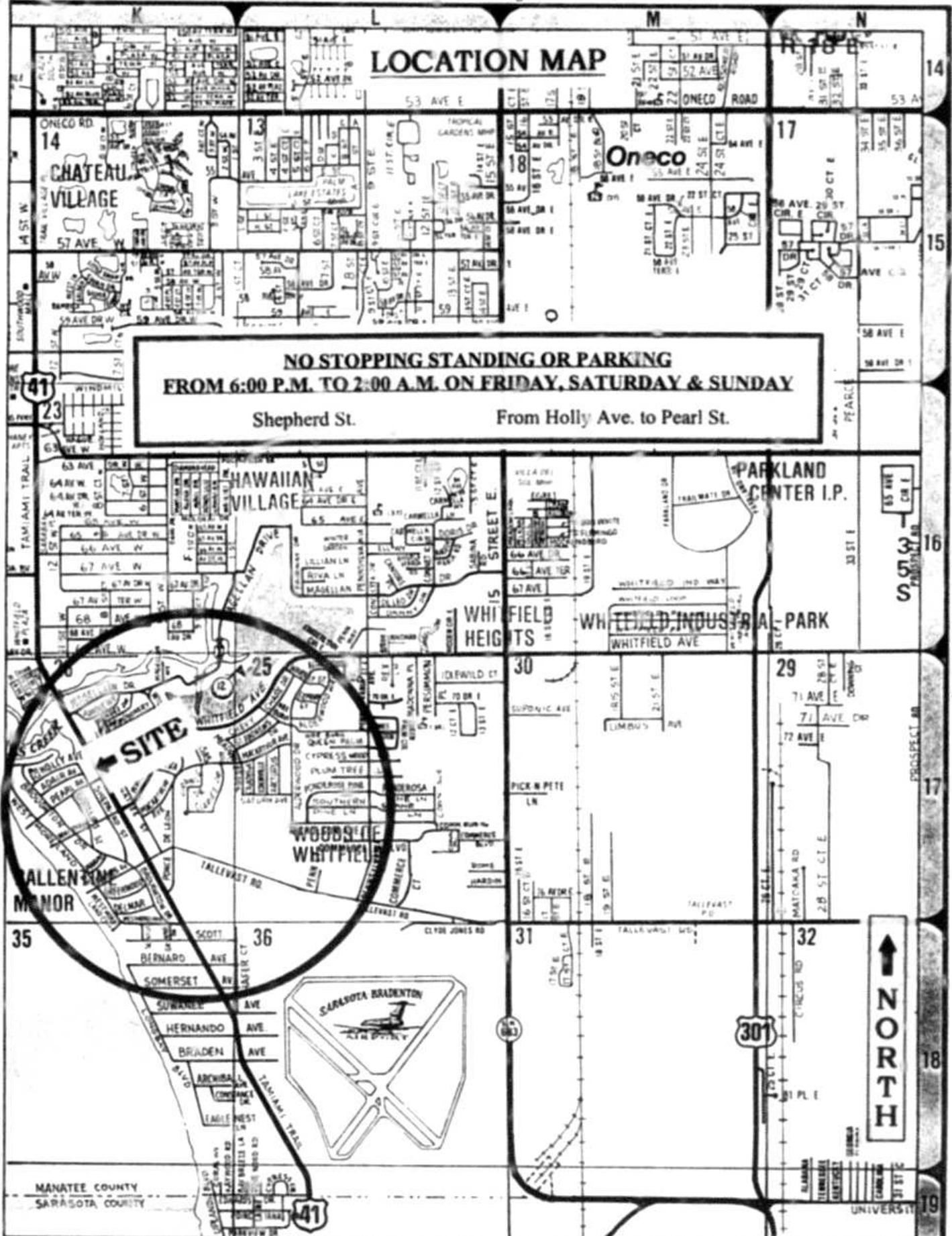

**NO STOPPING STANDING OR PARKING
FROM 6:00 P.M. TO 2:00 A.M. ON FRIDAY, SATURDAY & SUNDAY**

Shepherd St. From Holly Ave. to Pearl St.



Continued on Page 28

P E T I T I O N

Traffic Control Section
2904 12th Street Court East
Bradenton, Florida 34208

Attention: BOARD OF COUNTY COMMISSIONERS

We, the undersigned property owners on 17th St Ct E, respectfully petition the Board of County Commissioners of Manatee County, to act under the authority granted to you by Section 316.006 of the Florida Statutes to PROHIBIT PARKING AT ANY TIME ON Both SIDE(S) OF THE ROADWAY on:

STREET NAME: 17th St Ct East
BETWEEN 36th Ave AND 34th Ave

| OWNERS' SIGNATURES AS THEY APPEAR ON PROPERTY DEED | PROPERTY'S STREET ADDRESS | PROPERTY'S DESCRIPTION (VACANT, SINGLE-FAMILY, MULTI-FAMILY, OR OTHER) |
|--|--|--|
| <u>Donna S. Ball</u> | <u>3517 17th St Ct E</u> | <u>Single Family</u> |
| <u>Christian E. Zipperer</u> | <u>3512 17th St Ct E</u> | <u>Single Family</u> |
| <u>Margaret Harte</u> | <u>3523 17th St Ct E</u> | <u>Single Family</u> |
| <u>William Malshuk</u> | <u>3419 17th St Ct E</u> | <u>single family</u> |
| <u>Margie Thomas</u> | <u>3423 17th St Ct E Bradenton, FL 34208</u> | |
| <u>Tom & M^cLeod</u> | <u>3508 17th St Ct E Bradenton, FL 34208</u> | <u>Single Family</u> |
| <u>Ellen M^cLeod</u> | <u>3504 17th St Ct East Bradenton</u> | |
| <u>Caroline Harte</u> | <u>3519 17th St Ct E Bradenton</u> | <u>Single Family</u> |

Thank you
Donna H Ball
3517 17th St Ct E

P E T I T I O N

Traffic Control Section
2904 12th Street Court East
Bradenton, Florida 34208

Attention: BOARD OF COUNTY COMMISSIONERS

We, the undersigned property owners on 18th St. E. respectfully petition the Board of County Commissioners of Manatee County to act under the authority granted to you by Section 316.006 of the Florida Statutes to PROHIBIT PARKING AT ANY TIME ON both SIDE(S) OF THE ROADWAY on:

BETWEEN STREET NAME: 18th St. E. AND _____

WEST SIDE: FROM THE CORNER OF 53rd AVE. TO THE POINT OPPOSITE AND EVEN WITH THE SOUTH END OF THE 5331 PROPERTY LINE
EAST SIDE: FROM THE NORTH END OF THE 5319 PROPERTY LINE TO THE SOUTH END OF THE 5331 PROPERTY LINE

| OWNERS' SIGNATURES AS THEY APPEAR ON PROPERTY DEED | PROPERTY'S STREET ADDRESS | PROPERTY'S DESCRIPTION (VACANT, SINGLE-FAMILY, MULTI-FAMILY, OR OTHER) |
|--|------------------------------|--|
| Chad S. Heyhurst | 5319 18 th St. E. | SINGLE FAMILY |
| Sarah E. Heyhurst | " | " |
| Tellus D. Simmons | 5323 18 th St. E. | SINGLE FAMILY |
| Harold Forman | 5331 18 th St. E. | SINGLE FAMILY |
| John Wiley | 5415 12 th St. E. | single family |
| Frank Gaud | 5419 18 th St. E. | " |
| GLENN RIDER | 5428 18 th St. E. | " |
| Ashia Kamillard | 5436 18 th St. E. | SINGLE FAMILY |
| Patricia Sanders | 5339 18 th St. E. | single family |
| John M. Miller | 5407 18 St E | Single Family |





CHARLES B. WELLS
MANATEE COUNTY, FLORIDA

Sheriff



616 11th Street West
Bradenton, Florida 34205-7727
Telephone (813) 747-3011

Fax Numbers
Criminal Investigation Division (813) 748-5602
Administrative/Executive (813) 749-5401

June 9, 1998

David L. Davis
Traffic Operations Superintendent
Traffic Management Division
2904 12th Street Court East
Bradenton, Florida 34208

Mr. Davis,

The new ordinance "No Parking" on 34th Ave. E. from 12th Street Court East to the west side of the railroad tracks has moved the students to park on the east side of the tracks. Would you please revise the ordinance to include 34th Ave. East from 15th Street East, west to the location identified on the present ordinance?

Any consideration on this request would be appreciated

Sincerely,

CHARLES B. WELLS, SHERIFF
MANATEE COUNTY, FLORIDA

SGT. Ken Reese SR.
Sergeant Ken Reese SR.
Traffic Section/Patrol

An Accredited Agency

REQUEST NUMBER: C9802682 INIT DATE: 05/13/98 TAKEN BY: RED

DEPT/DIVN: TD DEPT CONTACT: LARRY MAU/TRAFFIC MGT. DUE DATE: 5/26/98

NAME: WARD, BETH COMMISSION DISTRICT:

ADDR: 711 W 35TH ST BRADENTON 34205

HOME PHONE: 941-748-6300 WORK PHONE: - - EXT:

REQUEST: WANTS "NO PARKING" SIGNS ON 35TH ST. W. BETWEEN
9TH AVE. & 7TH AVE., THE WEST SIDE OF THIS STREET
IS COUNTY. IS WILLING TO CIRCULATE PETITION.

RESOLUTION: SENT_"NO_PARKING"_PETITION_ON_5/13/98_____

EXRS: _

RLS SUBMITTED: _____ RLS COMPLETED: _____
COMPLETED BY: RITA_DRALUS/DAVE_DAVIS_____ DATE COMPLETED: 5/13/98
DEPT DIRECT SIGNED: X DATE: _5 13 98 DATE CITIZEN CONTACTED: _5 13 98
LAST ACCESSED DATE: 05/13/98 BY: RED STATUS: C CONFIDENTIAL: _

Michael Saunders & Company

Licensed Real Estate Broker

Exceptional Properties and Exceptional People

A Full Service Real Estate Company represented by the area's most experienced, professional real estate sales associates.

- Residential Sales
- Residential Leasing
- Property Management
- Asset Management
- Relocation Network
- International Marketing
- Resort/Hotel Management
- Interval Ownership
- Commercial Property
- The Real Estate Gallery

Chosen the Exclusive Affiliate of Sotheby's International Realty and the Estates Club, one of only five independent real estate companies nationwide to hold this distinction.

Marketing the Finest Real Estate Available on Florida's Gulf Coast.

CONFIDENTIALITY NOTE:

The information contained in this facsimile message is legally privileged and confidential information intended only for the use of the individual or entity named above. If the reader of this message is not the intended recipient, you are hereby notified that any dissemination, distribution or copying of this telecopy is strictly prohibited. If you have received this telecopy in error, please immediately notify us by telephone and return the original message to the above address via U.S. Mail.

DATE: May 15, 1998
 TOTAL NUMBER OF PAGES: 3
(including cover page)
 TO: Leta
 COMPANY: Citizens Action Center
 FAX: 745-3790
 FROM: Beck Ward

COMMENTS: The planning petition
will be forwarded to you
via mail. A copy will
also be forwarded to
McClash via fax.
If you have any questions
regarding this matter
please call, 748-6300
Beck Ward

There was some confusion w/ the
city, Ron Koper informed me
after the fact both sides of the
street are indeed counties.

BRADENTON

4400 MANATEE AVENUE WEST
 BRADENTON, FLORIDA 34209

RESIDENTIAL (941) 748-6300, FAX: (941) 749-5001

Michael Saunders & Company

Licensed Real Estate Broker

Exceptional Properties and Exceptional People

A Full Service Real Estate Company represented by the area's most experienced, professional real estate sales associates.

- Residential Sales
- Residential Leasing
- Property Management
- Asset Management
- Relocation Network
- International Marketing
- Resort/Hotel Management*
- Interval Ownership
- Commercial Property
- The Real Estate Gallery

Chosen the Exclusive Affiliate of Sotheby's International Realty and the Estates Club, one of only five independent real estate companies nationwide to hold this distinction.

Marketing the Finest Real Estate Available on Florida's Gulf Coast.

CONFIDENTIALITY NOTE:

The information contained in this facsimile message is legally privileged and confidential information intended only for the use of the individual or entity named above. If the reader of this message is not the intended recipient, you are hereby notified that any dissemination, distribution or copying of this telecopy is strictly prohibited. If you have received this telecopy in error, please immediately notify us by telephone and return the original message to the above address via U.S. Mail.

DATE: May 15, 1998
TOTAL NUMBER OF PAGES: 3
(including cover page)
TO: Joe McClash
COMPANY: County Commission
FAX: 745-3790
FROM: Beck Ward

COMMENTS: The following was forwarded to the Citizens Action Center.

I would appreciate your assistance in expediting this matter. There was some confusion w/ the city, Ron Koper informed me after the fact (petition) both sides of the street are indeed county & these petitions should be acceptable to the county. Any questions or comments please call me. Thanks,

BRADENTON Beck

4400 MANATEE AVENUE WEST
BRADENTON, FLORIDA 34209

RESIDENTIAL (941) 748-6300, FAX: (941) 749-5001

P E T I T I O N

Traffic Control Section
2904 12th Street Court East
Bradenton, Florida 34208

Attention: BOARD OF COUNTY COMMISSIONERS

We, the undersigned property owners on 35th St W respectfully petition the Board of County Commissioners of Manatee County to act under the authority granted to you by Section 316.006 of the Florida Statutes to PROHIBIT PARKING AT ANY TIME ON either SIDE(S) OF THE ROADWAY on:

BETWEEN STREET NAME: 35th St W
7th W AND 9th W

| OWNERS' SIGNATURES AS THEY APPEAR ON PROPERTY DEED | PROPERTY'S STREET ADDRESS | PROPERTY'S DESCRIPTION (VACANT, SINGLE-FAMILY, MULTI-FAMILY, OR OTHER) |
|--|---------------------------|--|
| JACK RAYBURN | 3402 9th Ave W. | SINGLE FAMILY |
| GENE TAYLOR | 815 35th St W | Single Family |
| Debra S. Rich | 809 35th St W | multi-Family |
| ROBERT S. HAWKER | 806 35th St W | Single Family |
| MARY PARDEN | 800 35th St W | Mary Parden |
| Joy Rader | 718 35th St W | Joy Rader |
| Joyce Chick | 720 35th St W | |
| Kenneth Dick | 740 35th St W | |
| Beck Ward | 711 35th W | |
| not home | 101 35th St W | |
| not home | 714 35th St W | |
| not home | 716 35th St W | |
| Rob Mettley | 719 35th St W | |
| Vacant | 723 35th St W | |
| Vacant | 801 35th St W | |
| Vacant | 814 35th St W | |
| Cawl Hickey | 807 35th St W | Single |

We the undersigned agree the parking on the West side of 35th Street West between 7th Avenue and 9th Avenue during school hours has become a hazard

I have been informed my signature below will enforce an ordinance for no parking during school hours on the above mentioned side of the street

I have also been informed there is indeed ample parking for students of Manatee High School on campus

If I have any questions regarding this matter I can contact Citizens Action Center, 742-5800

NAME

ADDRESS

| NAME | ADDRESS |
|--------------------|--|
| Viola & Smith | 704 35 th St W Bradenton FL 34205 |
| Don Wilson & wife | 714 35 th St W Bradenton FL 34205 |
| Joseph D. ... | 718 35 th St W BRADENTON FL 34205 |
| Steve & Bev Hawker | 806 35 th St W Bradenton FL 34205 |

7 Homes

1 vacant

2 no answer

4 Homes -

8 signatures

YES

We the undersigned agree the parking on the East side of 35th Street West between 7th Avenue and 9th Avenue during school hours has become a hazard.

I have been informed my signature below will enforce an ordinance for either no parking or 2 hour parking limit on the above mentioned side of the street.

I have also been informed there is indeed ample parking for students of Manatee High School on campus

If I have any questions regarding this matter I can contact Ron Koper at City Hall, 743-0800

| NAME | ADDRESS |
|-----------------|---|
| Lee Miller | 707 35 th St W Bradenton, FL |
| Leah Ponce | 27 35 th St W Bradenton, FL |
| Bob Kelly Ward | 711 35 th St W |
| Dennis Richards | 711 35 th St W |
| Michelle Miller | 719 35 th St W Bradenton FL |
| Vacant | 723 35 th St |
| Lacourt | 801 35 th St |
| Dygrid Mays | 815 35 th St W Bradenton FL |
| Robert Knight | 817 35 th St W |
| no answer | 813 35 th St W |
| no answer | 811 35 th St W |

9 Homes

2 Vacant

2 no answer

5 yes - homes

8 signatures

P E T I T I O N

Traffic Control Section
 2904 12th Street Court East
 Bradenton, Florida 34206

Attention: BOARD OF COUNTY COMMISSIONERS

We, the undersigned property owners on HOLLY AVE respectfully petition the Board of County Commissioners of Manatee County to act under the authority granted to you by Section 316.006 of the Florida Statutes to PROHIBIT PARKING AT ANY TIME ON NORTH SIDE(S) OF THE ROADWAY on:

STREET NAME: HOLLY AVE
 BETWEEN BRIGHTON AND SHEPHERD ST

| OWNERS' SIGNATURES AS THEY APPEAR ON PROPERTY DEED | PROPERTY'S STREET ADDRESS | PROPERTY'S DESCRIPTION (VACANT, SINGLE-FAMILY, MULTI-FAMILY, OR OTHER) |
|--|---------------------------|--|
| <i>[Signature]</i> | 117 Holly Ave | Single Family |
| <i>[Signature]</i> | 122 Holly Ave | Single Family |
| <i>[Signature]</i> | 134 Holly Ave | Sarasota Fl County |
| <i>[Signature]</i> | 138 Holly Ave | Single Family |
| <i>[Signature]</i> | 133 Holly Ave | Sarasota Fl |
| <i>[Signature]</i> | 125 Holly Ave | Sarasota Fl |
| <i>[Signature]</i> | 126 Holly Ave | Single Fam |
| <i>[Signature]</i> | 141 Holly Ave | " " |
| <i>[Signature]</i> | 142 Holly Ave | " " |
| <i>[Signature]</i> | 137 Holly Ave | " " |
| <i>[Signature]</i> | 121 Holly Ave | Sarasota Single Fam |
| <i>[Signature]</i> | 141 Holly Ave | Sarasota FL |
| <i>[Signature]</i> | 129 Holly Ave | Sarasota, FL Single Fam. |
| <i>[Signature]</i> | 145 Holly Ave | SARASOTA SINGLE FAM |
| <i>[Signature]</i> | 120 Holly Ave | Single Family |
| <i>[Signature]</i> | 155 Adams Ave | Sarasota, FL - Single |
| <i>[Signature]</i> | 7230 Shepherd St | Sarasota FL Single Fam |

P E T I T I O N

Traffic Control Section
2904 12th Street Court East
Bradenton, Florida 34208

Attention: BOARD OF COUNTY COMMISSIONERS

We, the undersigned property owners on SHEPHERD ST respectfully petition the Board of County Commissioners of Manatee County to act under the authority granted to you by Section 316.036 of the Florida Statutes to PROHIBIT PARKING AT ANY TIME ON ~~THE~~ BOTH SIDE(S) OF THE ROADWAY on:

STREET NAME: SHEPHERD ST
BETWEEN HOLLY AVE AND PEARL ST

| OWNERS' SIGNATURES AS THEY APPEAR ON PROPERTY DEED | PROPERTY'S STREET ADDRESS | PROPERTY'S DESCRIPTION (VACANT, SINGLE-FAMILY, MULTI-FAMILY, OR OTHER) |
|--|---------------------------|--|
| <i>[Signature]</i> | 117 Holly Ave | Single Family |
| <i>[Signature]</i> | 122 Holly Ave | Single Family |
| <i>[Signature]</i> | 134 Holly Ave | Single Family |
| <i>[Signature]</i> | 138 Holly Ave | Single FA |
| <i>[Signature]</i> | 133 Holly Ave | Sarasota FL |
| <i>[Signature]</i> | 135 Holly Ave | Sarasota FL |
| <i>[Signature]</i> | 126 Holly | Sarasota |
| <i>[Signature]</i> | 141 Holly Ave | SARASOTA Single fam. |
| <i>[Signature]</i> | 142 Holly Ave | Sarasota single fam. |
| <i>[Signature]</i> | 137 HOLLY AV | SARASOTA SINGLE FAM |
| <i>[Signature]</i> | 131 Holly Ave | Sarasota FL |
| <i>[Signature]</i> | 146 Holly Ave | Sarasota FL |
| <i>[Signature]</i> | 129 Holly Ave | Sarasota Single Fam |
| <i>[Signature]</i> | 145 Holly Ave | SARASOTA Single FA |
| <i>[Signature]</i> | MARTH F. ZURFOON | |
| <i>[Signature]</i> | 150 Holly Ave | Sarasota FL Single FA |
| <i>[Signature]</i> | 155 Ridge Ave | Single fam |
| <i>[Signature]</i> | 7230 Shepherd St | Sarasota FL |