

RESOLUTION R-94-122

**A RESOLUTION OF THE BOARD OF COUNTY  
COMMISSIONERS OF MANATEE COUNTY FLORIDA  
AUTHORIZING THE SUBMISSION OF A WEST COAST  
INLAND NAVIGATION DISTRICT GRANT APPLICATION  
AND ACCEPTING FOR THE MANATEE COUNTY PUBLIC  
WORKS DEPARTMENT MCLEWIS BAYOU DREDGE PROJECT.**

WHEREAS, the West Coast Inland Navigation District hereinafter referred to as "WCIND" is empowered and authorized by Section 374.976, Florida Statutes and Rule 16s-2, Florida Administrative Code, to undertake projects intended to alleviate problems associated with its waterway; and

WHEREAS, pursuant to Rule 16s-2.004, Florida Administrative Code the Manatee County Board of County Commissioners hereinafter referred to as the "County" shall approve each WCIND project application by Resolution; and

WHEREAS, the McLewis Bayou Dredge Project meets the eligibility criteria for WCIND funding.

NOW THEREFORE, BE IT RESOLVED, by the Board of County Commissioners of Manatee County, Florida, that:

1. The COUNTY hereby authorizes the submission of and approves the WCIND grant application for the Public Works Department McLewis Bayou Dredge Project as described in Exhibit A; and
2. Authorizes the Chairman of the Board of County Commissioners to execute the Application and all appropriate documents with regards to the submission of the grant.

ADOPTED with a quorum present and voting this the 10<sup>th</sup> day of May 1994.

BOARD OF COUNTY COMMISSIONERS  
OF MANATEE COUNTY, FLORIDA

BY: Stan Stephens  
CHAIRMAN

ATTEST: R. B. SHORE  
CLERK OF THE CIRCUIT COURT

BY: [Signature]

R-94-122

EXHIBIT A

WEST COAST INLAND NAVIGATION DISTRICT

WCIND WATERWAY DEVELOPMENT PROGRAM

APPLICATION FORM

RECEIVED

FEB 15 1994

MANATEE COUNTY  
COMMUNITY SERVICES

PROJECT NUMBER: (W.C.I.N.D.)  
DATE: 94-95  
(FISCAL YEAR)

- 1. APPLICANT: Manatee County Public Works
- 2. TYPE OF PROJECT: Dredge
- 3. PROJECT TITLE: McLewis Bayou
- 4. PROJECT LOCATION: From Manatee Avenue north to Manatee River

5. PROJECT DESCRIPTION AND PUBLIC BENEFIT TO RESULT: \_\_\_\_\_

The main access channel portion of the waterway which is used by boaters entering from Manatee River to the Bayou for fishing, recreation, etc.

6. TYPE AND STATUS OF REQUIRED PERMITS, EASEMENTS OR LEASES:

TYPE: Dredge & Fill Permit STATUS: To be announced  
DER Application to regulatory agencies, permit will be filed on 5/94.

7. ESTIMATED COMPLETION DATE: 1995

8. REQUIRED ATTACHMENTS:

- A. VICINITY MAP  XX
- B. SITE DEVELOPMENT PLAN
- C. PROJECTED COMPLETION DATE

FORM #1, Effective Date 11-11-90.

WCIND WATERWAY DEVELOPMENT PROGRAM

APPLICATION FORM - CONTINUED

9. WCIND FUNDS REQUESTED: \$40,000 DOLLARS

10. LIST AMOUNT(S) AND SOURCE(S) OF OTHER PROJECT FUNDS.

ATTACH SEPARATE SHEET CLEARLY INDENTIFYING AND ENUMERATING THE AMOUNT AND SOURCE OF ALL MATCHING FUNDS. ACCORDING TO SECTION 374.976 FS AND RULE 16S-2, F.A.C., MATCHING FUNDS ARE REQUIRED EXCEPT FOR CERTAIN EXCEPTED PROJECTS.

11. ESTIMATED TOTAL PROJECT COST: \$300,000 DOLLARS

12. APPLICANT IDENTIFICATION:

APPLICANT COUNTY: Manatee

LOCATED IN CITY OF: Bradenton (IF APPLICABLE)

LIAISON AGENT: Frederick J. Loveland

APPOINTED REPRESENTATIVE OF: Manatee COUNTY, BOARD OF  
(NAME OF COUNTY) COUNTY COMMISSIONERS

OR:

APPOINTED REPRESENTATIVE OF: \_\_\_\_\_ STATE OF FLORIDA  
(NAME OF DEPARTMENT)

ADDRESS: P. O. Box 1000

Bradenton, FL 34206

TELEPHONE NO: (813) 749-3030

13. SIGNATURE: \_\_\_\_\_

**STAN E. STEPHENS, CHAIRMAN  
BOARD OF COUNTY COMMISSIONERS**

DATE: May 10, 1994

ATTEST: R. B. SHORE  
CLERK OF CIRCUIT COURT

BY: \_\_\_\_\_

R-94-122  
MCLEWIS BAYOU

Manatee County has received a petition from the residents to dredge McLewis Bayou. Currently, the dredging request is funded by assessment among the parties involved, along with participation of Manatee County in the cost of dredge. This policy could be followed to arrive with the balance of cost required to complete the above dredge project.

A vicinity map and aerial photo of the site is provided. Survey and plotting of project area has been completed. The Bayou north of Riverview Boulevard will also need some dredging per surveyed cross section at this location. Prior to this work, for FY 93-94, WCIND did approve funding \$40,000 on this project. The additional dredging requirement north of Riverview Boulevard will cause the estimated cost of the project to increase by \$100,000. Therefore, additional assistance from WCIND toward the construction cost of this project is being requested. The temporary spoil site has been identified and the property owner has been contacted. A verbal agreement has been reached to use the property for a temporary spoil site. A legally binding document will be prepared to secure the property for a temporary spoil site.

The requested funds from WCIND is the 26.66% of the total cost to dredge the Bayou.

Project Completion Date: 1995

Resolution R-94-122  
McLewis Bayou Dredge Project

MANATEE COUNTY  
FLORIDA

SITE  
LOCATION

NORTH

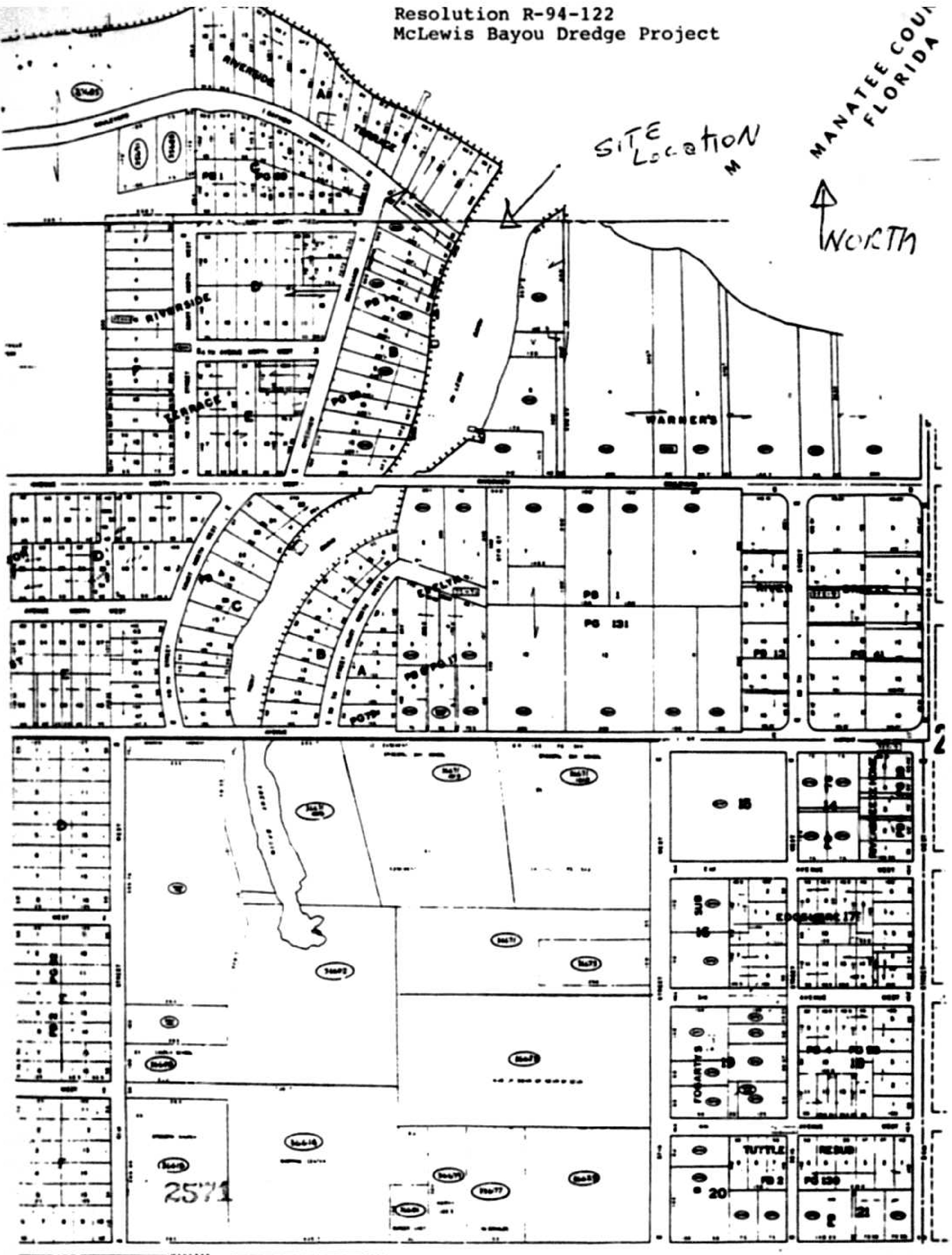

2712

K-74-172 McLEWIS Bayou Dredge Project

