

**A RESOLUTION CONFIRMING ADOPTION OF A
SPECIAL SEWER ASSESSMENT ROLL AND
ESTABLISHING SPECIAL ASSESSMENT LIENS
FOR SEWER ASSESSMENT PROJECT 6039080
ON 29TH STREET EAST IN ELLENTON**

WHEREAS, pursuant to the provisions of Chapter 63-1582, Laws of Florida, as amended (the "Special Act"), a resolution approving the above identified project was adopted by this Board of County Commissioners of Manatee County, Florida (the "County"), after a public hearing. The resolution determined that the parcels of real property described in the preliminary special assessment roll attached thereto would be especially benefited by the construction or other improvement of the project, approved the project, and made certain other determinations in connection therewith; and

WHEREAS, pursuant to the provisions of the Special Act, a first public hearing was conducted on October 6, 1998 and Resolution R-98-192 approving the project was adopted and recorded in Official Record Book 1570, Pages 6328-6345; respectively of the Public Records of Manatee County, Florida which approved sanitary sewer improvements along the following road in Manatee County, Florida:

**29TH STREET EAST
FROM WELLON RANCH ROAD, EAST APPROXIMATELY 1,250' TO PARKWOOD LAKES**

WHEREAS, pursuant to the provisions of the Special Act, the second public hearing on the final special assessment roll was duly held by this Board of County Commissioners on the 20th day of August, 2002 and proof of publication of the notice of the second public hearing has been filed with this Board of County Commissioners; and

WHEREAS, this Board of County Commissioners heard and considered all evidence submitted, presentations made and documents filed before and during the public hearing and is fully advised and informed in this matter.

BK 1765 PG 4458 DKT # 1658733 1 of 16

NOW, THEREFORE, BE IT RESOLVED, by the Board of County Commissioners of Manatee County, Florida, that:

1. The final special assessment roll attached hereto as Exhibit "A" and by reference incorporated herein and made a part hereof is hereby approved and confirmed.

2. Liens are hereby imposed against all lots and parcels of land upon which the amount of the assessment has not been paid as indicated on the special assessment roll.

3. All assessment liens established by this resolution are subject to modification in accordance with Section 12 of the Special Act.

4. All assessment liens shall become payable in equal annual installments of principal and interest in each of the succeeding fifteen (15) years with interest at the rate of 7 1/2 percent per annum. The liens shall bear interest at said rate from the date of the adoption of this resolution except that special assessment liens may be paid without interest within thirty (30) days after adoption of this resolution. Any assessment may be paid at any time together with interest accrued thereon to the date of payment. The above interest rate may be adjusted upon the issuance and sale of bonds secured by the special assessment liens established herein as authorized by Section 5 of the Special Act.

5. The Tax Collector for Manatee County is hereby authorized to collect all special assessments provided for in this Resolution in accordance with the uniform method for the levy, collection and enforcement of non-ad valorem assessments as provided in Chapter 197, Florida Statutes, and all applicable provisions shall apply to the collection and enforcement of the special assessment liens, including the date on which payment becomes due. The first payment is due on the date of payment of ad valorem taxes for 2002 and shall become delinquent in any year on the day when unpaid ad valorem taxes would become delinquent.

6. Upon the subdividing of all or a portion of a lot or parcel against which a special assessment lien has been established, all installments of principal remaining unpaid and interest due thereon shall be due and payable without notice or other proceedings, and the county may, at any time after such subdividing, institute foreclosure or other appropriate proceedings for the collection of all principal or interest on any or all portions of a lot or parcel against which the lien has been established.

7. The Clerk of the Circuit Court is hereby authorized and requested to cause this resolution with the final special assessment roll attached hereto as Exhibit "A" to be filed for record and recorded in the Official Records Books of the county, and to forward a certified copy to the Tax Collector for Manatee County.

ADOPTED with a quorum present and voting this the 20th day of August, 2002.

**BOARD OF COUNTY COMMISSIONERS
OF MANATEE COUNTY, FLORIDA**

Greg Stein
Chairman

**ATTEST: R.B. SHORE
Clerk of the Circuit Court**

By: *Susan G. Rome* **D.C.**

EXHIBIT "A"

PART 1 OF 2

R-02-177

**SPECIAL OWNERSHIP AND ASSESSMENT ROLL FOR
SEWER ASSESSMENT PROJECT NO. 6039080**

29TH STREET EAST (ELLENTON)

Pursuant to Chapter 63-1582, Laws of Florida, as amended, a Special Assessment Lien is levied against the hereinafter described real property for the construction or other improvement of:

**29TH STREET EAST
FROM WELLON RANCH ROAD, EAST APPROXIMATELY 1,250' TO PARKWOOD LAKES**

in the amount set forth opposite each lot or parcel of real property with 1/15th of the total amount thereof due and payable each year, together with interest thereon at the rate of 7 1/2% per annum, with the total unpaid balance due and payable fifteen (15) years from the date thereon. The total number of equivalent residential units (ERU's) 22.667 multiplied by \$ 3,000.00 equals a total assessable cost of \$ 68,000.00.

BOARD RECORDS

**EXHIBIT "A"
PART 2 OF 2
5 PAGES**

**SEWER ASSESSMENT PROJECT NO. 6039080
29TH STREET EAST**

DP#	DESCRIPTION OF PROPERTY	NAME AND ADDRESS OF OWNER	CURRENT YEAR ASSESSMENT
843500109	LOT 1 WINTERLAND ESTATES SUB P1#8435.0010/9 SEC 11 TWP 34-S RNG 18-E PR USE: 0100 TAX_CD: 0001 SPLIT: LOCATION: 2815 81ST AVE E NCT	GIBSON, CARL H GIBSON, SARA 2815 81ST AVE E ELLENTON, FL 34222	29TH ST E SEWER 1 ERU 3000.00 PER ERU TOTALS 3000.00 TOTAL ASSESSMENT: 3000.00 ANNUAL PAYMENT: 339.86
843501107	LOT 21 WINTERLAND ESTATES SUB P1#8435.0110/7 SEC 11 TWP 34-S RNG 18-E PR USE: 0100 TAX_CD: 0001 SPLIT: LOCATION: 2816 81ST AVE E NCT	OHM, KATHRYN M 2816 81ST AVE ELLENTON, FL 34222	29TH ST E SEWER 1 ERU 3000.00 PER ERU TOTALS 3000.00 TOTAL ASSESSMENT: 3000.00 ANNUAL PAYMENT: 339.86
843501156	LOT 22 WINTERLAND ESTATES SUB P1#8435.0115/6 SEC 11 TWP 34-S RNG 18-E PR USE: 0100 TAX_CD: 0001 SPLIT: LOCATION: 2815 82ND AVE E NCT	MILLER, JEFFREY PAUL MILLER, JAYNE ELAINE 2815 82ND AVE E ELLENTON, FL 34222	29TH ST E SEWER 1 ERU 3000.00 PER ERU TOTALS 3000.00 TOTAL ASSESSMENT: 3000.00 ANNUAL PAYMENT: 339.86
843502204	LOT 43 WINTERLAND ESTATES SUB P1#8435.0220/4 SEC 11 TWP 34-S RNG 18-E PR USE: 0100 TAX_CD: 0001 SPLIT: LOCATION: 8211 29TH ST E NCT	WATSON, RICHARD L WATSON, KARIN 8211 29TH ST E ELLENTON, FL 34222	29TH ST E SEWER 1 ERU 3000.00 PER ERU TOTALS 3000.00 TOTAL ASSESSMENT: 3000.00 ANNUAL PAYMENT: 339.86
843510009	THE E 100 FT OF THE N 465.5 FT OF THE SW1/4 OF THE NW1/4, LESS N 30 FT FOR RD AS DESC IN ORB 492 P 237 PRMCF (1666/5015) P1#8435.1000/9 SEC 11 TWP 34-S RNG 18-E PR USE: 0100 TAX_CD: 0001 SPLIT: LOCATION: 8319 29TH ST E NCT	MCCLELLAN, HAZEL 8319 29TH ST E ELLENTON, FL 34222	29TH ST E SEWER 1 ERU 3000.00 PER ERU TOTALS 3000.00 TOTAL ASSESSMENT: 3000.00 ANNUAL PAYMENT: 339.86
843510058	W 100 FT OF THE E 200 FT OF THE N 465.6 FT OF SW1/4 OF SEC 11 LESS N 30 FT FOR RD P1#8435.1005/8 SEC 11 TWP 34-S RNG 18-E PR USE: 0100 TAX_CD: 0001 SPLIT: LOCATION: 8315 29TH ST E NCT	ABRUZZINO, REBECCA A ABRUZZINO, REBECCA A TRUST 8315 29TH ST E ELLENTON, FL 34222	29TH ST E SEWER 1 ERU 3000.00 PER ERU TOTALS 3000.00 TOTAL ASSESSMENT: 3000.00 ANNUAL PAYMENT: 339.86

91 40 9 9977 99 59211 XB

DP#	DESCRIPTION OF PROPERTY	NAME AND ADDRESS OF OWNER	CURRENT YEAR ASSESSMENT
843510108	E 350 FT, LESS E 200 FT OF THE N 320.4 FT OF SW1/4 OF NW1/4 OF SEC 11 LESS N 30 FT FOR RD SUBJ TO EASMT TO MANATEE CO DESC IN ORB 921 P 651 PRMCF P-10-4, P1#8435.1010/8 SEC 11 TWP 34-S RNG 18-E PR USE: 0100 TAX_CD: 0001 SPLIT: LOCATION: 8311 29TH ST E NCT	RAMON, EUSEBIO RAMON, GLORIA 8311 29TH ST E ELLENTON, FL 34222	29TH ST E SEWER 1 ERU 3000.00 PER ERU TOTALS 3000.00 TOTAL ASSESSMENT: 3000.00 ANNUAL PAYMENT: 339.86
843510157	E 450 FT LESS E 350 FT OF THE N 465.6 FT OF SW1/4 OF NW1/4 OF SEC 11, LESS N 30 FT FOR RD SUBJ TO EASMT TO MANATEE CO DESC IN ORB 921 P 650 PRMCF P-10-5, P1#8435.1015/7 SEC 11 TWP 34-S RNG 18-E PR USE: 0100 TAX_CD: 0001 SPLIT: LOCATION: 8307 29TH ST E NCT	DENNEY, RALPH E DENNEY, JOYCE A 8307 29TH ST E ELLENTON, FL 34222	29TH ST E SEWER 1 ERU 3000.00 PER ERU TOTALS 3000.00 TOTAL ASSESSMENT: 3000.00 ANNUAL PAYMENT: 339.86
844400002	LOT 1 WELLONS RANCH ESTATES UNIT ONE P1#8444.0000/2 SEC 11 TWP 34-S RNG 18-E PR USE: 0100 TAX_CD: 0001 SPLIT: LOCATION: 2818 80TH AVE E NCT	BOSCH, MARION BOSCH, FRANCIS 2818 80TH AVE E ELLENTON, FL 34222	29TH ST E SEWER 1 ERU 3000.00 PER ERU TOTALS 3000.00 TOTAL ASSESSMENT: 3000.00 ANNUAL PAYMENT: 339.86
851600007	LOTS 1,2,3,4,5 AND THE W 8.4 FT OF LOT 6, BLK H, ROSE PARK; THAT PART OF LOT 6, BEING FURTHER DESC AS: BEG AT THE NE COR OF SD LOT 5, RUN TH ELY ALG N LN OF SD LOT 6 TO LAKE ST, RUN TH S & PARALLEL WITH THE W LN OF LOT 6 TO THE S LN THEREOF, RUN TH W ON THE S LN OF LOT 6 TO THE W LN THEREOF, RUN TH N ALG THE W LN OF LOT 6 TO POB, P1#8516.0000/7 SEC 11 TWP 34-S RNG 18-E PR USE: 1100 TAX_CD: 0001 SPLIT: LOCATION: 8003 US 301 N NCT	ROGERS FAMILY LIMITED PARTNERSHIP THE PO BOX 698 SARASOTA, FL 34230-0698	29TH ST E SEWER 3.67 ERU 3000.00 PER ERU TOTALS 11,000 TOTAL ASSESSMENT: ANNUAL PAYMENT: 1246.16
851900001	LOT 6 LESS THAT PART DESC AS: BEG AT NE COR OF LOT 5, BLK H & RUN THENCE ELY ALG N LN OF SD LOT 6 TO LAKE ST, RUN THENCE S & PARALLEL WITH W LN OF LOT 6 TO S LN THEREOF, RUN THENCE W ON S LN OF LOT 6 TO W LN THEREOF, RUN THENCE N ALG W LN OF LOT 6 TO POB, ALSO LOT 7 BLK H P-17-1 ROSE PARK SUB P1#8519.0000/1 SEC 11 TWP 34-S RNG 18-E PR USE: 0100 TAX_CD: 0001 SPLIT: LOCATION: 8016 29TH ST E NCT	HIGHTOWER, JOHN RUSSELL HIGHTOWER, MARY CLYATT BOX 71 ELLENTON, FL 34222	29TH ST E SEWER 1 ERU 3000.00 PER ERU TOTALS 3000.00 TOTAL ASSESSMENT: 3000.00 ANNUAL PAYMENT: 339.86

16 to 9 7997 96 99LT XB

DP#	DESCRIPTION OF PROPERTY	NAME AND ADDRESS OF OWNER	CURRENT YEAR ASSESSMENT
852200005	LOTS 8, 9, 10 & W 1/2 OF LOT 11 BLK H ROSE PARK P-17-3 P1#8522.0000/5 SEC 11 TWP 34-S RNG 18-E PR USE: 0100 TAX_CD: 0001 SPLIT: LOCATION: 8112 29TH ST E NCT	HIGHTOWER, JAMES T HIGHTOWER, HELEN 8112 29TH ST E ELLENTON, FL 34222	29TH ST E SEWER 1 ERU 3000.00 PER ERU TOTALS 3000.00 TOTAL ASSESSMENT: 3000.00 ANNUAL PAYMENT: 339.86
852500107	THE E1/2 OF LOT 11 AND ALL OF LOT 12, BLK H, ROSE PARK P1#8525.0010/7 SEC 11 TWP 34-S RNG 18-E PR USE: 0100 TAX_CD: 0001 SPLIT: LOCATION: 8120 29TH ST E NCT	VASQUEZ, RAUL VASQUEZ, HOLLI 8120 29TH ST E ELLENTON, FL 34222	29TH ST E SEWER 1 ERU 3000.00 PER ERU TOTALS 3000.00 TOTAL ASSESSMENT: 3000.00 ANNUAL PAYMENT: 339.86
852510007	LOT 13 BLK H ROSE PARK P1#8525.1000/7 SEC 11 TWP 34-S RNG 18-E PR USE: 0100 TAX_CD: 0001 SPLIT: LOCATION: 8204 29TH ST E NCT	GALLANT, CHRISTINE 8204 29TH ST E ELLENTON, FL 34222	29TH ST E SEWER 1 ERU 3000.00 PER ERU TOTALS 3000.00 TOTAL ASSESSMENT: 3000.00 ANNUAL PAYMENT: 339.86
852510056	LOT 14 BLK H ROSE PARK P1#8525.1005/6 SEC 11 TWP 34-S RNG 18-E PR USE: 0100 TAX_CD: 0001 SPLIT: LOCATION: 8208 29TH ST E NCT	DIAZ, JOSE JUAN DIAZ, EVA M 8208 29TH ST E ELLENTON, FL 34222	29TH ST E SEWER 1 ERU 3000.00 PER ERU TOTALS 3000.00 TOTAL ASSESSMENT: 3000.00 ANNUAL PAYMENT: 339.86
852510064	LOTS 15, 16 BLK H ROSE PARK P1#8525.1006/4 SEC 11 TWP 34-S RNG 18-E PR USE: 0100 TAX_CD: 0001 SPLIT: LOCATION: 8212 29TH ST E NCT	PERALES, ANTONIO JR PERALES, DOMINGA PERALES, CONNIE 8212 29TH ST E	29TH ST E SEWER 1 ERU 3000.00 PER ERU TOTALS 3000.00 TOTAL ASSESSMENT: 3000.00 ANNUAL PAYMENT: 339.86
852510106	LOTS 17, 18 BLK H; SUBJ TO DRAIN EASMT AS DESC IN OR 1035 P 1556 ROSE PARK P1#8525.1010/6 SEC 11 TWP 34-S RNG 18-E PR USE: 0100 TAX_CD: 0001 SPLIT: LOCATION: 8220 29TH ST E NCT	PRAUGHT, JOSEPH 8220 29TH ST E ELLENTON, FL 34222	29TH ST E SEWER 1 ERU 3000.00 PER ERU TOTALS 3000.00 TOTAL ASSESSMENT: 3000.00 ANNUAL PAYMENT: 339.86
852510155	LOTS 19, 20 BLK H ROSE PARK P1#8525.1015/5 SEC 11 TWP 34-S RNG 18-E PR USE: 0100 TAX_CD: 0001 SPLIT: LOCATION: 8308 29TH ST E NCT	GARCIA, AUDREY LEE 3305 POPE RD BRADENTON, FL 34211-9189	29TH ST E SEWER 1 ERU 3000.00 PER ERU TOTALS 3000.00 TOTAL ASSESSMENT: 3000.00 ANNUAL PAYMENT: 339.86

9T 10 8 0 9977 96 991T XB

COUNTY OF MANATEE
 REAL ESTATE SPECIAL ASSESSMENT ROLL FOR 29TH ST E SEWER

PROJ129

PAGE 4

DP#	DESCRIPTION OF PROPERTY	NAME AND ADDRESS OF OWNER	CURRENT YEAR ASSESSMENT
852600006	LOT 21 BLK H ROSE PARK P-17-7 P1#8526.0000/6 SEC 11 TWP 34-S RNG 18-E PR USE: 0801 TAX_CD: 0001 SPLIT: LOCATION: 8312 29TH ST E NCT	DAMRON, DOUGLAS M P O BOX 168 ELLENTON, FL 34222	29TH ST E SEWER 1 ERU 3000.00 PER ERU TOTALS 3000.00 TOTAL ASSESSMENT: 3000.00 ANNUAL PAYMENT: 339.86
852700004	LOTS 22 AND 23, BLK H, ROSE PARK P1#8527.0000/4 SEC 11 TWP 34-S RNG 18-E PR USE: 0100 TAX_CD: 0001 SPLIT: LOCATION: 8320 29TH ST E NCT	RHOADES, ROBERT H RHOADES, MARLENE H P O BOX 526 ELLENTON, FL 34222-0526	29TH ST E SEWER 1 ERU 3000.00 PER ERU TOTALS 3000.00 TOTAL ASSESSMENT: 3000.00 ANNUAL PAYMENT: 339.86

EXHIBIT "B"

AFFIDAVIT OF NOTICE

R-02-177

SPECIAL SEWER ASSESSMENT PROJECT NO. 6039080
29TH STREET EAST (ELLENTON)

STATE OF FLORIDA }
COUNTY OF MANATEE }

BEFORE ME, the undersigned authority, this day personally appeared SHERRI ROBINSON who being first duly sworn, deposes and says:

1. That I was an employee of Manatee County at all times material to this affidavit.
2. That I have personal knowledge of the facts stated herein.
3. That a notice conforming with Exhibit "B-1" attached hereto was prepared for first class mailing, that such a notice was addressed to each and every contiguous property owner identified on Exhibit "A", attached to Resolution R-02-177 as presented to the Board of County Commissioners on the 20th day of August, 2002 and prepared for mailing to such owner at the address indicated on Exhibit "A", and deposited for 1st class mailing with the county courier in the ordinary course of business on the 31st day of July, 2002.

FURTHER YOUR AFFIANT SAITH NOT

Sherril Robinson
Signature of Affiant

State of Florida
County of Manatee

Sworn to (or affirmed) and subscribed before me this 31st day of July, 2002 by Sherril Robinson.

Signature of Notary Public - State of Florida: Deloris Crockett

Print, Type or Stamp Commissioned Name of Notary Public:



Personally Known Or Produced Identification _____
Type of Identification Produced _____

BK 1765 PG 4467 10 of 16

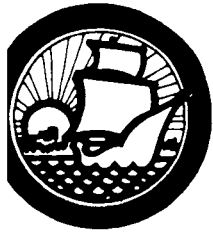

**MANATEE COUNTY
GOVERNMENT**
Project Management Department

July 31, 2002

Exhibit "B-1"
Part 1 of 2

D.P. #:FIELD(DP)
FIELD(NAME)
FIELD(ADDRESS)
FIELD(CITY)

BK 1765 PG 4468 11 of 16

**RE: Notice of Public Hearing
Resolution R-02-177 Providing for the Adoption of the Special Assessment Roll and
Collection of Special Assessment Liens for Sewer Assessment Project No. 6039080 on
29th Street East in Ellenton**

Dear FIELD(NAME):

The Board of County Commissioners of Manatee County, Florida will conduct a public hearing in the Chambers on the 1st floor of the Manatee County Administrative Center, 1112 Manatee Avenue West, Bradenton, Florida on **August 20, 2002 at 9:00 a.m.**, or as soon thereafter, to consider Resolution **R-02-177**. The purpose of the hearing and resolution is to adopt the special assessment roll as required by Chapter 63-1582, Laws of Florida as amended and provide for the collection of special assessments by the Tax Collector in accordance with the uniform method established in Section 197.3632, Florida Statutes.

The final special assessment roll showing the total costs and expenses of the project has been completed and is on file in the Office of the Clerk of the Circuit Court and the Project Management Department and is open for inspection.

The improvements for which special assessment liens will be imposed are described as sewer improvements along the following road described as follows:

**29TH STREET EAST
FROM WELLON RANCH ROAD, EAST APPROXIMATELY 1,250' TO PARKWOOD LAKES**

The enclosed statement provides details pertaining to the special assessment.

Pursuant to State Law, we are required to notify you of the following:

1. Your assessment, the unit of measurement applied against each parcel to determine the assessment, and the total revenue the county will collect is shown on the attached statement.

2. The failure to pay the assessment will cause a tax certificate to be issued against the property which may result in a loss of title.
3. Assessments may be paid in equal payments over a period of fifteen (15) years with interest at the rate of 7 1/2% per annum.
4. All affected property owners have a right to appear at the hearing and to file written objections with the Board of County Commissioners within twenty (20) days of this notice. Written objections should be sent to the Manatee County Project Management Department located at 1026 26th Avenue East, Bradenton, Florida.
5. Upon the subdividing of all or a portion of a lot or parcel against which a special assessment lien has been established, all installments of principal remaining unpaid and interest due thereon shall be due and payable without notice or other proceedings.
6. According to Section 286.0105, Florida Statutes, if any person decides to appeal any decision made by the Board with respect to any matter to be considered at the public hearing, a record of the proceedings may be required and for such purpose, you may need to insure that a verbatim record of the proceedings is made, which would include any testimony or evidence upon which the appeal is to be based.

If a property owner cannot afford the improvements, a Hardship Program managed by the Manatee County Department of Community Service is in place. Qualification is based on income, and you may receive assistance for a portion of your assessment on your tax bill depending on your income.

The Board of County Commissioners of Manatee County, Florida, does not discriminate upon the basis of any individual's disability status. This non-discrimination policy involves every aspect of the Board's functions including one's access to participation, employment, or treatment in its programs or activities. Anyone requiring reasonable accommodation for this meeting as provided for in the Americans with Disabilities Act, should contact Rita Dralus at 749-7100; TDD ONLY 749-7100 and wait 60 seconds; FAX 745-3790.

Rules of Procedure for this public hearing are in effect pursuant to R-94-90. Copies of this Resolution are available for review at the Citizens Action Center on the ninth floor of the County Administration Building, 1112 Manatee Avenue West, Bradenton, Florida, and is available for purchase from the County Administrator's Office at cost.

Copies of the proposed resolution and the special improvement assessment roll are available for review at the Manatee County Project Management Department located at 1026 26th Avenue East, Bradenton, Florida during normal business hours. For additional information, you may call Tom Yarger at 708-7450, extension 7333.

Sincerely,

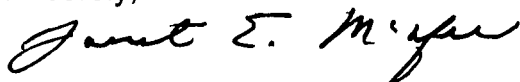

Janet E. McAfee
 Director, Project Management

cc: Daniel T. Gray, Director, Utility Operations
 John Barnott, Utilities Customer Service Administrator
 Project File: 6039080

THIS IS NOT A BILL!

SPECIAL SEWER ASSESSMENT STATEMENT

FOR

PROJECT NO. 6039080

29TH STREET EAST (ELLENTON)

D.P. #: <dp>
<name>
<address>
<city> <state> <zip>

THE TOTAL REVENUE THAT THE COUNTY WILL COLLECT FROM THE SEWER ASSESSMENT:										
	\$68,000.00									
THE UNIT OF MEASUREMENT APPLIED AGAINST EACH PARCEL TO DETERMINE THE ASSESSMENT IS COST PER ERU:										
	\$3,000.00									
THE TOTAL NUMBER OF ERU'S (UNITS) ASSIGNED TO YOUR PROPERTY IS:	1									
YOUR TOTAL SEWER ASSESSMENT IS:	\$3,000.00									
THE PRINCIPAL AND INTEREST PAYMENT DUE WITH YOUR 2002 TAXES WILL BE:										
<table style="width: 100%; border-collapse: collapse;"> <tr> <td style="width: 10%; text-align: right;">\$133.33</td> <td style="width: 10%; text-align: center;">=</td> <td>PRINCIPAL</td> </tr> <tr> <td style="text-align: right;">\$93.24</td> <td style="text-align: center;">=</td> <td>INTEREST</td> </tr> <tr> <td style="text-align: right; border-top: 1px solid black; border-bottom: 3px double black;">\$339.86</td> <td style="text-align: center;">=</td> <td>SEWER ASSESSMENT PAYMENT WHICH WILL APPEAR ON YOUR 2002 TAX BILL</td> </tr> </table>	\$133.33	=	PRINCIPAL	\$93.24	=	INTEREST	\$339.86	=	SEWER ASSESSMENT PAYMENT WHICH WILL APPEAR ON YOUR 2002 TAX BILL	
\$133.33	=	PRINCIPAL								
\$93.24	=	INTEREST								
\$339.86	=	SEWER ASSESSMENT PAYMENT WHICH WILL APPEAR ON YOUR 2002 TAX BILL								

NOTE: NO MONEY IS DUE AT THIS TIME. YOU WILL RECEIVE A BILL FROM THE TAX COLLECTOR'S OFFICE GIVING YOU 30 DAYS TO PAY YOUR TOTAL SEWER ASSESSMENT WITHOUT ANY INTEREST. IF NOT PAID IN THE 30 DAY PERIOD, YOUR FIRST PAYMENT WILL AUTOMATICALLY APPEAR ON YOUR 2002 TAX BILL.

AUGUST 20, 2002

SEWER ASSESSMENT PROJECT NO. 6039080
29TH STREET EAST (ELLENTON)

TOTAL NUMBER OF PARCELS:	20
TOTAL NUMBER OF ERU'S:	<u>22.6666666666667</u>
COST PER ERU:	<u>\$3,000.00</u>
TOTAL SEWER ASSESSMENT:	<u>\$68,000.00</u>

D.P. #	NAME	ERU	SEWER ASSESSMENT	ANNUAL PAYMENT
8435.0010/9	GIBSON	1	3,000.00	339.86
8435.0110/7	OHM	1	3,000.00	339.86
8435.0115/6	MILLER	1	3,000.00	339.86
8435.0220/4	WATSON	1	3,000.00	339.86
8435.1000/9	MCCLELLAN	1	3,000.00	339.86
8435.1005/8	ABRUZZINO	1	3,000.00	339.86
8435.1010/8	RAMON	1	3,000.00	339.86
8435.1015/7	DENNEY	1	3,000.00	339.86
8444.0000/2	BOSCH	1	3,000.00	339.86
8516.0000/7	ROGERS FAMILY LIMITED PARTNERSHIP	1 1/2" METER	11,000.00	1,246.16
8519.0000/1	HIGHTOWER	1	3,000.00	339.86
8522.0000/5	HIGHTOWER	1	3,000.00	339.86
8525.0010/7	VASQUEZ	1	3,000.00	339.86
8525.1000/7	GALLANT	1	3,000.00	339.86
8525.1005/6	DIAZ	1	3,000.00	339.86
8525.1006/4	PERALES	1	3,000.00	339.86
8525.1010/6	PRAUGHT	1	3,000.00	339.86
8525.1015/5	GARCIA	1	3,000.00	339.86
8526.0000/6	DAMRON	1	3,000.00	339.86
8527.0000/4	RHOADES	1	3,000.00	339.86
		23	68,000.00	7,703.53

SEWER ASSESSMENT PROJECT NO. 6039080

29TH STREET EAST

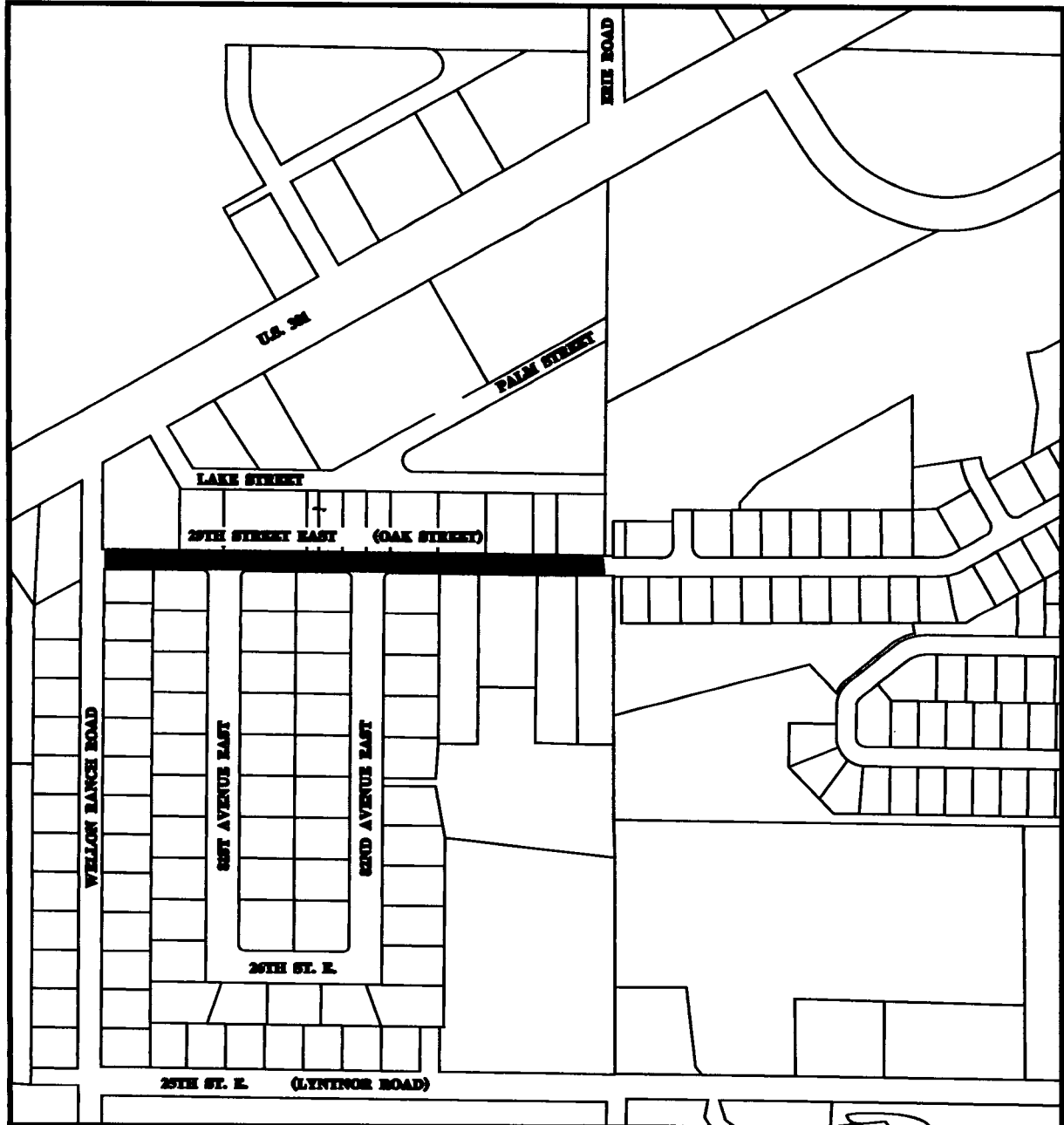

PREPARED BY: RECORDS 29TH_ST_E.DWG



**MANATEE COUNTY
PROJECT MANAGEMENT
DEPARTMENT**



LEGEND:

	AREA OF SEWER IMPROVEMENTS
--	----------------------------

COUNTY COMMISSIONER: AMY STEIN

BRADENTON HERALD

www.bradenton.com
 P.O. Box 921
 Bradenton, FL 34206-0921
 102 Manatee Avenue West
 Bradenton, FL 34205-8894
 941/748-0411 ext. 7065

Bradenton Herald
 Published Daily
 Bradenton, Manatee, Florida

STATE OF FLORIDA
 COUNTY OF MANATEE;

Before the undersigned authority personally appeared Sandy Riley, who on oath says that she is a Legal Advertising Representative of the Bradenton Herald, a daily newspaper published at Bradenton in Manatee County, Florida; that the attached copy of the advertisement, being a Legal Advertisement in the matter of **NOTICE OF PUBLIC HEARING R-02-177** in the Court, was published in said newspaper in the issues of, 7/31,'02

Affiant further says that the said publication is a newspaper published at Bradenton, in said Manatee County, Florida, and that the said newspaper has heretofore been continuously published in said Manatee County, Florida, each day and has been entered as second-class mail matter at the post office in Bradenton, in said Manatee County, Florida for a period of 1 year next preceding the first publication of the attached copy of advertisement; and affiant further says that she has neither paid nor promised any person, firm or corporation any discount, rebate, commission or refund for the purpose of securing this advertisement for publication in the said newspaper.

Sandy Riley
 (Signature of Affiant)

Sworn to and subscribed before me this
1st Day of August, 2002

DIANE S. BACRO
 Notary Public - State of Florida
 My Commission Expires Aug 15, 2003
 Commission # CC863180

Diane S. Bacro
 SEAL & Notary Public
 Personally Known OR Produced Identification
 Type of Identification Produced _____

NOTICE OF PUBLIC HEARING SPECIAL ASSESSMENTS FOR SEWER ASSESSMENT PROJECT NO. 02-177 29TH STREET EAST (ELLENTON)

NOTICE IS HEREBY GIVEN, pursuant to Section 197.3632, Florida Statutes, and Chapter 63-1582, Laws of Florida, as amended, that the Board of County Commissioners of Manatee County, Florida, will conduct a public hearing in the Chambers of the Board at Manatee County Administrative Complex, 1112 Manatee Avenue West, first floor, Bradenton, Florida, on the 20th day of August, 2002, at 9:00 a.m., or soon thereafter, to consider, act upon, adopt or reject the following Resolution.

RESOLUTION R-02-177

A RESOLUTION OF MANATEE COUNTY, FLORIDA ESTABLISHING SPECIAL ASSESSMENT LINES FOR SEWER ASSESSMENT PROJECT NO. 02-177

STREET EAST IN ELLENTON; CONFIRMING THE SPECIAL ASSESSMENT ROLL; AUTHORIZING AND PROVIDING FOR THE COLLECTION OF ASSESSMENTS BY THE TAX COLLECTOR IN ACCORDANCE WITH THE UNIFORM METHOD FOR THE LEVY, COLLECTION AND ENFORCEMENT OF NON-AD VALOREM ASSESSMENTS PURSUANT TO SECTION 197.3632, FLORIDA STATUTES; PROVIDING FOR THE CORRECTION OF ERRORS; AND PROVIDING AN EFFECTIVE DATE

The final special assessment roll showing the total costs and expenses of the project has been completed and is on file in the Office of the Clerk of the Circuit Court and the Project Management Department and is open for inspection.

Upon the adoption of the Resolution and subject to such adjustments as may be determined at the public hearing, you are hereby notified of the following:

1. The property that will be subject to the special assessments consists of those lots and parcels that abut 29th Street East in Ellenton described as follows:

FROM WELTON RANCH ROAD, EAST APPROXIMATELY 1,250 FEET TO PARKWOOD LAKES

2. The amount of revenues that will be collected from the special sewer assessments is \$ 68,000. The unit of measurement applied against each parcel to determine the assessment is \$ 3,000 per ERU subject to such adjustments to any affected property as may be required based upon the benefit provided to the property with the revenue generated by the assessments.

3. The assessments will be payable in fifteen (15) annual payments with interest at the rate of 7 1/2% per annum and will be collected by the Tax Collector in accordance with the provisions of Section 197.3632, Florida Statutes.

4. The failure to pay assessments will cause a tax certificate to be issued against the property which may result in a loss of title.

All affected property owners have the right to appear at the public hearing and the right to file written objections within twenty (20) days of the publication of the notice, addressed to Manatee County Project Management Department, 1026 26th Avenue East, Bradenton, Florida 34208.

According to Section 286.0105, Florida Statutes, if any person decides to appeal any decision made by the Board with respect to any matter to be considered at the meeting or hearing, he will need a record of the proceedings and for such purpose, he may need to insure that a verbatim record of the proceedings is made, which record would include any testimony or evidence upon which the appeal is to be based.

The Board of County Commissioners of Manatee County, Florida, does not discriminate upon the basis of any individual's disability status. This non-discrimination policy involves every aspect of the Board's functions including one's access to participation, employment, or treatment in its programs or activities. Anyone requiring reasonable accommodation for this meeting as provided for in the Americans with Disabilities Act, should contact Rita Dralus at 749-7100; TDD ONLY 749-7100 and wait 60 seconds; FAX 745-3790.

Rules of Procedure for this public hearing are in effect pursuant to R-94-90. Copies of this Resolution are available for review at the Citizens Action Center on the ninth floor of the County Administration Building, 1112 Manatee Avenue West, Bradenton, Florida and are available for purchase from the County Administrator's Office at cost.

Copies of the proposed Resolution and the preliminary special assessment rolls are available at the Manatee County Project Management Department, 1026 26th Avenue East, Bradenton, Florida 34208, during normal business hours. For additional information, you may call Tom Yarger, Project Manager at 708-7450, extension 7333. A reasonable charge may be made for the provision of copies. 7/31/02

BK 1765 PG 4473 FILED AND RECORDED 8/21/2002 1:47:21 PM 16 of 16 R.B. SHORE CLERK OF CIRCUIT COURT MANATEE COUNTY FL.