

RESOLUTION R-17- 005

A RESOLUTION OF THE BOARD OF COUNTY COMMISSIONERS OF MANATEE COUNTY, FLORIDA, DECLARING A PUBLIC HEARING TO CONSIDER AN APPLICATION TO VACATE CERTAIN STREETS, ROADS OR OTHER APPROPRIATE PROPERTY, SPECIFICALLY A PORTION OF 261ST STREET EAST PURSUANT TO SECTIONS 336.09, 336.10 AND 336.12, FLORIDA STATUTES, AND THE LAND DEVELOPMENT CODE, MANATEE COUNTY, FLORIDA.

WHEREAS, an application has been made and filed before the Board of County Commissioners of Manatee County, Florida, (Board) by Stephen P. Aron, a married person, Joseph J. Roman, an unmarried person, and John S. Schlabach, a married person (Applicants) to vacate certain streets, roads, or other appropriate property, specifically a portion the right-of-way of 261st Street East.

WHEREAS, the Applicants seek to vacate property located in an unincorporated area of Manatee County, Florida, and more particularly described in Exhibit A attached hereto and by this reference provided herein.

NOW THEREFORE, BE IT RESOLVED, by the Board that a public hearing will be held before the Board in the Commissioners' Chambers on the first floor of the Manatee County Administrative Center, 1112 Manatee Avenue West, Bradenton, Florida, at 9:00 a.m., or as soon thereafter as same may be heard, on the 7 day of February, 2017, to consider the advisability of granting said application, or some portion thereof. All interested persons, firms, corporations or other entities and organizations shall govern themselves accordingly.

In accordance with Section 286.0105, Florida Statutes, if any person decides to appeal a decision made with respect to any matter considered at this hearing, he or she will need a record of the proceedings and therefore, he or she may need to ensure that a verbatim record of the proceedings is made, including the testimony and evidence upon which the appeal is to be based.

Copies of this Resolution are available for review at the Citizens Action Center within the County Administrator's Office on the ninth floor of the Manatee County Administrative Center, 1112 Manatee Avenue West, Bradenton, Florida, and are available for purchase, at cost.

DULY ADOPTED with a quorum present and voting this 10 day of January, 2017.

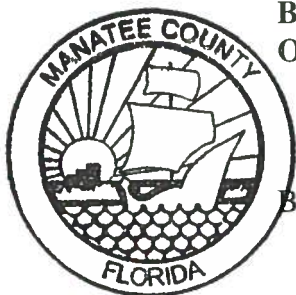

**BOARD OF COUNTY COMMISSIONERS
OF MANATEE COUNTY, FLORIDA**

By: _____

[Handwritten signature]
Chairperson

ATTEST: ANGELINA COLONNESO
CLERK OF THE CIRCUIT COURT AND COMPTROLLER

By: _____

[Handwritten signature]

Deputy Clerk

LEGAL DESCRIPTION:

SITUATED IN SECTION 35, TOWNSHIP 35 SOUTH, RANGE 20 EAST, MANATEE COUNTY, FLORIDA AND BEING A PORTION OF PUBLIC RIGHT-OF-WAY MORE PARTICULARLY DESCRIBED AS FOLLOWS:

COMMENCE AT THE NORTHEAST CORNER OF TRACT 49, IN SECTION 35, TOWNSHIP 35 SOUTH, RANGE 20 EAST, POMELLO PARK, A SUBDIVISION AS PER PLAT THEREOF RECORDED IN PLAT BOOK 6, PAGE 61, OF THE PUBLIC RECORDS OF MANATEE COUNTY, FLORIDA.

THENCE FROM SAID POINT OF COMMENCEMENT ALONG THE WESTERLY LINE OF AFORESAID TRACT 49, SAID LINE ALSO BEING THE EASTERLY RIGHT-OF-WAY LINE OF 261ST STREET EAST S00°38'53"W 370 FEET MORE OR LESS TO A POINT LYING 160 FEET SOUTH OF THE NORTH LINE OF THE LANDS OF ARON, SAID LANDS BEING DESCRIBED IN OFFICIAL RECORDS BOOK 2312, PAGE 4417, OF THE PUBLIC RECORDS OF MANATEE COUNTY, FLORIDA, AND THE POINT OF BEGINNING.

THENCE FROM SAID POINT OF BEGINNING, CONTINUE ALONG SAID RIGHT-OF-WAY LINE S00°38'53"W 476.86 FEET TO A POINT LYING 160 FEET NORTH OF THE SOUTH LINE OF THE LANDS OF SCHLABACH, SAID LANDS BEING DESCRIBED IN OFFICIAL RECORDS BOOK 2599, PAGE 81, OF THE PUBLIC RECORDS OF MANATEE COUNTY, FLORIDA. THENCE N89°04'24"W 50.00 FEET TO THE INTERSECTION WITH THE WESTERLY RIGHT-OF-WAY LINE OF 261ST STREET EAST; THENCE N00°38'53"E 476.86 FEET ALONG SAID WESTERLY RIGHT-OF-WAY LINE; THENCE S89°04'24"E 50.00 FEET TO THE POINT OF BEGINNING.

CONTAINING 0.547 ACRES (23,843 SQUARE FEET) MORE OR LESS.

LEGEND AND ABBREVIATIONS:

- (P) PLAT DIMENSION
- (M) MEASURED DIMENSION
- (D) DEED DIMENSION
- (C) CALCULATED DIMENSION
- O.R./PG. OFFICIAL RECORDS BOOK/PAGE
- D.B./PG. DEED BOOK/PAGE
- P.B./PG. PLAT BOOK/PAGE
- W.F. WIRE FENCE
- OUL OVERHEAD UTILITY LINE
- PT. PORTION OF (LOT/BLOCK)
- R/W RIGHT-OF-WAY
- SEC. SECTION
- TWP. TOWNSHIP
- RGE. RANGE
- IRON ROD (I.R.) OR IRON PIPE (I.P.) FOUND
- 5/8" I. ROD SET W/CAP PSM#6333

NOTE:

BEARINGS BASED ON THE EASTERLY RIGHT OF WAY OF 261ST STREET EAST HAVING A BEARING OF S00°38'53"W.

EXHIBIT "A"

J 12/22/2016

JAMES B. AMBERGER DATE
PROFESSIONAL SURVEYOR AND MAPPER
FLORIDA CERTIFICATE No. 6333

© 2016 Jim Amberger Land Surveying, LLC

**SKETCH OF DESCRIPTION
A PORTION OF 261ST STREET EAST
ROAD RIGHT-OF-WAY
SECTION 35, TOWNSHIP 35 SOUTH, RANGE 20 EAST,
MANATEE COUNTY, FLORIDA**

JIM AMBERGER
LAND SURVEYING, LLC
1055 South Tamiami Trail, Suite 110-B
Sarasota, FL 34236
Phone (941) 955-6333 bergertime@verizon.net
Surveying & Mapping Business Authorization #LB7649

SHEET 1 OF 2

REV. 10-24-2016
REV. 11-18-2016
REV. 12-21-2016

DATE: 3-14-2016
JOB # 2009071
DWG# B-09071
DRAWN BY: JBA

EXHIBIT "A"

261ST STREET EAST
 (50' PUBLIC RIGHT-OF-WAY)
 (OPEN TO PUBLIC HIGHWAYS)

POINT OF COMMENCEMENT
 NORTHEAST CORNER
 OF TRACT 49

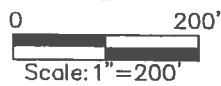
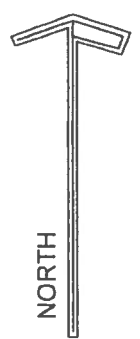

77TH AVENUE EAST
 (50' PUBLIC RIGHT-OF-WAY)
 (UNIMPROVED-NOT OPEN)

S89°04'24"E
 50.00'

TRACT 48
 POMELLO PARK
 P.B. 6, PG. 61

PORTION OF
 261ST STREET EAST
 RIGHT-OF-WAY
 (23,843 SQUARE FEET MORE OR LESS)

NORTH LINE OF
 LANDS OF ARON
 O.R. 2312, PG. 4417

PT. TRACT 49
 POMELLO PARK
 P.B. 6, PG. 61
 PROPERTY ID
 NOW OR FORMERLY
 # 335601869

370' ± 500'38'53"W

160.00'

S89°04'24"E

POINT OF BEGINNING

LANDS OF ARON
 O.R. 2312, PG. 4417

PT. TRACT 49
 POMELLO PARK
 P.B. 6, PG. 61
 PROPERTY ID
 NOW OR FORMERLY
 # 335601879

456.44'

PT. TRACTS 47 & 48
 POMELLO PARK
 P.B. 6, PG. 61
 PROPERTY ID
 NOW OR FORMERLY
 # 335601689

PT. TRACT 47
 POMELLO PARK
 P.B. 6, PG. 61

WESTERLY
 RIGHT OF WAY LINE OF
 261ST STREET EAST

N00°38'53"E

S00°38'53"W

EASTERLY
 RIGHT OF WAY LINE OF
 261ST STREET EAST

LANDS OF SCHLABACH
 O.R. 2599, PG. 81

PT. TRACT 50
 POMELLO PARK
 P.B. 6, PG. 61
 PROPERTY ID
 NOW OR FORMERLY
 # 335602159

333.50'

N89°04'24"W
 50.00'

N89°04'24"W

160.00'

SOUTH LINE OF
 LANDS OF SCHLABACH
 O.R. 2599, PG. 81

PT. TRACT 50
 POMELLO PARK
 P.B. 6, PG. 61
 PROPERTY ID
 NOW OR FORMERLY
 # 335601869

PT. TRACT 47
 POMELLO PARK
 P.B. 6, PG. 61
 PROPERTY ID
 NOW OR FORMERLY
 # 335601699

476.86'

476.86'

NOTE:
 SKETCH OF DESCRIPTION ONLY
 NOT A BOUNDARY SURVEY
 SEE ATTACHED PAGE 1
 FOR LEGAL DESCRIPTION

J 12/22/2016
 JAMES B. AMBERGER DATE
 PROFESSIONAL SURVEYOR AND MAPPER
 FLORIDA CERTIFICATE No. 6333

© 2016 Jim Amberger Land Surveying, LLC

SKETCH OF DESCRIPTION
 A PORTION OF 261ST STREET EAST
 ROAD RIGHT-OF-WAY
 SECTION 35, TOWNSHIP 35 SOUTH, RANGE 20 EAST,
 MANATEE COUNTY, FLORIDA

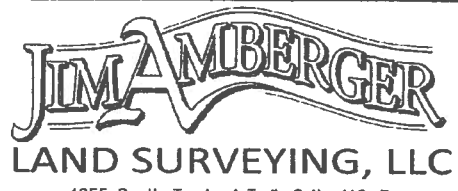

1055 South Tamiami Trail, Suite 110-B
 Sarasota, FL 34236
 Phone (941) 955-6333 bergertime@verizon.net
 Surveying & Mapping Business Authorization #B7649

SHEET 2 OF 2

REV. 10-24-2016
 REV. 11-18-2016
 REV. 12-21-2016

DATE: 3-14-2016
 JOB # 2009071
 DWG# B-09071
 DRAWN BY: JBA