

**MANATEE COUNTY ORDINANCE NO.
PDMU-05-19(G)(R7)
NORTHWEST SECTOR**

AN ORDINANCE OF MANATEE COUNTY, FLORIDA, REGARDING LAND DEVELOPMENT AMENDING AND RESTATING ORDINANCE PDMU-05-19 (G)(R4) AS AMENDED BY PDMU-05-19(G)(R5) and PDMU-05-19(G)(R6) TO AMEND THE GENERAL DEVELOPMENT PLAN TO EXCHANGE 239 SINGLE FAMILY UNITS FOR 339 MULTI-FAMILY UNITS IN ACCORDANCE WITH THE APPROVED LAND USE EXCHANGE MECHANISM; REALLOCATE UNITS BETWEEN PARCELS J AND I; MODIFY DESIGN CONDITIONS; ALLOW THE TRANSFER OF MULTI-FAMILY AND SINGLE FAMILY BETWEEN ADDITIONAL PARCELS MODIFY DIMENSIONAL CRITERIA, ALLOW DESIGN FLEXIBILITY BY REVISING RESTRICTIONS ON LAND USES AND DESIGN CRITERIA, AMEND STIPULATIONS TO FACILITATE THESE CHANGES, AND UPDATE THE PHASING TABLE TO REFLECT LEGISLATIVELY APPROVED EXTENSIONS; MODIFY CERTAIN CONDITIONS CONSISTENT WITH CURRENT DEPARTMENTAL PRACTICES AND OTHER AMENDMENTS FOR INTERNAL CONSISTENCY. PROVIDING FOR DEFINITIONS; PROVIDING FOR FINDINGS OF FACT; PROVIDING A LEGAL DESCRIPTION; PROVIDING FOR SEVERABILITY; AND PROVIDING AN EFFECTIVE DATE.

DEPARTMENT OF STATE
TALLAHASSEE, FLORIDA

2013 AUG 14 PM 1:01

FILED

BE IT ORDAINED BY THE BOARD OF COUNTY COMMISSIONERS OF MANATEE COUNTY, FLORIDA:

SECTION 1. AMENDMENT AND RESTATEMENT OF ORDINANCE NO. PDMU-05-19(G)(R4) Ordinance PDMU-05-19(G)(R4) (as amended by PDMU-05-19(G)(R5) and PDMU-05-19(G)(R6)) ~~are~~is hereby amended and restated in its entirety below. All prior zoning ordinances (and any site plans approved pursuant thereto) shall be superseded by this ordinance. Any extensions, or rights to extensions, granted by the State Legislature pursuant to general law, or by Manatee County, to any dates contained herein are not intended to be changed or rescinded by the passage of this amended and restated ordinance.

SECTION 2 DEFINITIONS. All capitalized terms used herein shall have the meanings set forth in the Northwest Sector DRI Ordinance 13-24, Section 380.06 F.S., the Manatee County Comprehensive Plan, or the Manatee County Land Development Code, in that order of precedence.

SECTION 3. FINDINGS OF FACT. The Board of County Commissioners (BOCC) of Manatee County, after considering the testimony, evidence, documentation, application for

amendment to the Zoning Ordinance, the recommendation and findings of the Planning Commission, and all other matters presented to the Board at the public hearing hereinafter referenced, hereby makes the following findings of fact:

- A. The BOCC received and considered the report of the Manatee County Planning Commission concerning the application to amend the General Development Plan and Zoning Ordinance to exchange 239 single family units for 339 multi-family units in accordance with the approved land use exchange mechanism, reallocate units between parcels J and I, modify design conditions, allow the transfer of multi-family and single family between additional parcels, modify dimensional criteria, allow design flexibility by revising restrictions on land uses and design criteria, amend stipulations to facilitate these changes, and update the phasing table to reflect legislatively approved extensions.
- B. The Planning Commission has held a duly noticed public hearing on July 11, 2013 and found the Zoning Ordinance and the General Development Plan consistent with the 2020 Manatee County Comprehensive Plan (Ordinance 89-01, as amended) and recommended adoption of the Zoning Ordinance and approval of the General Development Plan. The BOCC held a public hearing on August 6, 2013 regarding the proposed General Development Plan described herein in accordance with the requirements of the Manatee County Land Development Code (Ordinance No. 90-01) and regarding the proposed amendment to the zoning ordinance as listed below, and further considered the information received at the public hearing.
- C. The proposed amended and restated Zoning Ordinance and General Development Plan regarding the property described in Section 5 herein is found to be consistent with the requirements of the 2020 Manatee County Comprehensive Plan (Ordinance No. 89-01), as amended.

SECTION 4. GENERAL DEVELOPMENT PLAN

The General Development Plan is hereby APPROVED to allow a maximum of 4,522 residences, 200,000 square feet of commercial space, 105,000 square feet of office space, and a 120 bed group care facility, with the following stipulations:

A. DEVELOPMENT APPROVAL

- A(1). This Zoning Ordinance shall constitute approval of the revised General Development Plan subject to the conditions set forth herein and limited to the development amounts set forth in Table 1, below.

TABLE 1 - DEVELOPMENT TOTALS			
TYPE OF DEVELOPMENT: Multi-Use Development.			
Land Use	PHASE I 2007-2022¹	PHASE II 2009-2026¹	TOTAL
Commercial	200,000 s.f.	0	200,000 s.f.

Office	105,000 s.f.	0	105,000 s.f.
Residential ²			
Single-family	2,411 units	1,422 units	3,833 units
Multi-family	689 units	0	689 units
Total Residential Units	3,100 units	1,422 units	4,522 units
Recreation (Golf Course)	18 holes	0	18 holes

¹ March 22nd of referenced year which includes legislatively approved extensions (SB 360 and SB 1752) for Phase I and (HB 7207 and F.S. 252.363) for Phases I and II.

² Includes the option for a group care facility as part of a land use exchange. The Land Use Equivalency Matrix allows the exchange of other approved land uses (single-family detached, multi-family, commercial, and office space) for Group Care Facility (a.k.a. Assisted Living Facility) beds.

- A(2). For Phase I, the Developer has demonstrated the availability of adequate infrastructure and the ability to meet Acceptable Levels of Service for roadways, mass transit, drainage, and parks and recreation. The Certificate of Level of Service for Phase I shall be valid until March 22, 2026, or as may be extended pursuant to the terms of the Northwest Sector/Lakewood Centre Local Development Agreement (LDA-10-01), subject to limitations set forth in stipulation B(3):
- A(3). The Project site may continue to be used for agricultural activities, but at no greater intensity than at present. No silvacultural or agricultural activities shall be initiated on land not currently under such use.
- A(4). Preliminary and Final Site Plan Applications shall be reviewed for compliance with this Zoning Ordinance and shall be subject to the requirements of the Manatee County Comprehensive Plan and Land Development Code in effect at the time of such site plan application which are not specifically addressed in this Zoning Ordinance or are not inconsistent with this Zoning Ordinance.

B TRANSPORTATION

B(1).The following roadway links are determined to be required link improvements for Phase I of the Project due to the percentage of Project traffic impacting the roadway and the resulting Level of Service (LOS).
(Phase 1 Mitigation Measures shall be completed Pursuant to LDA-10-01)

**TABLE 2
PHASE I LINK IMPROVEMENTS**

ROADWAY SEGMENTS

Link	From/To	Improvement	External Trip Threshold*	ERUs
SR 64	39th St/Morgan Johnson Road	6-lanes	1,881	2,266
SR 64	Lena Rd/Lakewood Ranch Blvd	6-lanes	514	619
SR 70	Tara Blvd/I-75 West	6 lanes with continuous East & West right turn or drop lanes	1,822	2,195
Lakewood Ranch Blvd	SR64/Center Ice Pkwy	4-lanes	1,148	1,383

* Threshold volume is based upon the number of net external trips at which Project traffic becomes significant (at least 5%) on the affected roadway segment.

B(2). The following intersection improvements are determined to be required intersection improvements for the Project due to the percentage of development traffic impacting the intersection and the resulting Level of Service (LOS). **(Phase 1 Mitigation Measures shall be completed Pursuant to LDA-10-01)**

**TABLE 3
PHASE I INTERSECTION IMPROVEMENTS**

INTERSECTIONS

Roadway	Intersection	Improvement	External Trip Threshold	ERUs
SR 70	US 301	Add 2 nd EBL and one Thru lane to all approaches	2,610	3,144
SR 70	45th St E	Add SBR, 2 nd NBL, and 2 nd WBL	1,041	1,254
SR 70	Caruso Road	Add NB Left	2,577	3,104
SR 70	Tara Blvd	Add WB Thru Lane to result in 8 thru lanes	2,159	2,601
SR 70	I-75 West	Add EB Thru Lane to result in 8 thru lanes	2,257	2,719
SR 70	Pope Road	Signalize When Warranted	N/A	
SR 70	87 th St E	Add EB & WB Thru Lanes	2,083	2,509
SR 64	Morgan Johnson Road	Add EB and WB Thru Lane to result in 6 thru lanes	2,126	2,561
SR 64	27th St	NBL	3,041	3,663
SR 64	I-75 East	Add 2 nd EBL and NB receiving lane	1,603	1,931

Roadway	Intersection	Improvement	External Trip Threshold	ERUs
SR 64	Lakewood Ranch Blvd	Add 2nd EBL, 2nd WBL, and 2nd NBL and Add one Thru lane to NB approach, Add NB and SB Receiving lanes	164	197
SR 64	Rye Road	Add SBR and Signalize	733	883
Lakewood Ranch Blvd	44th Avenue E.	Signalize When Warranted	N/A	
Lakewood Ranch Blvd	Malachite Drive	Signalize When Warranted	N/A	
University Parkway	Honore Avenue	Add 2nd WBL	1,439	1,733
University Parkway	I-75 East	Add 3rd NBL	2,388	2,877
University Parkway	Market Street	Add 2nd NBL	2,093	2,521
Lorraine Road	SR 64	Add a NBL and Signalize	1,714	2,065

NB means northbound, WB means westbound, SB means southbound, and EB means eastbound.

B(3). The improvements listed above are triggered by stated 'External Trip Thresholds' based upon the traffic study submitted in the record in support of this ordinance. At present, the County has funded and scheduled construction for the improvements to SR 64 from Lena Road to Lakewood Ranch Boulevard and including the intersection referenced above, which will provide sufficient transportation infrastructure to support the development up to the threshold triggering additional improvements ("post-SR 64 threshold"). Accordingly, development that does not trigger a post-SR 64 threshold may be permitted at the time of adoption of this development order subject to the requirements of stipulation B(221) and the conditions set forth in the CLOS to be issued pursuant to the County's Comprehensive Plan and LDC.

The Developer and the County have entered into discussions to work out a broader solution to the transportation concurrency needs in the area, which may require changes to the list of improvements set forth above and agreed-upon mechanisms for the financing and construction of such improvements. In order to satisfy the concurrency requirements of the County's Comprehensive Plan, no development that triggers a post-SR 64 threshold shall be permitted unless and until the County and Developer have, in the context of such discussions, determined the improvements necessary to support such development (which may reflect changes to the above list of required improvements), and the method of financing and constructing such improvements. Such required improvements, and the mechanisms for financing and constructing them, shall be established pursuant to a Local Development Agreement or other appropriate instrument, an amendment to this ordinance, or through the scheduling and funding of such improvements by the County in accordance with applicable law, and may include mitigation of transportation impacts through an agreement for proportionate fair-share mitigation

pursuant to Section 511 of the Land Development Code. **(Phase 1 Mitigation Measures shall be completed Pursuant to LDA-10-01)**

- B(4). In the event that Funding Commitments for transportation improvements are only adequate to permit approval of a portion (subphase) of the development, the capacity and loading of transportation facilities in the Transportation Impact Area, shall be limiting factors in any subsequent approvals. A subphase analysis has been performed, and cumulative subphases have been identified in Transportation Conditions Tables 2 and 3. An initial subphase of 768 external pm peak hour trips has been identified as requiring no transportation improvements.

The Developer shall be bound by the external trip thresholds set forth in Tables 2 and 3, unless the Developer files a Notice of Proposed Change application and provides the County, an updated traffic analysis for the Transportation Impact Area taking into account previously permitted development in the Project plus that to be generated by the next subphase. Copies of this transportation analysis shall be submitted to Manatee County and TBRPC for review and comment. Each updated traffic analysis shall serve to verify the findings of the initial DRI traffic analysis or shall indicate alternate transportation improvements or mechanisms which, when implemented, will maintain the roadways and intersections referenced in Tables 2 and 3 at the appropriate Level of Service. In the event that a new analysis demonstrates the need for alternate improvements or different trip trigger thresholds, the Zoning Ordinance shall be amended to reflect the revised thresholds or improvements. **(Phase 1 Mitigation Measures shall be completed Pursuant to LDA-10-01)**

- B(5). With each Final Site Plan application, the Developer shall submit to the County a limited traffic study which shows the following:

1. External P.M. peak hour trips predicted to be generated by the subphase, plus all previously approved subphases, to demonstrate whether any improvement thresholds reported in Table 2 or Table 3 are reached; and,
2. An assessment of the estimated traffic operations and turning with the conceptual design of the driveways serving the Project covered by the Final Site Plan application.

In the event that that total external p.m. peak hour trips projected to be generated exceeds the threshold levels identified in Tables 2 and 3, and the corresponding Funding Commitments have not been provided, no further Final Site Plan approvals shall be granted unless the Developer prepares an analysis which identifies the revised total external p.m. peak hour trips after which the road improvement would be required under the new subphase analysis. The Zoning Ordinance shall be amended to reflect these revised trip levels. **(Phase 1 Mitigation Measures shall be completed Pursuant to LDA-10-01)**

- B(6). All improvements to state roadways will require FDOT approval and all improvements to County roads will require Manatee County Public Works Department approval.
- B(7). Access to and from the site shall be in accordance with state and local access regulations and as generally shown on the General Development Plan (GDP).
- B(8). Prior to or concurrent with each Final Plat approval, right-of-way for the adjacent roadways, as shown on the General Development Plan, shall be dedicated. This dedication shall be eligible for impact fee credits to the extent allowed by Section 806 of the Manatee County Land Development Code and applicable law.
- B(9). Thoroughfare roads that abut this site shall be constructed or a bond posted subject to the approval as to form by the County Attorney, at the cost of the Developer or other appropriate entity, prior to approval of development that has access on that roadway, as such development is generally shown on the GDP subject to timing changes that may be revised as a result of the broader solution set forth in Stipulation B(3). At a minimum, deadlines for completion (or the posting of a bond) of these roads and Malachite Drive shall be as follows:
- a. 44th Avenue
 - 1. From Lakewood Ranch Boulevard to Pope Road, prior to the first Certificate of Occupancy or Temporary Certificate of Occupancy for the commercial parcel at Pope Road and 44th Avenue, or the first Final Plat approval in Parcel G-1, whichever occurs first. **(Completed)**
 - 2. From Lakewood Ranch Boulevard to Lorraine Road, prior to the first Final Plat approval in Parcel G-3.
 - b. Pope Road
 - 1. From 44th Avenue to the northern terminus of Pope Road, prior to the first Certificate of Occupancy or Temporary Certificate of Occupancy for the commercial parcel at Pope Road and 44th Avenue, or the first Final Plat approval in Parcel G-2, whichever occurs first.
 - 2. From its northern terminus to Malachite Drive, prior to the first Final Plat approval in Parcel G-4. **(Completed)**
 - c. Center Ice Parkway

From Pope Road to the eastern most access into Parcels G-7 or G-9, prior to the first Final Plat approval in Parcels G-7 or G-9. If the right-of-way for Center Ice Parkway has been acquired to Lorraine Road, the Developer shall construct the road to Lorraine Road.
 - d. Malachite Drive

From Lakewood Ranch Boulevard to Pope Road, prior to the first Certificate of Occupancy or Temporary Certificate of Occupancy for the commercial parcel at Pope Road and 44th Avenue, or first Final Plat approval in Parcels G-2 or G-4, whichever occurs first.
(Completed)

All roads shall be constructed with the outside 2 lanes of a 4 lane divided design, including sidewalks, bike lanes, appropriate intersection improvements, and associated stormwater facilities.

This construction shall be eligible for impact fee credits to the extent allowed by Section 806 of the Manatee County Land Development Code and applicable law.
(Phase 1 Mitigation Measures shall be completed Pursuant to LDA-10-01)

- B(10). Beginning one year after the first Final Plat or Certificate of Occupancy has been issued, an annual monitoring program to provide peak hour counts at the Project entrances shall be instituted to verify that external trip improvement thresholds specified in Tables 2 and 3 for Phase I of the Project are not exceeded. Counts shall continue on an annual basis through buildout of Phase I. The methodology for the annual monitoring program shall be approved by staff.
- B(11). Prior to development of Phase II, a revised transportation analysis shall be submitted, pursuant to Section 380.06(6), Florida Statutes. This analysis shall address potential transportation impacts which might result from the development of this phase.
- B(12). Bicycle and pedestrian facilities shall be constructed on both sides of any road designated as a collector or higher, in accordance with the LDC. All bike lanes shall be constructed in accordance with Manatee County standards.
- B(13). The Developer shall provide sidewalks along both sides of all streets throughout the Project.
- B(14). The Developer shall provide roadways and pedestrian connections to perimeter roads, schools, and parks, as determined at time of Preliminary Site Plan approval.
- B(15). The Developer shall work with Manatee County Area Transit (MCAT) on identifying a potential transit stop(s) within the Project. At such time that MCAT has established a plan for service to the Project and coordinated needed location(s) for a transit stop with Developer, the Developer shall accommodate the requisite stop(s) within the Project.
- B(16). The Developer shall grant to the appropriate agency or agencies, a non-ingress/egress easement prohibiting vehicular access to and from the development via SR 70, Lakewood Ranch Boulevard, 44th Avenue, Center Ice Parkway, Lorraine Road, and Pope Road, except as shown on the General Development Plan for permitted road and driveway crossings.

- B(17). Center Ice Parkway is planned as a Collector Roadway to be extended to Lorraine Road and beyond to the east. The exact alignment has not yet been determined. Therefore, no PSP may be approved for any development in those portions of Parcels G-5, G-6, G-7, G-9, H, or I set forth on Exhibit 3 identified as "Potential Center Ice Parkway Right of Way" until Manatee County has completed a Corridor Route Study for the extension of Center Ice Parkway. Manatee County has estimated that it will complete the corridor study no later than May 31, 2008. In the event Manatee County does not complete the Corridor Study by May 31, 2008 Manatee County shall retain full authority to review and take action on the above-described PSP. The Lakewood Ranch Stewardship District, at its option, may conduct the Corridor Route Study. If this option is exercised, the Lakewood Ranch Stewardship District shall submit the completed study for the County to review at least 30 days prior to the May 31, 2008 deadline. **(Completed)**

The Developer shall be responsible for the construction of Center Ice Parkway to the eastern property line and the County shall be responsible beyond the property line, which may be constructed by the Developer pursuant to a reimbursement agreement.

- B(18). Prior to or concurrent with each Final Plat approval abutting perimeter roads, right-of-way for adjacent perimeter roadways as shown on the Preliminary and Final Site Plans shall be dedicated.
- B(19). The developer shall dedicate sufficient right-of-way at all roadway intersections to accommodate the future buildout design for each intersection. This shall be determined and shown on all Preliminary and Final Site Plans.
- B(20). Manatee County is in the process of developing performance standards to mitigate the noise generated along multi-lane thoroughfares. If such standards are adopted by the Board of County Commissioners prior to the submission of the first Preliminary Site Plan or Final Site Plan with proposed residences adjacent to a planned multi-lane thoroughfare, that and all other subsequent Preliminary Site Plans and Final Site Plan shall comply with those adopted standards.

If Manatee County has not adopted performance standards to mitigate the noise generated along multi-lane thoroughfare have not been adopted prior to the submission of the first Preliminary Site plan or Final Site Plan with proposed residences adjacent to a planned multi-lane thoroughfare, the developer shall prepare for staff review and approval a noise mitigation plan for mitigation of noise from thoroughfare roads. The noise mitigation plan shall apply to the entire Project. The analysis contained in the noise mitigation plan shall be based on projected 2025 traffic volumes. Thoroughfare noise mitigation measures in each Preliminary Site Plan and Final Site Plan shall be consistent with the approved noise mitigation plan.

- B(21) At the time of Preliminary Site Plan, Final Site Plan, and Construction Plan approval for each phase of the project the developer shall be responsible for any additional on-site or off-site transportation operational and safety improvements attributable to this project, as determined by the Public Works Department, and in accordance

with LDC Section 722.1.3.4., as well as any capacity improvements associated with the issuance of a Certificate of Level of Service.

C. WETLANDS

- C(1). All wetlands defined as "Preservation or Conservation Areas" by TBRPC (as shown on the General Development Plan (Exhibit 1) shall be preserved or conserved, respectively, except as shown on the GDP and as indicated in Condition C(3). The Developer shall not conduct dredging, filling, or any development activity within those Preservation or Conservation Areas, except as shown on the GDP and as indicated in Condition C(3).
- C(2). Except for wetland restoration and enhancement and naturally occurring fluctuations, no hydroperiod alteration shall be permitted in Preservation Areas. Natural annual hydroperiods, normal pool elevations, and seasonal high water elevations shall be substantially maintained or improved.
- C(3). Any allowable wetland losses shall require compensation in accordance with the Manatee County Land Development Code (LDC Section 719), as specified in permits issued under 40D-4 FAC or under 62-340, FAC, as appropriate. Mitigation for wetland losses shall be implemented prior to, or concurrent with, the wetlands being disturbed. Mitigation may be provided by withdrawal of available mitigation credits from the Long Swamp Ecosystem Management Plan, if approved by appropriate agencies. Any on-site wetland compensation areas shall require monitoring and maintenance activities. Percent coverage of desirable plant species in the on-site created wetlands and enhanced wetlands shall meet or exceed eighty-five percent (85%) for at least two (2) years for herbaceous wetland systems and for at least five (5) years for forested wetlands. Yearly replanting and maintenance of the mitigation areas shall be required, if necessary, to ensure compliance with the conditions of the Zoning Ordinance.
- C(4). The Developer shall provide natural buffering around all post-development wetlands to provide an upland transition into the wetland areas and to protect natural systems from development impact. All buffers, buffer restoration, and setbacks shall be in compliance with the Manatee County Land Development Code.
- C(5). A Conservation Easement for the areas defined as post-development jurisdictional wetlands, wetland buffers, and upland preservation areas shall be dedicated to Manatee County, prior to or concurrently with Final Plat approval (or 1st C.O. if platting is not required).
- C(6). The developer shall provide signs adjacent to wetland buffers and conservation easements indicating that the area is a "Conservation Area", as required pursuant to Section 719.11.1.3.3 of the LDC. The type and location of such signs shall be shown and approved by the Building and Development Services Department with the Final Site Plan.
- C(7). No lot shall be platted through a wetland, stormwater pond, or wetland buffer.

- C(8). The developer shall be responsible for providing mitigation for impacts to Wetland 41 associated with the widening of Lakewood Ranch Boulevard. The amount of mitigation required for the proposed wetland impacts will be determined and approved by SWFWMD with the issuance of the Environmental Resource Permit.
- C(9). The developer shall provide a copy of the Environmental Resource Permit approved by SWFWMD to the Environmental Planning Division of the Building and Development Services Department prior to commencement of construction.

D. VEGETATION AND WILDLIFE

- D(1). An Exotic Plant Species Management Plan shall be submitted for review and approval prior to or concurrent with Final Site Plan or Construction Plan approval for each development pod. The management plan shall provide for the continued, phased, removal of nuisance, exotic plant species that become reestablished within common areas of a residential development and open spaces within non-residential projects, for the life of the project. Removal of all exotic nuisance plant species from upland portions of the site shall be completed prior to the first Final Plat approval, in accordance with Section 715.4 of the LDC.
- D(2). The following Pine Mesic Oak (414) and Pine Flatwood (411) Communities shall be preserved, as indicated on the GDP, and further stipulated:

FLUCF CS Code	Pre- Constructio n	Post-Construction		Habitat (w/in Wetland Buffers)		Habitat (w/in Upland Conservation)	
	Acreage	Acreage	Percentage (of habitat remaining)	Acreage	Percentage (of habitat w/in buffers)	Acreage	Percentage (of habitat w/in conservation)
411	117.8	21.7	18.4%	12.4	22.8%	7.0	14.5%
414	59.9	31.7	52.9%	12.9	23.7%	16.0	29.4%
Total	177.7	53.4	30.1%	25.3	47.4%	23.9	44.8%

Area	411	414	Total
Wetland Buffers	12.4	12.9	25.3
Perimeter Buffers	1.4	2.8	4.2
Upland Preservation Areas	7.9	16.0	23.9
Total	21.7	31.7	53.4

The preservation areas shall be clearly delineated, labeled and quantified on the Preliminary Site Plan. Upland Preservation Areas may be reconfigured, subject to Planning Director approval, with the Preliminary Site Plan provided that the overall acreage, general location, and quality of preserved habitat remain consistent with those shown on the approved GDP. Limited impacts may be permitted for suitable recreational areas (passive parks, pocket parks, etc.) Recreation improvements shall be designed in a manner that minimizes impacts to mature trees, dense tree clusters or significant vegetation.

- D(3). Unless otherwise approved by the Building and Development Services Department, native or drought tolerant landscape materials shall be utilized. The developer and

future owners of the site shall be required to participate in the Florida Yards and Neighborhood Program.

- D(4). The developer shall provide an updated study, consistent with Policy 3.3.2.3 of the Comprehensive Plan, for threatened and endangered plant and animal species prior to each Final Site Plan approval. A Management Plan, approved by the appropriate State or Federal agency, shall be provided to the Building and Development Services Department for any listed species found on-site, prior to Final Site Plan approval.
- D(5). Final Site Plans within management guideline distances (as prescribed by US Fish and Wildlife Service) of the bald eagle nest shall be designed in accordance with the current Habitat Management Guidelines for the Bald Eagle or a Habitat Management Plan for Bald Eagles, approved by the U.S. Fish and Wildlife Service.
- D(6). In the event that any state- or federally-listed species are discovered breeding on-site during project development, the Developer shall immediately notify the Florida Fish and Wildlife Conservation Commission and implement the recommended measures for species protection.
- D(7). Appropriate wildlife passageways shall be incorporated into the roadways designed to cross the Wolf Slough corridor, if practical and approved by appropriate state, regional, and local agencies.
- D(8). Tree Protection Measures:

Prior to construction, grading, or tree removal from the site, required protective barriers within each area of construction shall be installed to protect all 4" DBH (trunk diameter measured at 4.5 feet from the ground) and greater trees identified for protection, that is, not shown on the Preliminary Site Plan as proposed to be removed, replaced, or relocated. Specific tree protective measures shall be approved by the Building and Development Services Department with the Final Site Plan and Construction Plan submittal. Tree barricades for trees to be preserved shall be located at the drip line, unless otherwise approved by the Building and Development Services Department. The drip line shall be defined as the outer branch edge of the tree canopy. The area within the drip line shall remain undisturbed unless specifically approved and shall be clearly shown on the Final Site Plan. The following activities are prohibited within the drip line of preserved trees unless otherwise approved by the Building and Development Services Department: machinery and vehicle travel or parking; underground utilities; filling or excavation; storage of construction materials. The tree protection barricades shall consist of chain link fence (new or used) with a minimum 5' height, unless otherwise approved by Building and Development Services Department.

The Final Site Plan shall include details and locations of signs (in both English and Spanish) to alert workers of tree and native vegetation protection areas. These signs shall be constructed of weather resistant materials and shall demarcate the boundaries of the protected areas.

E. LAND

- E(1). The Developer shall limit site work and construction to areas needed for immediate development or stockpiling, if shown on the Final Site Plan.
- E(2). An integrated Pest Management Plan (IPM) for the application of fertilizers, pesticides, and herbicides shall be submitted to the Building and Development Services Department for review and approval prior to Final Site Plan approval. Where practical, native or drought tolerant landscape materials shall be utilized in common areas. **(Completed)**
- E(3). A Construction Water Quality Monitoring Program and proposed sampling locations shall be submitted to the Natural Resources Department (NRD) for review and approval prior to any land clearing activities, or Final Site Plan approval, whichever occurs first. **(Completed)**
- E(4). The entire site shall be evaluated for potential hazardous material locations (i.e., historical cattle dipping vats, underground/aboveground storage tanks, or buried drums), by a qualified environmental consultant. Should evidence of contamination be discovered, further investigation will be required to determine the level of contamination and appropriate remediation/mitigative measures.
- E(5). A Well Management Plan for the proper rehabilitation or abandonment of existing wells shall be submitted to the Building and Development Services Department for review and approval prior to Final Site Plan approval. **(Completed)**

F. AIR QUALITY

- F(1). The Developer shall institute the following procedures to ensure dust control during development of the Project:
 - a. Implement a watering program during excavation, and dredge and fill operations;
 - b. Apply water or chemical stabilization to dirt roads and heavily traveled primary haul route sections as necessary;
 - c. Treat disturbed areas after clearing, grading, earth moving, or excavation is completed by watering, revegetation, spreading soil binders, or compacting fill material until areas are paved or developed;
 - d. Keep soil stockpiles moist, or treat with soil binders or cover;
 - e. Suspend dust producing activities during gusting or constant wind conditions of 39 mph or more;
 - f. Remove dust producing materials as soon as possible; and

g. Clean (sweep) paved roads adjacent to site as necessary;

- F(2). Prior to development of Phase II, air quality impacts must be analyzed as required by Section 380.06, Florida Statutes. If mitigation is required based upon this analysis, the Development Order must be amended to incorporate those mitigative measures.
- F(3). If burning of trees or branches is required for land clearing, a burn permit must be first obtained from the Environmental Management Department. No burn permits will be issued until Final Site Plans and Construction Plans are approved.

G. WATER QUALITY AND DRAINAGE

- G(1). The stormwater management systems shall be designed, constructed, and maintained to meet or exceed Chapter 62-25, Florida Administrative Code, and 40D-4, Rules of SWFWMD, the County and Building and Development Services Department, whichever is more stringent; to provide retention, or detention with filtration/assimilation treatment, pursuant to SWFWMD and County approved methods, during the 25-year, 24-hour design storm; and such that maximum post-development flow rates do not exceed pre-development flow rated for the same design storm. Nothing in this paragraph shall be construed as a waiver by the Developer of any vested rights, if any, pertaining to approved and constructed stormwater drainage facilities. With the exception of any such vested rights, if any, any valid requirements of general law pertaining to retrofitting which shall apply to landowners in Manatee County, however, shall apply to the Developer.
- G(2). Best Management Practices (BMP) for reducing water quality impacts, as recommended by the County and SWFWMD in accordance with adopted regulations of these agencies, shall be implemented. Low Impact Development techniques shall be used, where feasible.
- G(3). The Developer shall be the entity responsible for maintaining the stormwater management system. The Developer's obligations may be assumed by an appropriate agency, Community Development District, or Lakewood Ranch Stewardship District.
- G(4). Stormwater management system design shall, to the maximum extent possible, incorporate and utilize isolated wetlands.
- G(5). The applicant submitted an Ambient Surface Water Quality Monitoring Report to Manatee County in November 2004. The report contained the surface water quality data representing the site specific ambient conditions to meet the one year pre-construction monitoring requirement, as specified in the "Ambient Surface Water Monitoring for Developments" Guidance document. On April 5, 2005, the Ambient Surface Water Quality Monitoring requirement was considered satisfied by the County.
- G(6). Within one year of initiating vertical construction, the Developer shall submit the results of surface water quality monitoring to Manatee County for review. The Plan

shall be reviewed by Manatee County for consistency with the County's "Ambient Surface Water Monitoring for Developments" (Guidance) document. **(Completed)**

- A. The results of the monitoring shall be submitted to the County with each DRI Biennial Report and shall include an official laboratory report.
 - B. The Developer will incorporate additional water quality treatment or water management methods into the project's surface water drainage system to correct or mitigate any degradation if the measures implemented by the Developer are found to be ineffective or adversely impact water quality downstream of the project site.
 - C. Any violation of Rule 62-302, Florida Administrative Code, determined to be caused by this development, shall require corrective measures, as set forth by the DEP and shall be reported to the County and all work which is determined by the County to be contributing to the problem will be halted until the problem is resolved.
- G(7). The applicant submitted a Groundwater Quality Monitoring Plan on February 15, 2006, to monitor for ambient (pre-development) and construction water quality conditions, as specified above. On February 21, 2006 the Groundwater Quality Monitoring Plan was approved by the County.
- G(8). Water quality samples shall be collected and analyzed in accordance with Manatee County's Guidance document, referenced above and the Northwest Sector DRI Site's Groundwater Quality Monitoring Plan, dated February 15, 2006. If any of the parameters are above the proposed, current, or final maximum contamination levels (MCL's) or MCL goal, the County and DEP will be properly notified for further action. The results of the groundwater quality monitoring shall be submitted to the County for review with the DRI biennial report and shall include an official laboratory report.
- G(9). Stormwater treatment by biological filtration shall be provided where required and shall be encouraged wherever appropriate and feasible. Percolation treatment and underdrain effluent treatments may be utilized where consistent with applicable law.
- G(10). To the extent required by applicable law, on site stormwater wet detention lakes shall include littoral zones constructed on slopes no steeper than a 4:1 horizontal to vertical ratio and shall be planted in, or allowed to be colonized by, native emergent and submergent vegetation. The Developer shall ensure, by supplemental replanting if necessary, at least eighty-five percent (85%) coverage by native aquatic vegetation within the littoral zone (to include at a minimum the area between ordinary high water and ordinary low water) for five years.
- G(11). To prevent adverse effects to groundwater quality during construction, there shall be no excavation into or through the Floridan aquifer's confining layers.
- G(12). Stormwater management ponds shall not be constructed within wetland buffers or other natural resources of regional significance.

- G(13). All fill within the 25-year and 100-year floodplains shall be compensated by the creation of an equal or greater storage volume above the seasonal high water table. 100-year and 25-year floodplain compensation shall be compensated in sole use compensation areas, not dual use facilities (i.e. stormwater attenuation and floodplain compensation). The available storage volume above the 25-year Design High Water Level of any proposed stormwater attenuation ponds can be calculated toward compliance with the flood plain compensation requirement. In lieu of the above cup-for-cup compensation, the applicant may perform hydraulic analysis that reflect a No-Rise to the FEMA base flood elevation and receive a CLOMR from FEMA for the effected area. The hydraulic model is subject to approval by Manatee County.
- G(14). Education advocating surface water protection shall be provided to all residents and tenants in the project.
- G(15). This project shall be required to reduce the calculated pre-development flow rate by up to fifty percent (50%) for all stormwater outfall flow directly or indirectly into Mill Creek. Modeling shall be used to determine pre- and post- development flows.
- G(16). The Drainage Model and Construction Plan shall demonstrate that no adverse impacts will be created to neighboring residents surrounding the site in respect to drainage routing, grading, and runoff.
- G(17). Drainage Easements shall be dedicated to Manatee County and be shown on the Final Site Plan and Final Plats along any drainage systems conveying public drainage. In addition, Drainage Maintenance/Access Easements shall be dedicated along the banks of these systems in accordance with Manatee County Public Work standards. Manatee County is only responsible for maintaining the free flow of drainage through these systems. Manatee County has no obligation relative to these systems to maintain, change, improve, clean, repair erosion, or restore the natural changes in the course of stream beds.
- G(18). A no-rise permit will be required for all encroachment within the FEMA 100-year floodway of Wolf Slough and Mill Creek. Any existing or proposed structures within the floodway shall be modeled.
- G(19). The developer shall provide a drainage easement to Manatee County to accept stormwater for that portion of the following planned thoroughfare roadways that are located immediately adjacent to the project to accommodate the following planned build-out conditions. The developer shall design and construct the stormwater capacity for that portion of the following planned thoroughfare roadways within the project area and such design and construction shall be included in the SWFWMD permit documentation.

Lakewood Ranch Boulevard	6 lanes
44 th Avenue East	4 lanes
Center Ice Parkway	4 lanes
Pope Road	4 lanes
S.R. 70	6 lanes

Lorraine Road

4 lanes

H. HISTORICAL AND ARCHAEOLOGICAL SITES

- H(1). Any historical or archaeological resources discovered during development activities shall be immediately reported to the Florida Department of State, Division of Historical Resources, and treatment of such resources shall be determined in cooperation with the Division of Historical Resources, TBRPC, and the County. Archaeological test excavations by a professional archaeologist shall be conducted on each such site to provide sufficient data to make a determination of significance prior to the commencement of ground-disturbing activities at the site. The final determination of significance shall be made in conjunction with the Florida Department of State, Division of Historical Resources, TBRPC, and the County. The appropriate treatment of such resources (potentially including excavation of the site in accordance with the guidelines established by the Florida Department of State, Division of Historical Resources) must be completed before resource-disturbing activities are allowed to continue.

I. WATER

- I(1). The Developer shall participate, as required by Manatee County ordinances, in any necessary expansion of potable water service to each phase or subphase of the project to assure that adequate potable water capacity exists to accommodate the Project.
- I(2). The Developer shall be responsible for maintenance and operation of any on-site wells. These wells shall be operated in accordance with SWFWMD rules and regulations. Any existing on site wells not intended for potable or nonpotable uses shall be plugged and abandoned in accordance with Rule 40D-3.041(1), Florida Administrative Code.
- I(3). The Developer shall require the installation of high efficiency (low volume) plumbing fixtures, appliances, and other water conserving devices, as mandated by the Florida Water Conservation Act (Section 553.14, Florida Statutes). This will include the use of toilets requiring no more than 1.6 gallons per flush in all areas, and installation of self-closing or metered water faucets shall be required in all public and commercial restroom facilities.
- I(4). The Developer shall maintain all water lines and fire hydrants not dedicated to the County.
- I(5). The Developer shall use only nonpotable water to meet nonpotable (irrigation) water demands. For purposes of this Approval, "nonpotable" water is defined as water emanating from any source other than a public potable water utility.
- I(6). Adequate fire flow and water pressure shall be maintained within the project's water supply system.

- I(7). The Developer shall conform to and further the applicable rules and adopted guidelines of SWFWMD in regard to protection of the groundwater resources in the Southwest Tampa Bay Water Use Caution Area.
- I(8). The developer shall use the lowest quality of water available for irrigation purposes. Consideration shall be given to meeting the irrigation needs of the Project with the following sources, in order of preference: (1) stormwater and (2) non-potable quality groundwater. Prior to Final Site Plan approval(s), the developer shall identify the irrigation source which will be utilized. Use of Manatee County public potable water supply shall be prohibited for in-ground irrigation systems, including on individual lots.
- I(9). For the purpose of potable or reclaimed water conservation, utilization of xeriscape principles is required in landscaped areas, in accordance with Policy 3.2.3.3. Ecologically viable portions of existing native vegetation shall be incorporated into the landscape design to the greatest extent practicable and shall not be purposely irrigated. Native vegetation or drought-resistant vegetation shall be used in common and non-residential landscaped areas. Non-native vegetation may be used, consistent with xeriscape principles.
- I(10). The average total potable water use for the development shall not exceed 110 gallons per capita per day.
- I(11). A pre-design conference between the Developer and County staff shall be held prior to submittal of Construction Drawings for the Project to discuss the points of connection for potable water and wastewater service and the configuration of the potable water and sanitary sewer systems.
- I(12). The Developer shall submit a Master Plan for potable water, wastewater, and fire protection simultaneously with construction plan submittal for each area covered by the construction plan. The Developer shall also be responsible for determining if upgrading of offsite potable water and wastewater facilities is necessary to provide adequate potable water, sanitary sewer, or fire protection service to the portion of the development for which such service is being requested. Oversizing of potable water and wastewater facilities may be necessary to provide for future development in or adjacent to the Project and the Developer shall participate in such oversizing in accordance with applicable County ordinances or policies.

J. WASTEWATER

- J(1). The Developer shall participate, as required by Manatee County ordinances, in any necessary expansion of wastewater service to each phase or subphase of the project to assure that adequate wastewater capacity exists to accommodate the project.
- J(2). No permanent septic system shall be permitted within the project.
- J(3). Sewer lift stations shall be designed and equipped in accordance with County regulations.

J(4). The disposal of waste into the sewer system shall comply with the Manatee County Sewer Use Ordinance (Ordinance No. 98-28).

J(5). The Developer shall implement a wastewater reuse system, outside of the Evers Reservoir basin, when feasible.

K SOLID WASTE

K(1) As stated in the ADA, it is not anticipated that hazardous or toxic waste will be generated by the project's office or commercial tenants. Within one year of the effective date of the Development Order, or prior to issuance of subsequent Development Approvals for any nonresidential land use within the project, whichever occurs later, the Developer shall prepare a hazardous substances (including bio-hazardous wastes) and a hazardous waste management plan which shall be reviewed and approved by the County, NRD, and TBRPC, and then distributed by the Developer to nonresidential land users within the project.

1. At a minimum, the plan shall:

- a. Advise of applicable statutes and regulations regarding hazardous wastes and substances, including Title III (Community Right-to-Know Law) of the Superfund Amendment and Reauthorization Act (SARA Title III) and the requirement to comply with these rules;
- b. Indicate the types, sources, and volumes of waste and substances that are considered under the applicable statutes and agency rules to be hazardous and which must be stored or disposed of in specially designed containers;
- c. Describe generally improper disposal methods;
- d. Describe generally appropriate disposal methods;
- e. Provide a list of agencies which can be consulted regarding the proper handling and disposal of hazardous substances;
- f. Describe a program to inform owners and tenants of the information contained in the plan;
- g. Describe construction requirements for hazardous waste holding areas;
- h. Describe typical spill clean up methods; and
- i. Be updated and distributed to each non-residential land user biennially.

- K(2). All project tenants that generate hazardous waste shall be encouraged to utilize waste exchanges to the extent feasible. A report of such use, if any, shall be included in each Biennial Report.
- K(3). The Developer shall participate, as required by Manatee County ordinances, in any necessary expansion of solid waste service to each phase or subphase of the project to assure that adequate solid waste capacity exists to accommodate the project.

L. RECREATION AND OPEN SPACE

- L(1). Provide a minimum of 1 acre of usable recreation open space per 100 dwelling units with sufficient acreage in each defined Parcel and group of Parcels (see table below). (The Project is proposing 44.8 acres of recreation open space, greater than the 44.22 acres required by the formula above.) The project shall include Pocket Parks in each Parcel and a minimum of one Neighborhood Park per 500 units for each Parcel or group of Parcels that contains 500 units or more. A Community Park may be built in lieu of Neighborhood Parks within a given Parcel or group of Parcels, as long as the total acreage and distribution of recreation area/park land is met.

The project shall create a “green infrastructure” by connecting recreation areas/parks with trails/greenways; some of which may be 8-10 foot wide meandering landscaped sidewalks/multi-use trails.

Acreage for trails/greenways shall count towards meeting the 1 acre per 100 dwelling units for recreation areas/parks described above. For any trails not located within a recreation area/park, the recreation area shall be calculated as 3 times the width of the trail/greenway times the length of the trail.

Lakes, stormwater ponds, wetlands and other water features can be included in the total recreation open space acreage if there are recreation amenities such as fishing/observation piers, boardwalks, canoe/kayak/boat launches or other water related amenities associated with said water features. The recreation open space acreage for water features shall be calculated as 3 times the acreage of the recreation amenity itself (i.e.: 3 times the footprint of a fishing/observation pier) but not the acreage of the entire water body.

- L(2). The project shall contain a minimum of 44.8 acres of usable uplands for recreation open space/parks, including water features with recreation amenities. Acreage for the trails/greenways system shall be included in the 44.8 acres for recreation areas/parks. The Developer shall allocate this acreage as follows:

Parcel	Park Types
Parcel A-2	1 Pocket Park
Parcels C-1 – C-4	1 Neighborhood Park
Parcels G-1 - G-9	One or more additional neighborhood parks distributed appropriately north and south of Center Ice Parkway and Malachite Drive.

Parcel	Park Types
Parcel E	1 Pocket Park or other recreation facilities
Parcel I	1 Pocket Park
Parcel J	1 Pocket Park
Off-site – Pope Road @44 th Avenue	1 Neighborhood Park
Kent Lakes	1 Neighborhood Park or 1 Pocket Park with water-use facilities (i.e. pier(s) and canoe launch area(s).)
Trails east of Pope Road	2 miles of trails 10' wide

The specific size of each recreation area/park shall be determined by the Developer (as approved by the Building and Development Services Department in consultation with the Parks and Recreation Department) at time of Preliminary Site Plan approval based on the lot size(s) or unit types in the area being served. In general, Pocket Parks shall be a minimum of 1 – 4 acres, Neighborhood Parks 5-10 acres and Community Parks 20 – 50 acres in size. All parks shall be distributed accordingly so residents can safely walk/bike from their home to the park (generally not more than ½ mile).

The required park area in each Parcel(s) may be reduced, at a ratio of 1 acre/100 units, if the Parcel(s) are not built out to the number of units identified on the General Development Plan.

- L(3). Pocket Parks shall include a playground with seating, water fountain and shade structure, an open play field and shade trees. Other amenities may include a picnic area with pavilions, tables, benches and grills, depending on neighborhood demographics. Pocket Parks may be connected to the overall recreation area/park system via sidewalks and/or trail/greenway.
- L(4). Neighborhood Parks shall contain active and passive recreation facilities. Typical recreation amenities include, at a minimum, a playground with shaded seating, restroom, and water fountain; formal or informal "athletic fields" suitable for team sports (baseball, football, soccer, volleyball, etc.); multi-use trail with benches and/or exercise stations; and picnic area with pavilions, tables, benches and grills. Optional facilities include hard court facilities (tennis, racquetball, shuffleboard, etc) and a "club house" with swimming pool, depending on demographics of future residents. Neighborhood Parks shall be connected to the overall recreation area/park system via trails/greenways and sidewalks.
- L(5). Community Parks shall include active and passive recreation facilities. Typical recreation amenities include, at a minimum, a playground with shaded seating, restroom, and water fountain; formal or informal "athletic fields" suitable for team sports (baseball, football, soccer, volleyball, etc.); hard court facilities (tennis, racquetball, shuffleboard, etc.); a "club house" with swimming pool; multi-use trail with benches and/or exercise stations; and picnic area with pavilions, tables, benches and grills. Actual recreation facilities built are dependent on demographics of future residents. Community Parks shall be connected to the overall recreation area/park system via trails/greenways and sidewalks.

- L(6). Any park in an "age-targeted" or "age-restricted" neighborhood shall have facilities appropriate for that age group. Parks not in age-targeted or age-restricted neighborhoods shall provide facilities appropriate for all ages, including a playground with outdoor play equipment.
- L(7). Multi-family parcels (Parcels A-2 and J, as listed in L(2), above) shall include active and passive recreation facilities that meet the needs of future residents based on projected demographics.
- L(8). A master plan for trails/greenways for the area east of Pope Road shall be approved by the Manatee County Building and Development Services Department (in consultation with the Parks and Recreation Department) prior to the first Preliminary Site Plan. (The "Central Park" area west of Pope Road and east of Lakewood Ranch Boulevard has previously received Preliminary Site Plan approval.) **(Completed)** At a minimum, the trail/greenway system shall include a trail/greenway adjacent or proximate to the wetlands and preserved uplands on the project's eastern side with "collector" trails from residential neighborhoods connecting with the "wetland/preserve" trail. Trails/greenways shall contain benches with shade (architectural and/or vegetation) located along the trail system in appropriate locations (i.e.: rest stops; for nature observation etc.). Other recreation facilities such as gazebos may also be located in appropriate locations along the trail system. Trails/greenways shall, as much as practical, be ADA compliant with an emphasis on accessing the most significant natural and built landscape components (i.e.: beautiful vistas and fishing/observation piers, among others). Improvements shall be completed concurrent with adjacent plat approvals.
- L(9). All nature trails, board walks and other recreation amenities that may be permitted by the Building and Development Services Department in wetlands, wetland buffers, and upland preservation areas shall be designed to minimize impacts to trees, other significant vegetation and natural habitats in accordance with Section 719 of the Manatee County Land Development Code. Management plans shall be written and implemented to ensure the long term maintenance and ecological viability of these areas.
- L(10). All recreation, park, and wetland sites shown on the General Development Plan shall not be utilized for other uses inconsistent with their designation on this map. Any proposal to change these uses shall be subject to a Substantial Deviation Determination if required by Subsection 380.06, Florida Statutes.
- L(11). All recreation and open space areas not deeded to the County or other state agencies shall be owned and maintained as common open space through a property owners association, or other similar entity, for the project.
- L(12). The developer shall dedicate to Manatee County land outside of the DRI boundary for a recreational park consisting of approximately 15 acres of usable park land, lying north of 44th Avenue Extension (proposed) and west of Pope Road adjacent to the parcels owned by the Manatee County School Board at the northwest quadrant of that intersection. Dedication of the park land shall occur prior to the first

Final Site Plan approval after the commencement of Phase II. The developer shall design and construct park improvements as agreed upon between the developer and Manatee County Parks and Recreation Department, the timing of which will be determined in the future once the County has a clearer understanding of future funding available for park operations. If built, park improvements shall be constructed using design concepts and materials consistent with similar park facilities in other Manatee County parks. Manatee County shall identify the park as a planned project within the parks and recreation level of service standards contained in the Comprehensive Plan as a condition precedent to the developer's required dedication of the land. Upon the dedication of the park together with all improvements thereon to Manatee County for use by the general public, the park shall be a park within the Manatee County Parks and Recreation system. If the dedication and construction by the Developer meets this condition, it shall be eligible for impact fee credits from the parks and recreation component.

- L(13). The existing Kent Lakes shall be incorporated into the project's recreation infrastructure. This may include, but not limited to, the construction of trails around the lakes; passive observation points with benches; small fishing pier(s); and a canoe/kayak launching area. Recreation facility acreage at Kent Lakes can be included in the overall recreation area/park acreage as described in L(1) and L(2).

M. EDUCATION

- M(1). To mitigate the project's impacts, the Developer provided the Manatee County School Board sufficient land for elementary and middle school sites.

N. HEALTH CARE, POLICE, AND FIRE

- N(1). The Developer shall be responsible for contributing a pro-rata share of the cost of land acquisition, construction, and equipping of emergency service facilities for emergency medical services. The Developer may, with the concurrence of the County, satisfy this obligation in whole or in part by conveyance of land deemed suitable for the intended use by the County or payment of impact fees, as applicable. An agreement as to the schedule for payment of the Developer's pro-rata share, mutually acceptable to the County and the Developer, shall be submitted prior to the approval of the first Final Site Plan or Final Plat for Vertical Development for Phase I or any subphase thereof. The pro-rata share shall not exceed the total sum of impact fees anticipated from the project and any pro-rata lump sum payment shall be creditable against the payment of impact fees at the rate in effect at the time payment was made. **(Completed)**
- N(2). The Developer shall be responsible for contributing a pro-rata share of the cost of land acquisition, construction, and equipping of fire protection service facilities for fire protection services. The Developer may, with the concurrence of the County, satisfy this obligation in whole or in part by conveyance of land deemed suitable for the intended use by the County or payment of impact fees, as applicable. The pro-rata share shall not exceed the total sum of impact fees anticipated from the project and any pro-rata lump sum payment shall be creditable against the payment of impact fees, in accordance with applicable law. **(Completed)**

- N(3). The project shall be designed and constructed to meet or exceed specifications of the State Fire Code, Rule 4A-3.012., Florida Administrative Code. The project shall use, as applicable, Fire Wise principles, such as clearing around houses, carefully spacing trees, and maintaining irrigation systems.
- N(4). The maximum height of buildings in the project shall not exceed that appropriate for the available water pressure and fire flows, or exceed the reach of available fire fighting equipment at the time of any Preliminary Site Plan approval for any phase or subphase.
- N(5). Prior to approval of all Preliminary Site Plans, the Developer shall provide assurance for each increment of development that the site will be supplied to the extent required by applicable code with water lines of adequate size, and functioning fire hydrants in sufficient number and appropriate locations to accommodate fire fighting operations. Additionally, the Developer shall provide calculations by a Florida registered engineer to the County indicating that fire flow and water pressure to the site are adequate for fire protection purposes and written assurance from the Braden River Fire District that the proposed locations of all fire hydrants and appurtenances are adequate prior to the issuance of any Final Plat or Certificate of Occupancy in the project.

O. ECONOMICS

- O(1). Excess infrastructure capacity constructed by the developer shall be at the developer's risk and shall not vest later development rights not addressed in this approval.
- O(2). The project shall promote entrepreneurship and small and minority owned business start-up, and encourage nondiscriminatory employment opportunities, pursuant to policies 21.2, SCP and 21.5.3, FCRPP, respectively.
- O(3). The development and promotion of a day care system should be encouraged on site, and any such day care system shall be in compliance with the Manatee County Land Development Code and any other applicable regulations.

P. ENERGY

- P(1). Issuance of development approvals for each phase or subphase shall be dependent upon the ability of electrical or gas utilities to meet the energy requirements of the development.
- P(2). All project tenants, businesses, residents, etc. shall be notified in writing by the Developer prior to occupancy that the following energy related practices are encouraged:
 - a. Use energy alternatives, such as solar energy, resource recovery, waste heat recovery, and co-generation, where economically feasible;

- b. Obtain energy audits provided by energy companies or other qualified agencies;
- c. Install water heater timers and set water heaters at 130 degrees Fahrenheit or lower;
- d. Use landscaping and building orientation to reduce heat gain, where feasible, for all Project construction;
- e. Promote energy conservation by employees, buyers, suppliers, and the public, as appropriate;
- f. Reduce levels of operation of all air conditioning, heating, and lighting systems during nonbusiness hours, as appropriate;
- g. Institute and utilize recycling programs;
- h. Utilize energy efficient packaging or recyclable materials;
- i. Install total energy systems on large facilities when cost effective; and
- j. Elimination of advertising requiring lighting after business hours where feasible.

Q. AFFORDABLE HOUSING

- Q(1). An assessment of the potential affordable housing impacts of the project was performed as part of the DRI review. This analysis was accepted by the reviewing agencies and indicated that there was no unmet need for affordable housing in the project area. No mitigation for affordable housing impact is required.
- Q(2). Any affordable housing analysis required in the event this Ordinance is amended to allow non-residential development in Phase II beyond that approved in Phase II shall be based on statutes, ordinances and rules in effect at the time this ordinance is amended.

R. HURRICANE PREPAREDNESS

- R(1). The Developer shall coordinate with the Institute for Business and Home Safety (IBHS) and the Manatee County Public Safety Department, Emergency Management Division to determine the feasibility of incorporating wind resistant "fortified" design criteria into the commercial and office facilities.

S. DESIGN STANDARDS

- S(1). Regardless of information contained in the General Development Plan or development stipulations contained within this ordinance, this project shall comply with all regulations of the Land Development Code and the Comprehensive Plan.

S(2). Non Residential

- a. Notwithstanding the limitation in S(2).k.4 below, the maximum square footage for each commercial and office parcel, as identified on the General Development Plan, may be increased provided that all dimensional criteria as outlined in S.(2)b, consistent with the LDC and Comprehensive Plan provisions, as applicable, are met and there is a simultaneous decrease of square footage on another parcel. This shall not authorize an overall increase of square footage for the Project. Such modification does not require the submittal or review of an amended General Development Plan, but may be approved with a Preliminary Site Plan or Final Site Plan. Such Preliminary or Final Site Plan shall include a tracking chart and exhibit giving the location of additions and deletions to assure Manatee County that there has been no increase in square footage. Development totals shall be updated with each biennial report.

- b. The setbacks, heights, and lot sizes for non- residential land uses shall be as follows:

Type	Min. Lot Size (Sq. Ft.)	Front Setback (Ft.)	Side Setback (Ft.)	Rear Setback (Ft.)	Maximum Height (Ft.)
Commercial/Office Parcels B and D	7,500	40	15	30	3 stories/45 feet
Commercial/Office Parcel A-1	7,500	40	15	20	4 stories/60 feet
Commercial/Office Parcel E	7,500	40	15	20	3 stories/45 feet
Commercial/Office Parcel K	7,500	40	15	20	2 stories/30 feet

- c. Building Appearance

All building facades shall exhibit an aesthetically attractive appearance. Design shall be subject to the following criteria and reviewed for compliance by the Building and Development Services Department with future Final Site Plan and Building Permit submittals.

- 1) The sides of all buildings shall have minimal blank walls no longer than 30 feet in length or 20' in height. In order to insure that the buildings do not project a massive blank wall, design elements with distinctive color variation shall include prominently visible architectural details [e.g., bump-outs, reveals and projecting ribs, cornice, offset building planes, windows, shutters, areas of contrasting or different finish building materials, etc.] or other methods, as approved by the

Planning Director. Facades greater than 75 feet in length shall have varying roof lines through varying the height of the cornice, or the use of 2 or more roof types (parapet, dormers, and sloped, etc.).

- 2) Exterior building materials shall consist of brick, architectural precast concrete panels, architectural masonry units, split face block, glass, stucco, ceramic tile, stone, wood, or similar materials. Painted or exposed concrete block, or corrugated metal shall not be permitted, Architectural metals in conjunction with other permitted building materials shall be allowed, provided that at least seventy five percent (75%) of the building face is constructed from other permitted materials.
- 3) All rooftop mechanical equipment shall be screened from view from abutting roadways or adjacent residential properties. Screening shall be provided by materials consistent with the building. Details shall be shown prior to Final Site Plan approval.

d. Service Areas

- 1) All truck loading, service areas, and outside storage shall not be adjacent to or visible from adjacent roads or visible from residential properties.
- 2) Trash and garbage receptacles shall be screened with materials similar to the adjacent building facade.
- 3) Tractor trailer or semi-trucks involved in deliveries to the rear of the buildings (or sides if facing residential) shall be restricted to the hours between 7:00 a.m. and 10:00 p.m. During the period of time between 10:00 p.m. and 7:00 a.m., there shall be no:
 - delivery, loading, or unloading of tractor trailer or semi-trucks;
 - use of forklifts or other loading or unloading devices; and
 - running of truck or trailer motors, or other refrigeration devices installed thereon.

e. Exhaust and other filtering systems in Food Service Establishments or uses shall adhere to the Best Available Control Technology to eliminate or reduce the emission of smoke, grease, and odor from cooking facilities. This system shall be approved by the Environmental Management Department with each Final Site Plan containing a food service establishment or use.

f. Exterior loud speakers, bells, or similar audio-communication shall not be permitted; however, directed (non broadcast) communication devices and intercoms shall not be restricted. "Directed (non broadcast)" shall mean not plainly audible to a person greater than 10 feet from the source.

- g. Signs shall meet the requirements of Section 724 of the Land Development Code.
- h. Each non-residential parcel shall include a pedestrian connection, where applicable, to abutting residential parcels, to be determined at time of Preliminary Site Plan approval.
- i. A maximum of six (6) gasoline pumps per parcel may be located on Parcels B, D, and E. Any gasoline pumps on Parcels B, D, and E shall be a minimum of 120 feet from any residential lots.
- j. Parcel A-1
 - 1) Parcel A-1 may not be developed with commercial uses unless the GDP is amended to reallocate existing commercial entitlements in the project to this parcel or the commercial entitlements in the project are increased. **(Completed)**
 - 2) A vertical mix of land uses is permitted on Parcel A-1. If a vertical mix is designed on this parcel, it will include commercial (if permitted in the future) and office uses on the first floor and residential or office land uses on the upper floors.
 - 3) The wetland at the southwest corner of Lakewood Ranch Boulevard and 44th Avenue shall be included in Parcel A-1 in order to take advantage of the 75% Rule pursuant to Land Use Operative Provision E(5)(a) of the Comprehensive Plan.
- k. Parcels B and D
 - 1) At time of Final Site Plan submittal, a fifteen foot buffer shall be provided along the boundary of each parcel where it abuts the residential component.
 - 2) Prior to the issuance of a Certificate of Occupancy for each commercial parcel, the abutting landscape buffer on the residential parcel shall be completed and certified to the Building and Development Services Department by a Florida Registered Landscape Architect. The Landscape Architect shall certify that all the trees have survived and sustained normal growth patterns. Trees which have not shall be replaced with enhanced tree sizes to make up the loss in growth time.

Prior to Certificate of Occupancy for the main commercial buildings, a Florida Registered Landscape Architect shall re-certify that all the trees have survived and sustained normal growth patterns. Trees which have not shall be replaced with enhanced tree sizes to make up the loss in growth time.

- 3) The developer shall construct pedestrian access to the Parcel B from Parcel C-3. Such access may, at the developers option be gated.
- 4) The applicant has the option of administratively relocating up to 3,000 square feet of commercial entitlements in Parcels B or D to lots adjacent to the central park, consistent with the Comprehensive Plan.

I. Parcel E

- 1) The building design and site layout shall promote a pedestrian and neighborhood scale, to be determined at time of Preliminary Site Plan approval.
- 2) Parcel E shall be designed in such a way as to maintain connectivity between adjacent neighborhoods and ensure compatibility between non-residential and residential uses within the parcel, to be determined at time of Preliminary Site Plan approval.
- 3) The building and layout shall be substantially consistent in theme with the photos and plan submitted and attached as Exhibit 4.
- 4) To promote a neo traditional design theme, limited parking shall be allowed in front of the building(s).
- 5) Building height shall be limited to 30 feet, except for architectural features which may be up to 45 feet in height.
- 6) No building shall be constructed within 50 feet of a residential subphase or lot, if platted.
- 7) Building layout and design shall avoid the look of a "Big Box" building; and
- 8) Any structures (residential, non-residential, ancillary, etc.) constructed within the "Coordination Zone", as indicated on the GDP, shall be designed in a style compatible with the style of the main buildings or buildings within Parcel E.

S(3). Residential

- a. The setbacks, heights, and lot sizes for residential land uses shall be as follows:

Type	Min. Lot Size (Sq. Ft.)	Minimum Lot Width ⁴ (Ft.)	Front Setback (Ft.) ¹	Side Setback (Ft.)	Rear Setback (Ft.)	Maximum Height (Ft.)
Single-Family Detached ^{3,8}	4,950	42	25/20	6 ^{4,5}	15	35

Single-Family Detached ^{3,8}	9,000	76	25/20	6 ^{4,5}	15	35
Single-Family Detached ^{3,8}	9,000	80	25/20	7.5 ⁶	15	35
Single-Family Attached ⁸	2,500	25	25/20	0/10 ⁷	15	35
Single-Family Semi-Detached ⁸	4,950	45	25/20	0/10 ⁷	15	35
Multi-Family	NA	NA	25	15/25 ²	15	3 Stories/35
Park	NA	NA	25	15	15	35
Residential Support Uses	NA	NA	40	15	30	45

1. The front yard setback for all single-family residences shall be 25' to the garage portion of the structure. The remaining habitable portion of the structure may be setback 20'. The front yard setback for structures with side-loaded garages shall be 20'.
2. This distance is not a side yard setback but the minimum distance between buildings. A 15' separation is required between one-story buildings. A 25' separation is required between two and three story buildings.
3. Required setbacks are based on the dominant lot width for each subphase of development.
4. There shall be a minimum ten (10) foot separation between accessory equipment (e.g. air conditioner units, heat pumps, pumps, etc.) and structures alongside adjoining houses with 6-foot side yard setbacks.
5. Zero Lot Line alternative allows a side setback of 11'/1' (min.) with a building separation of no less than 12'.
6. Zero Lot Line alternative allows a side setback of 14'/1' (min.) with a building separation of no less than 15'.
7. Zero Lot Line alternative allows a side setback of 19'/1' (min.) with a building separation of no less than 20'.
8. Use of the Zero Lot Line alternative must be declared with the approval of a Preliminary Subdivision Plat and Preliminary/Final Site Plan.
9. The rear yard setback for accessory structures not exceeding 200 square feet and 15 feet in height to the highest point of the structure, designed for outdoor sitting and gathering, shall be five feet and the waterfront setback shall be 18 feet for all residential parcels, located east of Pope Road. Such structures shall not be located within any drainage, utility, or lake maintenance easements. Such structure may have no more than two walls enclosed with all other sides of the

structure remaining unenclosed and unscreened and may not be used for storage. The design shall be consistent with the architectural design of the associated home, shall be approved by the Homeowners Association and only one such structure shall be allowed per lot.

- b. The Notice to Buyers or Tenants shall be included in the Declaration of Covenants and Restrictions, and in a separate addendum to the sales contract, and in the Final Site Plan shall include language informing prospective homeowners of the following:
 - 1) The location and size of future commercial and office developments in the project.
 - 2) The future extensions of 44th Avenue, Pope Road, and Center Ice Parkway as collector roadways through the project, and Malachite Drive as a major local street through the project.
 - 3) Inter-neighborhood ties, where applicable.
 - 4) Certain accessory structures designed for outdoor sitting and gathering have restrictions imposed by Manatee County that limit such structures to one structure of no more than 200 square feet and no more than 15 feet in height to the highest point of the structures, per lot, and which may have no permanent enclosure on two of the four walls.
- c. Any Preliminary Site Plan for residential development next to a previously approved residential plan containing a less intense residential product (i.e. single family attached or multi-family adjacent to single family detached) shall provide enhanced separation and buffering between the two types of housing products, as approved by the Building and Development Services Director.
- d. A Group Care Home (small and large) is permitted on Parcels A-1, A-2, G-5, G-8, G-9, I or J. The height of any Group Care Home on a residential parcel may not exceed 3 stories and 35 feet. All large group care homes shall maintain a minimum setback of 75 feet from adjacent single family property and shall be on a roadway shown on the GDP.
- e. Parcel A-2:
 - 1) The multi-family buildings located on Parcel A-2 shall be setback a minimum of 75' from Lakewood Ranch Boulevard and 30 feet from Rosedale to the west. This shall be approved by the Building and Development Services Department with the Preliminary and Final Site Plans.
 - 2) The multi-family buildings on Parcel A-2 shall be separated from Parcel A-1 by a 20' screening buffer.

f. Parcels C-1 – C-4

- 1) Prior to Final Plat approval for the sections of Parcels C-2 and C-3 abutting Parcels B and D, the wall, berm, and landscaping depicted in Attachment "B" as shown on Preliminary Site Plan (PDMU-05-09(Z)(P) shall be installed.
- 2) To provide adequate area for tree canopy growth for screening purposes, the landscape buffer, where abutting the commercial component in Parcel B, shall be increased to a minimum width of 40 feet in Parcel C-3. Lots shown on the Preliminary Site Plan as being within this stipulated buffer shall be redesigned and relocated out on the Final Site Plan.
- 3) Lots in Parcels C-2 and C-3, within 200 feet of Parcels B and D, shall be limited to one story houses.
- 4) The developer shall construct pedestrian access from Parcel B to Parcel C-3.

g. Parcel G-7

An upland buffer at least 35 feet wide shall be provided along the eastern boundary where this parcel abuts parcels adjacent to Lorraine Road.

h. Parcel J

All multi-family buildings shall be setback a minimum of 75' from SR 70. This shall be approved by the Building and Development Services Department with the Preliminary and Final Site Plan.

- i. Residential Support Uses are allowed in Parcels A-2, C-1 through C-4, F, G-1 through G-9, J, and I. Churches and other places of worship (excluding large, medium, small and accessory day care centers) shall be allowed by Administrative Permit if locational criteria can be met, or by Special Permit if those criteria cannot be met, pursuant to Section 704.13.1 of the Land Development Code as may be amended. The square footage allocated to future large, medium and small day care centers, accessory day care centers, environmental education facilities and schools of special education are intended by this ordinance to be included within the entitlements already approved by the Northwest Sector DRI Development Order.

j. Parcels G-1, G-2 and G-3

All multi-family buildings shall be setback a minimum of 75 feet from 44th Avenue East and Pope Road. This shall be approved by the Building and Development Services Department with the Preliminary and Final Site Plans.

- k. The maximum number of units for each residential parcel, as identified on the General Development plan, may be increased provided there is a simultaneous decrease on another residential parcel. This shall not authorize an overall increase in residential units for the Project. Such modification does not require the submittal or review of an amended General Development Plan, but may be approved with a Preliminary Site Plan or Final Site Plan. Such Preliminary or Final Site Plan shall include a tracking chart and exhibit giving location of additions and deletions to assure Manatee County that there has been no increase in units. Development totals shall be updated with each biennial report.

T. DEFINITIONS

- A. "Acceptable Level of Service" shall, for links and intersections in Manatee County, Florida, mean Level of Service "C" on an average daily basis, or "D" on a peak hour basis, as provided in the Land Development Code. Level of Service "D" shall be measured on a peak hour basis as determined by the Highway Capacity Manual (1994), TRB Special Report 209 or the most current manual and computer software version in accordance with guidelines acceptable to Manatee County. Level of Service "C" capacity on an average daily basis shall be calculated either as 10 times the peak hour Level of Service "D" capacity, or if actual data is available to determine the "K" factor (please refer to the Florida Department of Transportation Planning and Statistics Department), then on the basis of the "K" factor.
- B. "Application for Development Approval" (or ADA) shall mean the Northwest Sector Development of Regional Impact Application for Development Approval (Submitted on May 2, 2005); the First Sufficiency Response submitted by the Developer on July 14, 2005; the Second Sufficiency Response submitted on October 28, 2005; the Third Sufficiency Response submitted on January 26, 2006.
- C. "County" shall mean the Board of County Commissioners for Manatee County, or their designee(s).
- D. "Development Plans" shall mean any Preliminary or Final Site Plan issued by Manatee County.
- E. "Developer" shall mean SMR North 70, LLC, its heirs, assigns, designees, and successors in interest as to the Project.
- F. "Development Approval" shall mean any approval for development granted through the Preliminary Site Plan, Preliminary Plat, Final Site Plan, Final Plat, or Construction Drawing approval where site plans or subdivision plats are not required.
- G. "Funding Commitments" shall mean any combination of the following to assure the completion of any improvements required by this Development Order: 1) binding commitments for the actual construction with the posting of

a cash bond, or irrevocable letter of credit in a form satisfactory to the County for construction of the improvements required as referenced in Tables 2 and 3 of this Ordinance; 2) actual construction; 3) the placement of the improvements in the current year plus one year of the Capital Improvements Element of the appropriate County or the current year plus the first two years (or current plus first four years for FIHS facilities) of the Adopted Five-Year Work Program of the Florida Department of Transportation; or 4) a commitment for construction and completion of the required roadway improvements, pursuant to a Local Development agreement entered into between the Developer and the County. This Agreement shall include a construction timetable which will set forth the completion of the required improvements consistent with the time frames specified in Tables 2 and 3.

- H. "General Development Plan" shall be defined as the site plan for PDMU-05-19 (G)(R7), last revised on June, 2013, and attached as Exhibit 1. Development on the General Development Plan shall be limited to the total number of dwelling units and non-residential development in Table 1.
- I. "Post-Development Wetlands" shall mean any lands determined to be within jurisdictional limits defined by Chapter 62-301, Florida Administrative Code (F.A.C.) and implemented by the Florida Department of Environmental Protection (FDEP), or as defined within Chapter 40D-4, F.A.C., and implemented by the Southwest Florida Water Management District (SWFWMD), including any wetland mitigation areas approved as part of development of this project.
- J. "Preliminary Site Plan" (PSP) shall mean a Master Preliminary Plan or a Preliminary Site Plan for a Phase or Subphase, as defined in The Manatee County Land Development Code.
- K. "Project" shall mean the land uses, phasing, and improvements described in Table 1 which are attributable to development on that property described in Section 5 herein and set forth on the General Development Plan attached hereto as Exhibit 1.
- L. "Transportation Impact Area" shall be defined as the roadway segments and intersections receiving transportation impacts where the traffic generated by the proposed phase or subphase shown on a proposed Preliminary Site Plan in combination with prior approvals of the project will be five percent (5%) (or whatever greater percentage may be employed from time to time by the Florida Department of Economic Opportunity (DEO), Tampa Bay Regional Planning Council (TBRPC), or the County, provided the more restrictive percentage of such greater percentage shall be used) or more of the applicable Peak Hour Level of Service volumes. This area is generally depicted on Map J of the Development Order, dated February, 2005.

- M. "Vertical Development" shall mean and shall be deemed to include the construction of new residential units and non-residential units or the reconstruction or addition to any such units.
- N. "Warranted" shall mean a determination by the County, or the Florida Department of Transportation (FDOT) for state roads (unless the improvement is identified as a "local improvement", based on generally accepted transportation engineering practices that the Acceptable Level of Service cannot be maintained on a roadway segment or intersection without the construction of a transportation improvement required by this Development Order. All reserved vehicle trips on the roadway segment or intersection shall be counted regardless of their source in making this determination.
- O. "Wetland" shall mean any wetland under the jurisdictional limits defined by Chapter 62-340, Florida Administrative Code, and implemented by the Florida Department of Environmental Protection, or as defined by Chapter 40D-4, FAC, and implemented by the Southwest Florida Water Management District.

SECTION 4. Except as expressly amended herein, all other prior zoning ordinances (and any site plans approved pursuant thereto) shall remain in full force and effect.

SECTION 4.5. LEGAL DESCRIPTION.

Legal description and sketch of the Project is attached as Exhibit A.

SECTION 6. EFFECTIVE DATE. This ordinance shall take effect upon the later of: 1) the filing of this ordinance with the Department of State, State of Florida, and 2) 45 days after the filing of Ordinance 13-24, the Development Order for Northwest Sector, with the Department of Economic Opportunity, unless a notice of appeal is filed pursuant to Section 380.07 Florida Statutes.

PASSED AND DULY ADOPTED, by the Board of County Commissioners of Manatee County, Florida this the 6th Day of August, 2013.

**BOARD OF COUNTY COMMISSIONERS
OF MANATEE COUNTY, FLORIDA**

BY: 
Larry Bustle, Chairman

ATTEST: R. B. SHORE
Clerk of the Circuit Court

BY: 
Deputy Clerk



EXHIBITS

Legal Description (Exhibit A)

General Development Plan (Exhibit B)

Northwest Sector DRI/Lakewood Centre DRI Conceptual Trails Master Plan (Exhibit C)

**Exhibit A-Legal Description
SMR North 70, LLC Ownership**

LEGAL DESCRIPTION PARCEL 1 (as prepared by the certifying Surveyor and Mapper):

A tract of land lying in Sections 7, 8, 9, 15 and 16, Township 35 South, Range 19 East, Manatee County, Florida and described as follows:

Commence at the Southeast corner of Section 7, Township 35 South, Range 19 East ; thence S.89°34'35"E., a distance of 4,650.84 feet; thence N.00°25'25"E., a distance of 1,889.17 feet to the POINT OF BEGINNING; Thence S82°55'49"W, 912.79 feet to a point of curvature; Thence 1,287.78 feet along the arc of said curve to the left through a central angle of 34°25'49", said curve having a radius of 2,143.00 feet and being subtended by a chord which bears S65°42'55"W, 1,268.49 feet to a point of reverse curvature; Thence 1,575.57 feet along the arc of a curve to the right through a central angle of 44°37'25", said curve having a radius of 2,023.00 feet and being subtended by a chord which bears S70°48'42"W, 1,536.04 feet to the point of tangency of said curve; Thence N86°52'35"W, 1,131.57 feet to a point of curvature; Thence 79.90 feet along the arc of said curve to the right through a central angle of 91°33'16", said curve having a radius of 50.00 feet and being subtended by a chord which bears N41°05'57"W, 71.66 feet to the point of tangency of said curve; said point being a point on the east line of Lakewood Ranch Boulevard as recorded in Official Record Book 1443, Page 4980 of the Public Records of Manatee County, Florida; the following 2 calls are along said east line of Lakewood Ranch Boulevard; Thence N04°40'41"E, 2,619.78 feet to a point of curvature; Thence 933.27 feet along the arc of said curve to the left through a central angle of 25°57'27", said curve having a radius of 2,060.00 feet and being subtended by a chord which bears N08°18'02"W, 925.31 feet to a point of reverse curvature; Thence 83.52 feet along the arc of a curve to the right through a central angle of 95°42'23", said curve having a radius of 50.00 feet and being subtended by a chord which bears N26°34'26"E, 74.14 feet; Thence N 74°25'37"E, 50.78 feet to a point of curvature; Thence 721.56 feet along the arc of said curve to the right through a central angle of 14°53'05", said curve having a radius of 2,777.50 feet and being subtended by a chord which bears N81°52'09"E, 719.53 feet; Thence N00°41'18"W, 12.50 feet to a point on the arc of a curve; Thence 643.57 feet along the arc of said curve to the right through a central angle of 13°12'59", said curve having a radius of 2,790.00 feet and being subtended by a chord which bears S84°04'49"E, 642.15 feet to a point of reverse curvature; Thence 2,117.60 feet along the arc of a curve to the left through a central angle of 41°16'07", said curve having a radius of 2,940.00 feet and being subtended by a chord which bears N81°53'37"E, 2,072.13 feet to a point of reverse curvature; Thence 805.71 feet along the arc of a curve to the right through a central angle of 16°32'46", said curve having a radius of 2,790.00 feet and being subtended by a chord which bears N69°31'57"E, 802.91 feet; Thence S12°11'41"E, 12.50 feet to a point on the arc of a curve; Thence 633.68 feet along the arc of said curve to the right through a central angle of 13°04'19", said curve having a radius of 2,777.50 feet and being subtended by a chord which bears N84°20'29"E, 632.31 feet; Thence S89°07'21"E, 354.65 feet to a point on the arc of a curve; Thence 36.14 feet along the arc of said curve to the right through a central angle of 41°24'35", said curve having a radius of 50.00 feet and being

subtended by a chord which bears N70°10'21"E, 35.36 feet; Thence S89°07'21"E, 808.68 feet; Thence N00°52'39"E, 10.36 feet to a point on the arc of a curve; Thence 127.15 feet along the arc of said curve to the left through a central angle of 02°29'11", said curve having a radius of 2,930.00 feet and being subtended by a chord which bears N88°44'06"E, 127.14 feet to the point of reverse curvature of said curve ; Thence 2,138.82 feet along the arc of said curve to the right through a central angle of 43°45'59", said curve having a radius of 2,800.00 feet and being subtended by a chord which bears S770°37'30"E, 2,087.20 feet to the point of tangency of said curve ; Thence S48°44'31"E, 1,779.99 feet to a point of curvature; Thence 1,253.44 feet along the arc of said curve to the left through a central angle of 24°30'39", said curve having a radius of 2,930.00 feet and being subtended by a chord which bears S60°59'50"E, 1,243.90 feet to the point of tangency of said curve; Thence S00°10'39"W, 111.78 feet; Thence continue along said line S00°10'39"W, 1,324.27 feet; Thence continue along said line S00°10'39"W, 1,324.27 feet; Thence S00°12'01"W, 1,321.71 feet; Thence S89°26'33"E, 601.98 feet; Thence S00°02'33"W, 660.46 feet; Thence S89°28'53"E, 735.80 feet; Thence S00°06'56"E, 659.98 feet; Thence N89°31'12"W, 1,343.23 feet; Thence S00°24'15"E, 1,319.40 feet; Thence S00°25'33"E, 1,253.39 feet; Thence N89°20'55"W, 129.12 feet; Thence N00°13'59"E, 756.06 feet; Thence N89°05'49"W, 353.71 feet; Thence S15°32'18"W, 181.54 feet; Thence S69°04'52"E, 191.91 feet; Thence S40°52'20"E, 174.58 feet; Thence S01°06'51"W, 127.77 feet; Thence S84°30'37"W, 241.82 feet; Thence S04°24'14"W, 231.83 feet; Thence N89°20'55"W, 644.47 feet; Thence N89°43'18"W, 1,128.10 feet; Thence N00°16'21"E, 195.76 feet; Thence N34°32'27"W, 127.88 feet; Thence N74°22'37"W, 27.04 feet; Thence N89°06'07"W, 130.35 feet; Thence N50°59'38"W, 52.87 feet; Thence N89°43'39"W, 67.72 feet; Thence S34°23'48"W, 150.71 feet; Thence N00°07'45"W, 1,045.68 feet; Thence N89°21'00"W, 672.60 feet; Thence S00°08'39"E, 1,267.67 feet; Thence N89°43'18"W, 66.35 feet; Thence N10°16'40"E, 140.44 feet; Thence N03°14'20"W, 121.92 feet; Thence N89°43'20"W, 265.15 feet; Thence N67°44'14"W, 65.42 feet; Thence N89°03'25"W, 74.89 feet; Thence South, 285.36 feet; Thence N89°43'18"W, 150.77 feet to a point of curvature; Thence 78.54 feet along the arc of said curve to the right through a central angle of 90°00'00", said curve having a radius of 50.00 feet and being subtended by a chord which bears N44°43'18"W, 70.71 feet to the point of tangency of said curve; Thence N00°16'42"E, 1,581.12 feet to a point of curvature; Thence 1,394.32 feet along the arc of said curve to the left through a central angle of 27°15'57", said curve having a radius of 2,930.00 feet and being subtended by a chord which bears N13°21'17"W, 1,381.21 feet to the point of tangency of said curve; Thence N26°59'15"W, 1,159.92 feet to a point of curvature; Thence 853.47 feet along the arc of said curve to the right through a central angle of 17°27'52", said curve having a radius of 2,800.00 feet and being subtended by a chord which bears N18°15'19"W, 850.17 feet to a point of reverse curvature; Thence 1,194.50 feet along the arc of a curve to the left through a central angle of 23°21'30", said curve having a radius of 2,930.00 feet and being subtended by a chord which bears N21°12'08"W, 1,186.24 feet to a point of reverse curvature; Thence 1,321.41 feet along the arc of a curve to the right through a central angle of 27°02'23", said curve having a radius of 2,800.00 feet and being subtended by a chord which bears N19°21'42"W, 1,309.18 feet to the POINT OF BEGINNING.

Containing 1479.6 acres, more or less.

LESS AND EXCEPT:

Esplanade Parcel 1

A tract of land lying in Sections 8, 9 and 16 Township 35 South, Range 19 East, Manatee County, Florida and described as follows:

Commence at the Southwest corner of Section 8, Township 35 South, Range 19 East; thence S.89°34'35"E., along the south line of said Section 8, a distance of 4,694.71 feet; thence N.00°25'25"E., a distance of 1,721.45 feet to the POINT OF BEGINNING, also being the point of curvature of a curve to the right, of which the radius point lies N.80°37'16"E., a radial distance of 50.00 feet; thence northeasterly along the arc of said curve, through a central angle of 92°18'33", an arc length of 80.56 feet to the point of tangency of said curve; thence N.82°55'49"E., a distance of 73.27 feet to the point of curvature of a curve to the left having a radius of 1,560.00 feet and a central angle of 11°00'06"; thence easterly along the arc of said curve, an arc length of 299.54 feet to the point of tangency of said curve; thence N.71°55'44"E., a distance of 1,446.31 feet to the point of curvature of a curve to the right having a radius of 1,711.00 feet and a central angle of 41°19'41"; thence easterly along the arc of said curve, an arc length of 1,234.16 feet to the point of tangency of said curve; thence S.66°44'36"E., a distance of 493.70 feet; thence S.09°07'54"W., a distance of 548.70 feet to the point of curvature of a non-tangent curve to the right, of which the radius point lies S.40°33'12"W., a radial distance of 140.00 feet; thence southeasterly along the arc of said curve, through a central angle of 37°38'09", an arc length of 91.96 feet to the point of compound curvature of a curve to the right having a radius of 955.00 feet and a central angle of 10°10'07"; thence southerly along the arc of said curve, an arc length of 169.49 feet to the point of tangency of said curve; thence S.01°38'32"E., a distance of 219.98 feet to the point of curvature of a curve to the right having a radius of 225.00 feet and a central angle of 46°02'01"; thence southerly along the arc of said curve, an arc length of 180.77 feet to the point of compound curvature of a curve to the right having a radius of 791.00 feet and a central angle of 28°44'09"; thence southwestwardly along the arc of said curve, an arc length of 396.71 feet to the end of said curve, said point being the point of curvature of a non-tangent curve to the right, of which the radius point lies S.63°01'14"W., a radial distance of 105.00 feet; thence southerly along the arc of said curve, through a central angle of 63°06'13", an arc length of 115.64 feet to the point of reverse curvature of a curve to the left having a radius of 220.00 feet and a central angle of 76°59'24"; thence southerly along the arc of said curve, a distance of 295.62 feet to the point of reverse curvature of a curve to the right having a radius of 180.00 feet and a central angle of 45°24'06"; thence southerly along the arc of said curve, a distance of 142.63 feet to the end of said curve; thence S.67°17'30"E., along a line not tangent with the previously described curve, a distance of 380.27 feet to the point of curvature of a curve to the right having a radius of 185.00 feet and a central angle of 104°51'33"; thence southerly along the arc of said curve, an arc length of 338.58 feet to the point of reverse curvature of a curve to the left having a radius of 370.00 feet and a central angle of 56°49'09"; thence southerly along the arc of said curve, a distance of 366.92 feet to the point of reverse curvature of a curve to the right having a radius of 120.00 feet and a central angle of 33°02'51"; thence southerly along the arc of said curve, a distance of 69.21 feet to the point of tangency of said curve; thence

S.13°47'45"W., a distance of 137.38 feet to the point of curvature of a non-tangent curve to the left, of which the radius point lies S.14°03'45"W., a radial distance of 2,148.00 feet; thence westerly along the arc of said curve, through a central angle of 50°17'20", an arc length of 1,885.31 feet to the point of reverse curvature of a curve to the right having a radius of 2,018.00 feet and a central angle of 06°46'53"; thence southwesterly along the arc of said curve, a distance of 238.85 feet to the end of said curve; thence S.75°52'12"W., along a line not tangent with the previously described curve, a distance of 43.29 feet to the point of curvature of a non-tangent curve to the right, of which the radius point lies N.28°15'10"W., a radial distance of 2,007.00 feet; thence southwesterly along the arc of said curve, through a central angle of 01°15'55", an arc length of 44.32 feet to the point of tangency of said curve; thence S.63°00'45"W., a distance of 145.17 feet to the point of curvature of a curve to the right having a radius of 50.00 feet and a central angle of 90°00'00"; thence westerly along the arc of said curve, an arc length of 78.54 feet to the point of tangency of said curve, said point being a point on the east line of Pope Road as recorded in Official Record Book 2197, Page 5612 of the Public Records of Manatee County, Florida (the following three (3) calls are along said east line of Pope Road); 1) thence N.26°59'15"W., a distance of 127.44 feet to the point of curvature of a curve to the right having a radius of 2,800.00 feet and a central angle of 17°27'52"; 2) thence northerly along the arc of said curve, an arc length of 853.47 feet to the point of reverse curvature of a curve to the left having a radius of 2,930.00 feet and a central angle of 11°58'37"; 3) thence northerly along the arc of said curve, a distance of 612.48 feet to the end of said curve; thence N.23°29'59"E., along a line not tangent with the previously described curve, a distance of 28.19 feet to the point of curvature of a non-tangent curve to the left, of which the radius point lies S.68°06'45"W., a radial distance of 2,950.00 feet; thence northwesterly along the arc of said curve, through a central angle of 10°59'38", an arc length of 566.05 feet to the point of reverse curvature of a curve to the right having a radius of 2,780.00 feet and a central angle of 23°30'09"; thence northerly along the arc of said curve, a distance of 1,140.35 feet to the POINT OF BEGINNING.

Said tract contains 9,049,387 square feet or 207.7453 acres, more or less.

LESS AND EXCEPT:

Central Park

A tract of land lying in Sections 7 and 8, Township 35 South, Range 19 East, Manatee County, Florida and described as follows:

Commence at the Southwest corner of Section 8, Township 35 South, Range 19 East; thence S.89°34'35"E., a distance of 4,473.76 feet; thence N.00°25'25"E., a distance of 1,865.88 feet to the POINT OF BEGINNING; thence S.82°55'49"W., a distance of 734.17 feet to the point of curvature of a curve to the left having a radius of 2,143.00 feet and a central angle of 34°25'49"; thence southwesterly along the arc of said curve, an arc length of 1,287.78 feet to the point of reverse curvature of a curve to the right having a radius of 2,023.00 feet and a central angle of 44°37'24"; thence westerly along the arc of said curve, an arc length of 1,575.56 feet to the point of tangency of said curve; thence N.86°52'35"W., a distance of 1,131.57 feet to the point of curvature of a curve to the right having a radius of 50.00 feet and a central angle of 91°33'16"; thence northwesterly along the arc of said curve, an arc length of 79.90 feet to the point of tangency of said curve, said point being a point on the east line of Lakewood Ranch Boulevard as recorded in Official Record Book 1443, Page 4980 of the Public Records of Manatee County, Florida; the following 2 calls are along said east line of Lakewood Ranch Boulevard; thence N.04°40'41"E., a distance of 2,819.78 feet to the point of curvature of a curve to the left having a radius of 2,060.00 feet and a central angle of 25°57'09"; thence northerly along the arc of said curve, an arc length of 933.09 feet to the point of reverse curvature of a curve to the right having a radius of 50.00 feet and a central angle of 95°03'03"; thence northeasterly along the arc of said curve, an arc length of 82.95 feet to the point of compound curvature of a curve to the right having a radius of 2,777.50 feet and a central angle of 13°25'53"; thence easterly along the arc of said curve, an arc length of 651.10 feet to the end of said curve; thence N.02°47'33"W. along a line radial to the last described curve, a distance of 22.50 feet to the point of curvature of a non-tangent curve to the right, of which the radius point lies S.02°47'33"E., a radial distance of 2,800.00 feet; thence easterly along the arc of said curve, through a central angle of 15°31'49", an arc length of 758.95 feet to the point of reverse curvature of a curve to the left having a radius of 2,930.00 feet and a central angle of 41°52'42"; thence easterly along the arc of said curve, an arc length of 2,141.57 feet to the point of reverse curvature of a curve to the right having a radius of 2,800.00 feet and a central angle of 23°02'13"; thence easterly along the arc of said curve, an arc length of 1,125.80 feet to the end of said curve; thence S.06°06'13"E. along a line radial to the last described curve, a distance of 20.00 feet to the point of curvature of a non-tangent curve to the right, of which the radius point lies S.06°06'13"E., a radial distance of 2,780.00 feet; thence easterly along the arc of said curve, through a central angle of 06°58'51", an arc length of 338.71 feet to the point of tangency of said curve; thence S.89°07'21"E., a distance of 101.47 feet to the point of curvature of a curve to the right having a radius of 50.00 feet and a central angle of 89°22'24"; thence southeasterly along the arc of said curve, an arc length of 77.99 feet to the point of tangency of said curve; thence S.00°15'03"W., a distance of 371.57 feet to the point of curvature of a curve to the right having a radius of 2,780.00 feet and a central angle of 01°37'40"; thence southerly along the arc of said curve, an arc length of 78.98 feet to the end of said curve; thence S.88°07'17"E. along a line radial to the last described curve, a distance of 20.00 feet to the point of curvature of a non-tangent curve to the right, of which the radius point lies N.88°07'17"W., a radial distance of 2,800.00 feet; thence southerly along the arc of said curve, through a central angle of 24°46'23", an arc length of 1,210.64 feet to the point of reverse curvature of a curve to the left having a radius of 2,930.00 feet and a central angle of 31°36'21"; thence southerly along the arc of said curve, an arc length of 1,616.27 feet to the point of reverse curvature of a curve to the right having a radius of 50.00 feet and a central angle of 87°53'04"; thence southwesterly along the arc of said curve, an arc length of 76.69 feet to the POINT OF BEGINNING.

Said tract contains 16,204,397 square feet or 372.0018 acres, more or less.

LESS AND EXCEPT:

Esplanade (Parcel 2)

A tract of land lying in Sections 8, 9 and 16, Township 35 South, Range 19 East, Manatee County, Florida and described as follows:

Commence at the southwest corner of Section 8, Township 35 South, Range 19 East; thence S.89°34'35"E., along the south line of said Section 8, a distance of 4,694.71 feet; thence N.00°25'25"E., a distance of 1,721.45 feet to the POINT OF BEGINNING, said point being a point on a curve to the right, of which the radius point lies N.80°37'16"E., a radial distance of 2,780.00 feet; thence northerly along the arc, through a central angle of 36°01'50", a distance of 1,748.21 feet to a point of reverse curve to the left having a radius of 2,950.00 feet and a central angle of 24°46'23"; thence northerly along the arc, a distance of 1,275.50 feet; thence S.88°07'17"E., a distance of 5.00 feet to the point of curve of a non-tangent curve to the left, of which the radius point lies N.88°07'17"W., a radial distance of 2,955.00 feet; thence northerly along the arc, through a central angle of 01°37'40", a distance of 83.96 feet; thence N.00°15'03"E., a distance of 356.06 feet to a point of curve to the right having a radius of 50.00 feet and a central angle of 90°37'36"; thence northeasterly along the arc a distance of 79.09 feet; thence S.89°07'21"E., a distance of 660.99 feet; thence N.00°52'39"E., a distance of 12.50 feet; thence S.89°07'21"E., a distance of 426.72 feet to a point of curve to the right having a radius of 2,790.00 feet and a central angle of 39°46'01"; thence easterly along the arc a distance of 1,936.43 feet; thence S.49°21'21"E., a distance of 1,071.37 feet to a point of curve to the left having a radius of 2,940.00 feet and a central angle of 08°08'09"; thence southeasterly along the arc a distance of 417.48 feet; thence S.21°02'28"E., a distance of 446.80 feet; thence S.16°58'55"W., a distance of 613.20 feet; thence S.31°38'46"E., a distance of 879.38 feet; thence S.89°49'21"E., a distance of 850.11 feet to a point on the east line of Section 9, Township 35 South, Range 19 East; thence S.00°10'39"W., along the east line of said Section 9, a distance of 1,837.91 feet to the southeast corner of said Section 9, also being the northeast corner of Section 16, Township 35 South, Range 19 East, said corner being marked by a 4" concrete monument with an iron pin in the center of said monument; thence S.00°12'01"W., along the east line of said Section 16, a distance of 1,762.25 feet to the point of curve of a non-tangent curve to the left, of which the radius point lies S.29°10'18"W., a radial distance of 2,148.00 feet; thence westerly along the arc, through a central angle of 21°41'45", a distance of 813.36 feet to a point of reverse curve to the right having a radius of 2,018.00 feet and a central angle of 29°47'36"; thence westerly along the arc, a distance of 1,049.34 feet to a point of reverse curve to the left having a radius of 2,148.00 feet and a central angle of 23°12'24"; thence northwesterly along the arc, a distance of 870.01 feet to the southeast corner of Esplanade, Phase I recorded in Plat Book 55, Page 11 of the Public Records of Manatee County, Florida; (the following seven (7) calls are along the easterly line of said Esplanade, Phase I); (1) thence N.13°47'45"E., a distance of 137.38 feet to a point of curve to the left having a radius of 120.00 feet and a central angle of 33°02'51"; (2) thence northerly along the arc a distance of 69.21 feet to a point of reverse curve to the right having a radius of 370.00

feet and a central angle of $56^{\circ}49'09''$; (3) thence northerly along the arc, a distance of 366.92 feet to a point of reverse curve to the left having a radius of 185.00 feet and a central angle of $104^{\circ}51'33''$; (4) thence northerly along the arc, a distance of 338.58 feet; (5) thence $N.67^{\circ}17'30''W.$, a distance of 380.27 feet to the point of curve of a non-tangent curve to the left, of which the radius point lies $N.85^{\circ}27'53''W.$, a radial distance of 180.00 feet; (6) thence northerly along the arc, through a central angle of $45^{\circ}24'06''$, a distance of 142.63 feet to a point of reverse curve to the right having a radius of 220.00 feet and a central angle of $76^{\circ}59'24''$; (7) thence northerly along the arc, a distance of 295.62 feet to a point of reverse curve to the left having a radius of 105.00 feet and a central angle of $63^{\circ}06'13''$; thence northerly along the arc, a distance of 115.64 feet to the point of curve of a non-tangent curve to the left, of which the radius point lies $N.16^{\circ}52'21''W.$, a radial distance of 791.00 feet; thence northeasterly along the arc, through a central angle of $28^{\circ}44'09''$, a distance of 396.71 feet to a point of compound curve to the left having a radius of 225.00 feet and a central angle of $46^{\circ}02'01''$; thence northerly along the arc, a distance of 180.77 feet; thence $N.01^{\circ}38'32''W.$, a distance of 219.98 feet to a point of curve to the left having a radius of 955.00 feet and a central angle of $10^{\circ}10'07''$; thence northerly along the arc a distance of 169.49 feet to a point of compound curve to the left having a radius of 140.00 feet and a central angle of $37^{\circ}38'09''$; thence northwesterly along the arc, a distance of 91.96 feet; thence $N.09^{\circ}07'54''E.$, a distance of 548.70 feet; thence $N.66^{\circ}44'36''W.$, a distance of 493.70 feet to a point of curve to the left having a radius of 1,711.00 feet and a central angle of $41^{\circ}19'41''$; thence westerly along the arc a distance of 1,234.16 feet; thence $S.71^{\circ}55'44''W.$, a distance of 1,446.31 feet to a point of curve to the right having a radius of 1,560.00 feet and a central angle of $11^{\circ}00'06''$; thence westerly along the arc a distance of 299.54 feet; thence $S.82^{\circ}55'49''W.$, a distance of 73.27 feet to a point of curve to the left having a radius of 50.00 feet and a central angle of $92^{\circ}18'33''$; thence southwesterly along the arc a distance of 80.56 feet to the POINT OF BEGINNING.

Said tract containing 20,021,212 square feet or 459.6238 acres, more or less.

LESS AND EXCEPT:

DESCRIPTION: BRIDGEWATER

COMMENCE AT THE SOUTHWEST CORNER OF SECTION 16, TOWNSHIP 35 SOUTH, RANGE 19 EAST; THENCE S89°24'54"E, ALONG THE SOUTH LINE OF SAID SECTION 16, A DISTANCE OF 1417.30 FT.; THENCE N00°35'06"E, PERPENDICULAR WITH SAID SOUTH LINE, A DISTANCE OF 52.21 FT. TO THE INTERSECTION OF THE NORTHERLY RIGHT-OF-WAY OF STATE ROAD NO. 70 AND THE EASTERLY RIGHT-OF-WAY OF POPE ROAD, AS DESCRIBED AND RECORDED IN OFFICIAL RECORDS BOOK 2197, PAGE 5612, PUBLIC RECORDS OF MANATEE COUNTY, FLORIDA, SAID POINT LYING ON THE ARC OF A CURVE WHOSE RADIUS POINT LIES N00°16'42"E, A DISTANCE OF 50.00 FT.; THENCE RUN THE FOLLOWING COURSES ALONG SAID EASTERLY RIGHT-OF-WAY OF POPE ROAD: RUN NORTHWESTERLY, ALONG THE ARC OF SAID CURVE, THROUGH A CENTRAL ANGLE OF 90°00'00", A DISTANCE OF 78.54 FT. TO THE POINT OF TANGENCY (P.T.) OF SAID CURVE; THENCE N00°16'42"E, A DISTANCE OF 1581.12 FT. TO THE POINT OF CURVATURE (P.C.) OF A CURVE, CONCAVE TO THE WEST, HAVING A RADIUS OF 2930.00 FT.; THENCE RUN NORTHERLY, ALONG THE ARC OF SAID CURVE, THROUGH A CENTRAL ANGLE OF 15°00'54", A DISTANCE OF 767.83 FT. FOR A POINT OF BEGINNING; THENCE CONTINUE ALONG THE ARC OF SAID CURVE THROUGH A CENTRAL ANGLE OF 07°02'39", A DISTANCE OF 360.23 FT.; THENCE N78°45'42"E, LEAVING SAID EASTERLY RIGHT-OF-WAY OF POPE ROAD, A DISTANCE OF 189.18 FT. TO A POINT ON THE ARC OF A CURVE WHOSE RADIUS POINT LIES N73°04'10"E, A DISTANCE OF 143.00 FT.; THENCE RUN NORTHERLY, ALONG THE ARC OF SAID CURVE, THROUGH A CENTRAL ANGLE OF 11°01'22", A DISTANCE OF 27.51 FT. TO THE POINT OF REVERSE CURVATURE (P.R.C.) OF A CURVE CONCAVE TO THE SOUTHWEST, HAVING A RADIUS OF 225.00 FT.; THENCE RUN NORTHWESTERLY, ALONG THE ARC OF SAID CURVE, THROUGH A CENTRAL ANGLE OF 39°17'50", A DISTANCE OF 154.32 FT. TO THE P.T. OF SAID CURVE; THENCE N45°12'18"W, 44.92 FT.; THENCE N57°27'26"W, A DISTANCE OF 64.68 FT. TO THE P.C. OF A CURVE, CONCAVE TO THE NORTHEAST, HAVING A RADIUS OF 75.00 FT.; THENCE RUN NORTHERLY, ALONG THE ARC OF SAID CURVE, THROUGH A CENTRAL ANGLE OF 89°26'12", A DISTANCE OF 117.07 FT. TO THE P.R.C. OF A CURVE CONCAVE TO THE SOUTHWEST, HAVING A RADIUS OF 175.00 FT.; THENCE RUN NORTHWESTERLY, ALONG THE ARC OF SAID CURVE, THROUGH A CENTRAL ANGLE OF 87°09'50", A DISTANCE OF 266.23 FT. TO THE P.R.C. OF A CURVE CONCAVE TO THE NORTHEAST, HAVING A RADIUS OF 605.00 FT.; THENCE RUN NORTHWESTERLY, ALONG THE ARC OF SAID CURVE, THROUGH A CENTRAL ANGLE OF 20°18'53", A DISTANCE OF 214.51 FT. TO THE P.T. OF SAID CURVE; THENCE N34°52'11"W, A DISTANCE OF 348.02 FT. TO THE INTERSECTION WITH THE SOUTHERLY LINE OF RANGELAND PARKWAY, A PUBLIC RIGHT-OF-WAY TRACT AS SHOWN ON THE PLAT OF "ESPLANADE, PHASE I", A SUBDIVISION AS RECORDED IN PLAT BOOK 55, PAGES 11 THROUGH 21, SAID PUBLIC RECORDS; THENCE RUN THE FOLLOWING COURSES ALONG SAID SOUTHERLY LINE, RUN N63°00'45"E, A DISTANCE OF 84.69 FT. TO THE P.C. OF A CURVE, CONCAVE TO THE NORTHWEST, HAVING A RADIUS OF 2148.00 FT.; THENCE RUN NORTHEASTERLY, ALONG THE ARC OF SAID CURVE, THROUGH A CENTRAL ANGLE OF 09°14'20", A DISTANCE OF 346.36 FT. TO THE P.R.C. OF A CURVE, CONCAVE TO THE SOUTHEAST, HAVING A RADIUS OF 2018.00 FT.; THENCE RUN EASTERLY, ALONG THE ARC OF SAID CURVE, THROUGH A CENTRAL ANGLE OF 16°33'12", A DISTANCE OF 583.02 FT. TO THE SOUTHEAST CORNER OF SAID RANGELAND PARKWAY; THENCE, LEAVING SAID SOUTHERLY LINE, CONTINUE EASTERLY, ALONG THE ARC OF SAID CURVE, THROUGH A CENTRAL ANGLE OF 59°55'48", A DISTANCE OF 2110.78 FT. TO THE P.R.C. OF A CURVE, CONCAVE TO THE NORTHEAST, HAVING A RADIUS OF 1500.00 FT.; THENCE RUN SOUTHEASTERLY, ALONG THE ARC OF SAID CURVE, THROUGH A CENTRAL ANGLE OF 35°07'02", A DISTANCE OF 919.37 FT. TO THE P.R.C. OF A CURVE, CONCAVE TO THE SOUTH, HAVING A RADIUS OF 1200.00 FT.; THENCE RUN SOUTHEASTERLY, ALONG THE ARC OF SAID CURVE, THROUGH A CENTRAL ANGLE OF 28°49'27", A DISTANCE OF 603.69 FT. TO THE P.T. OF SAID CURVE; THENCE S56°02'09"E, 149.65 FT.; THENCE S60°55'23"W, 160.81 FT.; THENCE S74°43'26"W, 111.20 FT.; THENCE S13°55'23"W, 65.12 FT.; THENCE S29°40'19"W, 72.83 FT.; THENCE S04°07'29"W, 50.07 FT.; THENCE S22°00'02"W, 156.97 FT.; THENCE S00°49'10"W, 109.06 FT.; THENCE S13°53'11"W, 163.66 FT.; THENCE S05°39'51"W, 91.75 FT.; THENCE S24°30'51"W, 89.09 FT.; THENCE S17°57'55"W, 103.40 FT.;

THENCE S33°05'02"W, 32.46 FT.; THENCE S48°57'36"W, 63.17 FT.; THENCE S39°18'05"W, 111.47 FT.; THENCE N00°51'51"W, 57.83 FT.; THENCE N81°26'55"W, 156.48 FT.; THENCE S88°27'28"W, 602.33 FT.; THENCE N14°40'35"W, A DISTANCE OF 50.88 FT. TO THE P.C. OF A CURVE, CONCAVE TO THE SOUTHWEST, HAVING A RADIUS OF 62.00 FT.; THENCE RUN NORTHWESTERLY, ALONG THE ARC OF SAID CURVE, THROUGH A CENTAL ANGLE OF 68°31'39", A DISTANCE OF 74.15 FT. TO THE P.R.C. OF A CURVE CONCAVE TO THE NORTHEAST, HAVING A RADIUS OF 703.00 FT.; THENCE RUN NORTHWESTERLY, ALONG THE ARC OF SAID CURVE, THROUGH A CENTAL ANGLE OF 21°37'27", A DISTANCE OF 265.32 FT. TO THE P.T. OF SAID CURVE; THENCE N61°34'47"W, A DISTANCE OF 10.71 FT. TO THE P.C. OF A CURVE, CONCAVE TO THE SOUTHWEST, HAVING A RADIUS OF 55.00 FT.; THENCE RUN NORTHWESTERLY, ALONG THE ARC OF SAID CURVE, THROUGH A CENTAL ANGLE OF 25°19'11", A DISTANCE OF 24.31 FT. TO THE POINT OF COMPOUND CURVATURE (P.C.C.) OF A CURVE CONCAVE TO THE SOUTHEAST, HAVING A RADIUS OF 85.00 FT.; THENCE RUN SOUTHWESTERLY, ALONG THE ARC OF SAID CURVE, THROUGH A CENTAL ANGLE OF 55°44'02", A DISTANCE OF 63.23 FT. TO THE P.R.C. OF A CURVE CONCAVE TO THE NORTHWEST, HAVING A RADIUS OF 485.00 FT.; THENCE RUN SOUTHWESTERLY, ALONG THE ARC OF SAID CURVE, THROUGH A CENTAL ANGLE OF 45°45'14", A DISTANCE OF 387.30 FT. TO THE P.T. OF SAID CURVE; THENCE S83°07'13"W, 134.30 FT.; THENCE S83°03'04"W, 102.37 FT.; THENCE S88°41'17"W, A DISTANCE OF 117.94 FT. TO THE P.C. OF A CURVE, CONCAVE TO THE NORTHEAST, HAVING A RADIUS OF 415.00 FT.; THENCE RUN NORTHWESTERLY, ALONG THE ARC OF SAID CURVE, THROUGH A CENTAL ANGLE OF 18°29'42", A DISTANCE OF 133.96 FT. TO THE P.R.C. OF A CURVE CONCAVE TO THE SOUTHWEST, HAVING A RADIUS OF 480.00 FT.; THENCE RUN NORTHWESTERLY, ALONG THE ARC OF SAID CURVE, THROUGH A CENTAL ANGLE OF 17°21'42", A DISTANCE OF 145.45 FT. TO THE P.T. OF SAID CURVE; THENCE S89°49'17"W, 119.92 FT.; THENCE N12°56'15"E, A DISTANCE OF 68.96 FT. TO THE P.C. OF A CURVE, CONCAVE TO THE SOUTHWEST HAVING A RADIUS OF 85.00 FT.; THENCE RUN NORTHWESTERLY, ALONG THE ARC OF SAID CURVE, THROUGH A CENTAL ANGLE OF 48°43'02", A DISTANCE OF 72.27 FT. TO THE P.C.C. OF A CURVE CONCAVE TO THE SOUTHWEST, HAVING A RADIUS OF 246.00 FT.; THENCE RUN NORTHWESTERLY, ALONG THE ARC OF SAID CURVE, THROUGH A CENTAL ANGLE OF 81°57'42", A DISTANCE OF 351.90 FT. TO THE P.T. OF SAID CURVE; THENCE S62°15'30"W, A DISTANCE OF 145.63 FT. TO THE P.C. OF A CURVE, CONCAVE TO THE NORTH, HAVING A RADIUS OF 230.00 FT.; THENCE RUN WESTERLY ALONG THE ARC OF SAID CURVE, THROUGH A CENTRAL ANGLE OF 69°09'51", A DISTANCE OF 277.64 FT. TO THE P.C.C. OF A CURVE CONCAVE TO THE NORTHEAST, HAVING A RADIUS OF 62.00 FT.; THENCE RUN NORTHWESTERLY, ALONG THE ARC OF SAID CURVE, THROUGH A CENTAL ANGLE OF 43°18'07", A DISTANCE OF 46.86 FT. TO THE P.T. OF SAID CURVE; THENCE N05°16'32"W, 54.61 FT.; THENCE N55°33'25"W, 71.58 FT.; THENCE S64°43'44"W, A DISTANCE OF 267.76 FT. TO THE POINT OF BEGINNING, BEING AND LYING IN SECTION 16, TOWNSHIP 35 SOUTH, RANGE 19 EAST, MANATEE COUNTY, FLORIDA.

CONTAINING 150.78 ACRES MORE OR LESS.

LESS any rights of way dedicated to Manatee County for Lakewood Ranch Boulevard, Pope Road, Malachite Drive, Rangeland Parkway (f/k/a Center Ice) and 44th Avenue East.

LAND USE SCHEDULE

USE	ACRES	SQ.FT.	UNITS
Residential			
Single Family (detached, townhomes and villas)			3,833
Multifamily			689
Total Residential	991.3		4,522
Commercial/Office	43.0	305,000	
Recreation	9.2		18 Holes
Golf Course			
Right-of-Way	39.9		
Wetlands	129.3		
Lakes	51.5		
Stormwater Ponds	91.7		
Open Space	109.4		
Upland Preservation	53.6		
Total	1,518.9	305,000	4,522

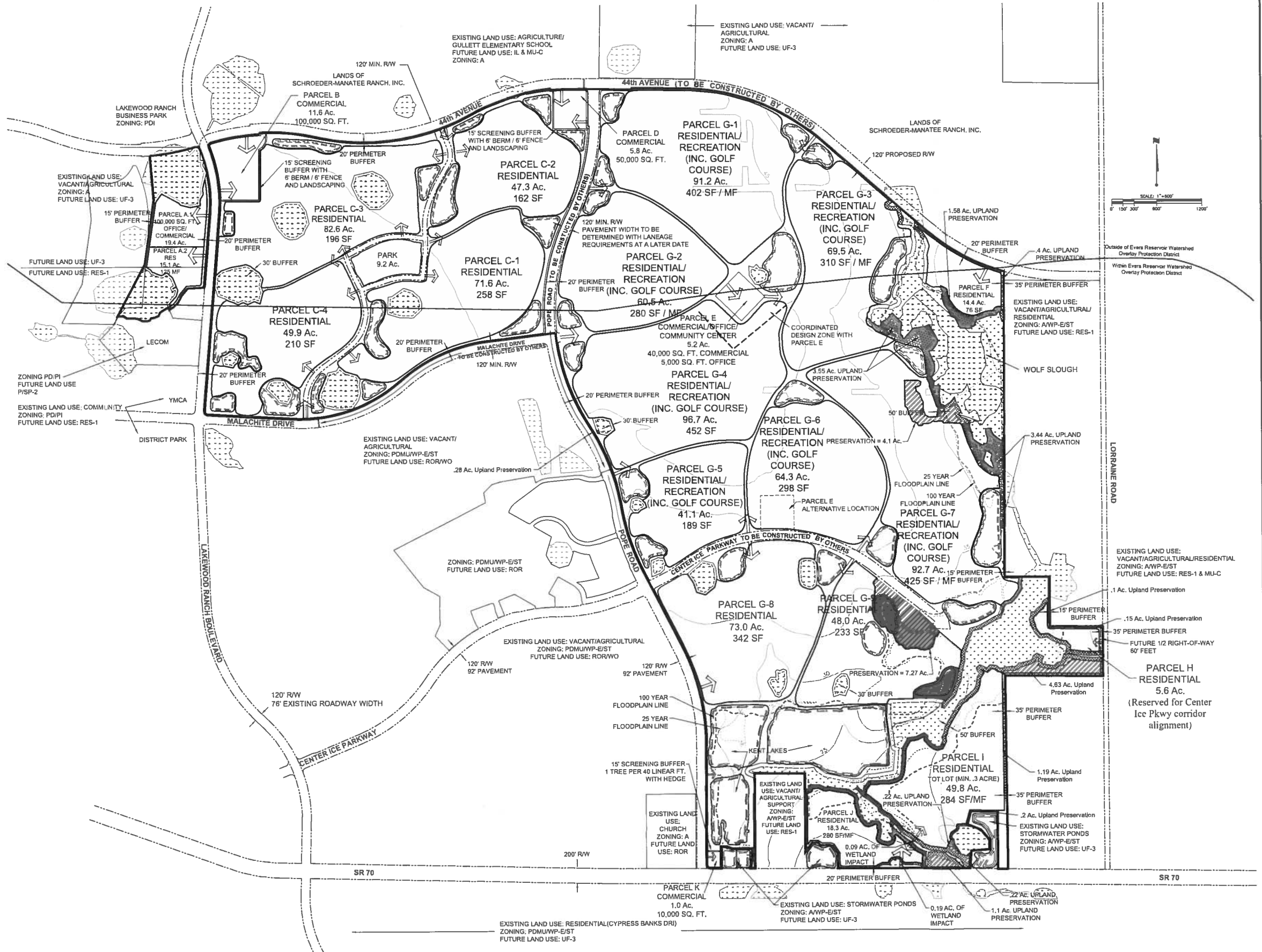

LEGEND

- Forested Wetlands
- Herbaceous Wetlands
- Wetland Impact
- Lakes
- Access Arrows
- Topographic Contours
- 25 Year Floodplain Line
- 100 Year Floodplain Line
- Pine Flatwoods Upland Preservation (within wetland buffers)
- Pine-Mesic Oak Upland Preservation (within wetland buffers)
- Pine Flatwoods Upland Preservation Area
- Pine-Mesic Oak Upland Preservation Area

5	REVISE PER CLIENT	05/02/13	RTD/89450		ACTIVITY	INITIALS/EMP. NO.	DATE
4	REVISE PER CLIENT (ADD MF CALLOUT TO G-1 G-2 G-3 AND G-7)	07/18/12	RTD/89450		DESIGNED BY:		
3	REVISE PER CLIENT	05/10/12	RTD/89450		DRAWN BY:	CVO/1995	
2	REVISE PER COMMENTS	10/04/11	RTD/89450		CHECKED BY:		
1	CHANGES PER MC STAFF	7/19/08	RP/2382		CONTRACT ADMIN. BY:		
REV. NO.	REVISION	DATE	DRAWN BY / EMP. NO.	CHECKED BY / EMP. NO.	WM APPROVED BY:		

Wilson Miller
 Planners Engineers Ecologists Surveyors Landscape Architects Transportation Consultants
 Wilson Miller, Inc.
 Naples, Fort Myers, Sarasota, Bradenton, Tampa, Tallahassee
 8700 Channel Drive, Suite 400, Tampa, Florida 33626 Phone 813-223-4200 Fax 813-223-4209 Web Site www.wilsonmiller.com

CLIENT:	SMR NORTH 70, LLC	DATE:	JULY 2005	TITLE:	GENERAL DEVELOPMENT PLAN
PROJECT:	NORTHWEST SECTOR DRI	HORIZONTAL SCALE:	1"=500'	INDEX NUMBER:	04333-001-000
		VERTICAL SCALE:	N/A	SHEET NUMBER:	2 of 2
		SEC. TRP. REG.		CROSS REFERENCE FILE NO.:	
				PROJECT NUMBER:	

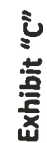
[illegible][illegible]

<p>Wisniewski</p> <p>James Wisniewski, President Robert Wisniewski, Vice President Thomas Wisniewski, Secretary Michael Wisniewski, Treasurer John Wisniewski, Chairman</p>	<p>CONCEPTUAL TRAILS MASTER PLAN</p> <p>1/2" = 1' - 0"</p> <p>1/4" = 1' - 0"</p> <p>1/8" = 1' - 0"</p> <p>1/16" = 1' - 0"</p> <p>1/32" = 1' - 0"</p> <p>1/64" = 1' - 0"</p> <p>1/128" = 1' - 0"</p> <p>1/256" = 1' - 0"</p> <p>1/512" = 1' - 0"</p> <p>1/1024" = 1' - 0"</p> <p>1/2048" = 1' - 0"</p> <p>1/4096" = 1' - 0"</p> <p>1/8192" = 1' - 0"</p> <p>1/16384" = 1' - 0"</p> <p>1/32768" = 1' - 0"</p> <p>1/65536" = 1' - 0"</p> <p>1/131072" = 1' - 0"</p> <p>1/262144" = 1' - 0"</p> <p>1/524288" = 1' - 0"</p> <p>1/1048576" = 1' - 0"</p> <p>1/2097152" = 1' - 0"</p> <p>1/4194304" = 1' - 0"</p> <p>1/8388608" = 1' - 0"</p> <p>1/16777216" = 1' - 0"</p> <p>1/33554432" = 1' - 0"</p> <p>1/67108864" = 1' - 0"</p> <p>1/134217728" = 1' - 0"</p> <p>1/268435456" = 1' - 0"</p> <p>1/536870912" = 1' - 0"</p> <p>1/1073741824" = 1' - 0"</p> <p>1/2147483648" = 1' - 0"</p> <p>1/4294967296" = 1' - 0"</p> <p>1/8589934592" = 1' - 0"</p> <p>1/17179869184" = 1' - 0"</p> <p>1/34359738368" = 1' - 0"</p> <p>1/68719476736" = 1' - 0"</p> <p>1/137438953472" = 1' - 0"</p> <p>1/274877906944" = 1' - 0"</p> <p>1/549755813888" = 1' - 0"</p> <p>1/1099511627776" = 1' - 0"</p> <p>1/2199023255552" = 1' - 0"</p> <p>1/4398046511104" = 1' - 0"</p> <p>1/8796093022208" = 1' - 0"</p> <p>1/17592186044416" = 1' - 0"</p> <p>1/35184372088832" = 1' - 0"</p> <p>1/70368744177664" = 1' - 0"</p> <p>1/140737488355328" = 1' - 0"</p> <p>1/281474976710656" = 1' - 0"</p> <p>1/562949953421312" = 1' - 0"</p> <p>1/1125899906842624" = 1' - 0"</p> <p>1/2251799813685248" = 1' - 0"</p> <p>1/4503599627370496" = 1' - 0"</p> <p>1/9007199254740992" = 1' - 0"</p> <p>1/18014398509481984" = 1' - 0"</p> <p>1/36028797018963968" = 1' - 0"</p> <p>1/72057594037927936" = 1' - 0"</p> <p>1/144115188075855872" = 1' - 0"</p> <p>1/288230376151711744" = 1' - 0"</p> <p>1/576460752303423488" = 1' - 0"</p> <p>1/1152921504606846976" = 1' - 0"</p> <p>1/2305843009213693952" = 1' - 0"</p> <p>1/4611686018427387904" = 1' - 0"</p> <p>1/9223372036854775808" = 1' - 0"</p> <p>1/18446744073709551616" = 1' - 0"</p> <p>1/36893488147419103232" = 1' - 0"</p> <p>1/73786976294838206464" = 1' - 0"</p> <p>1/147573952589676412928" = 1' - 0"</p> <p>1/295147905179352825856" = 1' - 0"</p> <p>1/590295810358705651712" = 1' - 0"</p> <p>1/1180591620717411303424" = 1' - 0"</p> <p>1/2361183241434822606848" = 1' - 0"</p> <p>1/4722366482869645213696" = 1' - 0"</p> <p>1/9444732965739290427392" = 1' - 0"</p> <p>1/18889465931478580854784" = 1' - 0"</p> <p>1/37778931862957161709568" = 1' - 0"</p> <p>1/75557863725914323419136" = 1' - 0"</p> <p>1/151115727451828646838272" = 1' - 0"</p> <p>1/302231454903657293676544" = 1' - 0"</p> <p>1/604462909807314587353088" = 1' - 0"</p> <p>1/1208925819614629174706176" = 1' - 0"</p> <p>1/2417851639229258349412352" = 1' - 0"</p> <p>1/4835703278458516698824704" = 1' - 0"</p> <p>1/9671406556917033397649408" = 1' - 0"</p> <p>1/19342813113834066795298816" = 1' - 0"</p> <p>1/38685626227668133590597632" = 1' - 0"</p> <p>1/77371252455336267181195264" = 1' - 0"</p> <p>1/154742504910672534362390528" = 1' - 0"</p> <p>1/309485009821345068724781056" = 1' - 0"</p> <p>1/618970019642690137449562112" = 1' - 0"</p> <p>1/1237940039285380274899124224" = 1' - 0"</p> <p>1/2475880078570760549798248448" = 1' - 0"</p> <p>1/4951760157141521099596496896" = 1' - 0"</p> <p>1/9903520314283042199192993792" = 1' - 0"</p> <p>1/19807040628566084398385987584" = 1' - 0"</p> <p>1/39614081257132168796771975168" = 1' - 0"</p> <p>1/79228162514264337593543950336" = 1' - 0"</p> <p>1/158456325028528675187087900672" = 1' - 0"</p> <p>1/316912650057057350374175801344" = 1' - 0"</p> <p>1/633825300114114700748351602688" = 1' - 0"</p> <p>1/1267650600228229401496703205376" = 1' - 0"</p> <p>1/2535301200456458802993406410752" = 1' - 0"</p> <p>1/5070602400912917605986812821504" = 1' - 0"</p> <p>1/10141204801825835211973625643008" = 1' - 0"</p> <p>1/20282409603651670423947251286016" = 1' - 0"</p> <p>1/40564819207303340847894502572032" = 1' - 0"</p> <p>1/81129638414606681695789005144064" = 1' - 0"</p> <p>1/162259276829213363391578010288128" = 1' - 0"</p> <p>1/324518553658426726783156020576256" = 1' - 0"</p> <p>1/649037107316853453566312041152512" = 1' - 0"</p> <p>1/1298074214633706907132624082305024" = 1' - 0"</p> <p>1/2596148429267413814265248164610048" = 1' - 0"</p> <p>1/5192296858534827628530496329220096" = 1' - 0"</p> <p>1/10384593717069655257060992658440192" = 1' - 0"</p> <p>1/20769187434139310514121985316880384" = 1' - 0"</p> <p>1/41538374868278621028243970633760768" = 1' - 0"</p> <p>1/83076749736557242056487941267521536" = 1' - 0"</p> <p>1/166153499473114484112975882</p>
--	---



STATE OF FLORIDA, COUNTY OF MANATEE
This is to certify that the foregoing is a true and
correct copy of the documents on file in my office.

Witness my hand and official seal this 12th day of

August 2013
R.B. SHORE
Clerk of Circuit Court

BU: 98-000000 D.C.



FLORIDA DEPARTMENT *of* STATE

RICK SCOTT
Governor

KEN DETZNER
Secretary of State

August 14, 2013

RECEIVED

AUG 19 2013

BOARD RECORDS

Honorable R. B. "Chips" Shore
Clerk of the Circuit Court
Manatee County
Post Office Box 25400
Bradenton, Florida 34206

Attention: Robin Liberty, Deputy Clerk

Dear Mr. Shore:

Pursuant to the provisions of Section 125.66, Florida Statutes, this will acknowledge receipt of your letter dated August 13, 2013 and certified copies of Manatee County Ordinance Nos. ~~PDR-05-19(G)(R7)~~ and 13-24, which were filed in this office on August 14, 2013. PDMU-05-19(G)(R7)

As requested, a date stamped copy of the ordinance is being returned for your records.

Sincerely,

Liz Cloud
Program Administrator

LC/elr

Enclosure